



RACCORDERIA FITTINGS RACORES

La raccorderia ARAG è realizzata con materiali di prima qualità:

- Raccordi con attacco a forchetta in Nylon®, con un'ottima resistenza meccanica ed una buona resistenza agli agenti chimici.
 - Raccordi standard, in Polipropilene, caratterizzati da una buona resistenza meccanica ed un'ottima resistenza agli agenti chimici. A richiesta disponibili anche in Nylon®.
- Filettature standard BSP (GAS) oppure a richiesta NPT.
A richiesta e per quantitativi, la raccorderia può essere eseguita in materiali diversi e con diversi standard di filettatura.

ARAG fittings are made of premium quality materials and include:

- Fittings with fork coupling in Nylon®, featuring optimum mechanical resistance and good resistance to chemical agents.
 - Polypropylene standard fittings, featuring good mechanical resistance and optimum resistance to chemical agents. Available also in Nylon® upon request.
- Standard BSP (GAS) or, upon request, NPT threads.
Upon request and for big quantities, fittings can be manufactured in different materials and with different threading standards.

Los racores ARAG están realizados con materiales de primera calidad:

- Racores de Nylon® con conexión de horquilla, con una óptima resistencia mecánica y una buena resistencia a los agentes químicos.
 - Racores estándar de Polipropileno, caracterizados por una buena resistencia mecánica y una óptima resistencia a los agentes químicos. Bajo pedido disponibles también de Nylon®.
- Roscas estándar BSP (GAS) o bajo pedido NPT.
Bajo pedido en cantidades, los racores pueden fabricarse en distintos materiales y tipo de rosca.



I raccordi vengono riconosciuti dalla sigla T e da un numero che indica il diametro del passaggio, come indicato nella tabella.
Forchetta e O-ring da ordinare separatamente.

These fittings are indicated with the symbol "T" and a number indicating the passage diameter, as explained in the chart.
Fork and O-ring to be ordered separately.

Los racores son reconocidos por la sigla T y por un número que indica el diámetro del pasaje, según lo indicado en la tabla.
Horquilla y O-ring a pedir por separado.









| Tipo Type Tipo | Passaggio Passage Pasaje |  | |
|----------------------|--------------------------------|---|-----|
| | | bar | PSI |
| T1 | 3/8" | 20 | 290 |
| T2 | 1/2" | | |
| T3 | 3/4" | | |
| T4 | 1" | | |

| Tipo Type Tipo | Passaggio Passage Pasaje |  | |
|----------------------|--------------------------------|---|-----|
| | | bar | PSI |
| T5 | 1 1/4" | 15 | 220 |
| T6 | 1 1/2" | 12 | 180 |
| T7 | 2" | 8 | 120 |
| T9 | 3" | 5 | 70 |

COME ORDINARE

HOW TO ORDER

COMO PEDIR

- Specificare i codici  +  +  Es. raccordo **105315** + guarnizione **G40013** + girello **2002030**
Specify codes  +  +  Ex. fitting **105315** + gasket **G40013** + fly nut **2002030**
Specificar los códigos  +  +  Ej. racor **105315** + junta **G40013** + tuerca para racor **2002030**

Legenda dei simboli - Symbols - Leyenda símbolos



Raccordo con attacco a forchetta
Fitting with fork coupling
Racor con conexión de horquilla



Codice forchetta da ordinare a parte
Fork code to be ordered separately
Codigo de horquilla a pedir por separado



Codice O-ring da ordinare a parte
O-ring code to be ordered separately
Codigo de O-ring a pedir por separado



Pressione di esercizio
Operating pressure
Presión de trabajo



Nuovi prodotti
New items
Nuevos productos



Codice guarnizione da ordinare a parte
Gasket code to be ordered separately
Codigo de junta a pedir por separado



Unità minima (o suoi multipli) ordinabile
Minimum unit for orders (or its multiples)
Unidad mínima de pedido (o sus múltiplos)



Nuovi prodotti
New items
Nuevos productos



Prodotto in Nylon®
Made of Nylon®
Producto en Nylon®

RACCORDI CON ATTACCO A FORCHETTA

FITTINGS WITH FORK COUPLING

RACORES CON CONEXION DE HORQUILLA

Portagomma dritto attacco femmina
Straight hose fitting with female connection
Portamanguera recto con conexión hembra

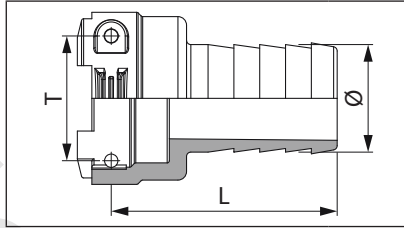

Portagomma dritto attacco maschio
Straight hose fitting with male connection
Portamanguera recto con conexión macho

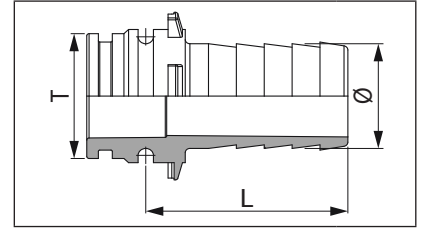

| COD. CODE CÔD. | T | Ø mm | L mm | Mat. Mat. Mat. | | COD. CODE CÔD. |
|----------------|----|------|------|----------------|----|----------------|
| 1090113 | T1 | 13 | 44 | PA | 25 | 010001 |
| 1090116 | T1 | 16 | 44 | PA | 25 | 010001 |
| 1090310 | T3 | 10 | 48 | PA | 25 | 010003 |
| 1090313 | T3 | 13 | 48 | PA | 25 | 010003 |
| 1090316 | T3 | 16 | 48 | PA | 25 | 010003 |
| 1090320 | T3 | 20 | 53 | PA | 25 | 010003 |
| 1090325 | T3 | 25 | 53 | PA | 25 | 010003 |
| 1090413 | T4 | 13 | 49 | PA | 25 | 010004 |
| 1090416 | T4 | 16 | 49 | PA | 25 | 010004 |
| 1090420 | T4 | 20 | 54 | PA | 25 | 010004 |
| 1090425 | T4 | 25 | 54 | PA | 25 | 010004 |
| 1090430 | T4 | 30 | 59 | PA | 25 | 010004 |
| 1090432 | T4 | 32 | 59 | PA | 25 | 010004 |
| 1090438 | T4 | 38 | 67 | PA | 25 | 010004 |
| 1090513 | T5 | 13 | 51 | PA | 10 | 010005 |
| 1090516 | T5 | 16 | 51 | PA | 10 | 010005 |
| 1090520 | T5 | 20 | 56 | PA | 10 | 010005 |
| 1090525 | T5 | 25 | 56 | PA | 10 | 010005 |
| 1090530 | T5 | 30 | 61 | PA | 10 | 010005 |
| 1090532 | T5 | 32 | 61 | PA | 10 | 010005 |
| 1090535 | T5 | 35 | 63 | PA | 10 | 010005 |
| 1090538 | T5 | 38 | 69 | PA | 10 | 010005 |
| 1090540 | T5 | 40 | 69 | PA | 10 | 010005 |
| 1090625 | T6 | 25 | 60 | PA | 10 | 010006 |
| 1090630 | T6 | 30 | 65 | PA | 10 | 010006 |
| 1090632 | T6 | 32 | 65 | PA | 10 | 010006 |
| 1090635 | T6 | 35 | 67 | PA | 10 | 010006 |
| 1090638 | T6 | 38 | 73 | PA | 10 | 010006 |
| 1090640 | T6 | 40 | 73 | PA | 10 | 010006 |
| 1090650 | T6 | 50 | 81 | PA | 10 | 010006 |
| 1090652 | T6 | 52 | 81 | PA | 10 | 010006 |
| 1090738 | T7 | 38 | 77 | PA | 10 | 010007 |
| 1090740 | T7 | 40 | 77 | PA | 10 | 010007 |
| 1090745 | T7 | 45 | 79 | PA | 10 | 010007 |
| 1090750 | T7 | 50 | 84 | PA | 10 | 010007 |
| 1090752 | T7 | 52 | 84 | PA | 10 | 010007 |
| 1090760 | T7 | 60 | 99 | PA | 10 | 010007 |
| 1090960 | T9 | 60 | 103 | PA | 5 | 010009 |
| 1090975 | T9 | 75 | 113 | PA | 5 | 010009 |

NYLON®



| COD. CODE CÔD. | T | Ø mm | L mm | Mat. Mat. Mat. | | COD. EPDM | COD. VITON |
|----------------|----|------|------|----------------|----|-----------|------------|
| 1091108 | T1 | 8 | 31 | PA | 25 | G11056 | G11056V |
| 109110A | T1 | 10 | 36 | PA | 25 | G11056 | G11056V |
| 1091113 | T1 | 13 | 36 | PA | 25 | G11056 | G11056V |
| 1091310 | T3 | 10 | 39 | PA | 25 | G11058 | G11058V |
| 1091313 | T3 | 13 | 39 | PA | 25 | G11058 | G11058V |
| 1091316 | T3 | 16 | 39 | PA | 25 | G11058 | G11058V |
| 1091320 | T3 | 20 | 44 | PA | 25 | G11058 | G11058V |
| 1091325 | T3 | 25 | 44 | PA | 25 | G11058 | G11058V |
| 1091330 | T3 | 30 | 49 | PA | 25 | G11058 | G11058V |
| 1091413 | T4 | 13 | 39 | PA | 25 | G11054 | G11054V |
| 1091416 | T4 | 16 | 39 | PA | 25 | G11054 | G11054V |
| 1091420 | T4 | 20 | 44 | PA | 25 | G11054 | G11054V |
| 1091425 | T4 | 25 | 44 | PA | 25 | G11054 | G11054V |
| 1091430 | T4 | 30 | 49 | PA | 25 | G11054 | G11054V |
| 1091432 | T4 | 32 | 49 | PA | 25 | G11054 | G11054V |
| 1091438 | T4 | 38 | 57 | PA | 25 | G11054 | G11054V |
| 1091513 | T5 | 13 | 40 | PA | 10 | G11063 | G11063V |
| 1091516 | T5 | 16 | 40 | PA | 10 | G11063 | G11063V |
| 1091520 | T5 | 20 | 45 | PA | 10 | G11063 | G11063V |
| 1091525 | T5 | 25 | 45 | PA | 10 | G11063 | G11063V |
| 1091530 | T5 | 30 | 50 | PA | 10 | G11063 | G11063V |
| 1091532 | T5 | 32 | 50 | PA | 10 | G11063 | G11063V |
| 1091535 | T5 | 35 | 52 | PA | 10 | G11063 | G11063V |
| 1091538 | T5 | 38 | 58 | PA | 10 | G11063 | G11063V |
| 1091540 | T5 | 40 | 58 | PA | 10 | G11063 | G11063V |
| 1091625 | T6 | 25 | 48 | PA | 10 | G11023 | G11023V |
| 1091630 | T6 | 30 | 53 | PA | 10 | G11023 | G11023V |
| 1091632 | T6 | 32 | 53 | PA | 10 | G11023 | G11023V |
| 1091635 | T6 | 35 | 55 | PA | 10 | G11023 | G11023V |
| 1091638 | T6 | 38 | 61 | PA | 10 | G11023 | G11023V |
| 1091640 | T6 | 40 | 61 | PA | 10 | G11023 | G11023V |
| 1091650 | T6 | 50 | 68 | PA | 10 | G11023 | G11023V |
| 1091652 | T6 | 52 | 68 | PA | 10 | G11023 | G11023V |
| 1091738 | T7 | 38 | 62 | PA | 10 | G11017 x2 | G11017V x2 |
| 1091740 | T7 | 40 | 62 | PA | 10 | G11017 x2 | G11017V x2 |
| 1091745 | T7 | 45 | 64 | PA | 10 | G11017 x2 | G11017V x2 |
| 1091750 | T7 | 50 | 69 | PA | 10 | G11017 x2 | G11017V x2 |
| 1091752 | T7 | 52 | 69 | PA | 10 | G11017 x2 | G11017V x2 |
| 1091760 | T7 | 60 | 84 | PA | 10 | G11017 x2 | G11017V x2 |
| 1091960 | T9 | 60 | 86 | PA | 5 | G11067 x2 | G11067V x2 |
| 1091975 | T9 | 75 | 96 | PA | 5 | G11067 x2 | G11067V x2 |

NYLON®

RACCORDI CON ATTACCO A FORCHETTA FITTINGS WITH FORK COUPLING RACORES CON CONEXION DE HORQUILLA

Portagomma curvo attacco femmina
90° hose fitting with female connection
Portamanguera curvo con conexión hembra

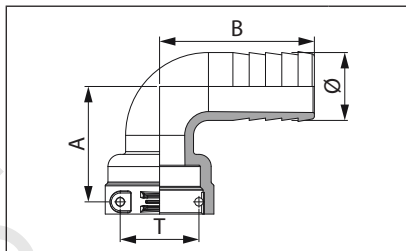

Portagomma curvo attacco maschio
90° hose fitting with male connection
Portamanguera curvo con conexión macho

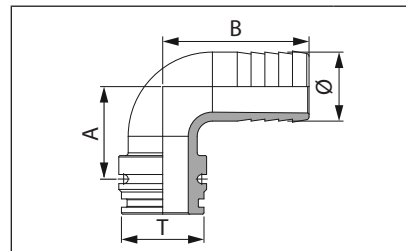

| COD. CODE Cód. | T | Ø mm | A mm | B mm | Mat. Mat. Mat. | | COD. CODE Cód. |
|----------------|----|------|------|------|----------------|----|----------------|
| 1190310 | T3 | 10 | 34 | 35 | PA | 25 | 010003 |
| 1190313 | T3 | 13 | 34 | 45 | PA | 25 | 010003 |
| 1190316 | T3 | 16 | 34 | 48 | PA | 25 | 010003 |
| 1190320 | T3 | 20 | 34 | 53 | PA | 25 | 010003 |
| 1190325 | T3 | 25 | 43 | 53 | PA | 25 | 010003 |
| 1190413 | T4 | 13 | 35 | 45 | PA | 25 | 010004 |
| 1190416 | T4 | 16 | 35 | 48 | PA | 25 | 010004 |
| 1190420 | T4 | 20 | 35 | 53 | PA | 25 | 010004 |
| 1190425 | T4 | 25 | 44 | 53 | PA | 25 | 010004 |
| 1190430 | T4 | 30 | 45 | 60 | PA | 25 | 010004 |
| 1190432 | T4 | 32 | 48 | 74 | PA | 25 | 010004 |
| 1190513 | T5 | 13 | 37 | 45 | PA | 10 | 010005 |
| 1190516 | T5 | 16 | 37 | 48 | PA | 10 | 010005 |
| 1190520 | T5 | 20 | 37 | 53 | PA | 10 | 010005 |
| 1190525 | T5 | 25 | 50 | 57 | PA | 10 | 010005 |
| 1190530 | T5 | 30 | 50 | 74 | PA | 10 | 010005 |
| 1190532 | T5 | 32 | 50 | 74 | PA | 10 | 010005 |
| 1190535 | T5 | 35 | 55 | 80 | PA | 10 | 010005 |
| 1190538 | T5 | 38 | 55 | 85 | PA | 10 | 010005 |
| 1190540 | T5 | 40 | 55 | 85 | PA | 10 | 010005 |
| 1190625 | T6 | 25 | 55 | 57 | PA | 10 | 010006 |
| 1190630 | T6 | 30 | 54 | 74 | PA | 10 | 010006 |
| 1190632 | T6 | 32 | 54 | 74 | PA | 10 | 010006 |
| 1190635 | T6 | 35 | 59 | 80 | PA | 10 | 010006 |
| 1190638 | T6 | 38 | 59 | 85 | PA | 10 | 010006 |
| 1190640 | T6 | 40 | 59 | 85 | PA | 10 | 010006 |
| 1190650 | T6 | 50 | 71 | 92 | PA | 10 | 010006 |
| 1190740 | T7 | 40 | 63 | 85 | PA | 10 | 010007 |
| 1190745 | T7 | 45 | 69 | 83 | PA | 10 | 010007 |
| 1190750 | T7 | 50 | 74 | 92 | PA | 10 | 010007 |
| 1190752 | T7 | 52 | 74 | 92 | PA | 10 | 010007 |
| 1190760 | T7 | 60 | 99 | 120 | PA | 10 | 010007 |
| 1190960 | T9 | 60 | 102 | 120 | PA | 5 | 010009 |
| 1190975 | T9 | 75 | 102 | 125 | PA | 5 | 010009 |

NYLON®



| COD. CODE Cód. | T | Ø mm | A mm | B mm | Mat. Mat. Mat. | | COD. EPDM | COD. VITON |
|----------------|----|------|------|------|----------------|----|-----------|------------|
| 1191310 | T3 | 10 | 25 | 35 | PA | 25 | G11058 | G11058V |
| 1191313 | T3 | 13 | 25 | 45 | PA | 25 | G11058 | G11058V |
| 1191316 | T3 | 16 | 25 | 48 | PA | 25 | G11058 | G11058V |
| 1191320 | T3 | 20 | 25 | 53 | PA | 25 | G11058 | G11058V |
| 1191325 | T3 | 25 | 38 | 57 | PA | 25 | G11058 | G11058V |
| 1191413 | T4 | 13 | 25 | 45 | PA | 25 | G11054 | G11054V |
| 1191416 | T4 | 16 | 25 | 48 | PA | 25 | G11054 | G11054V |
| 1191420 | T4 | 20 | 25 | 53 | PA | 25 | G11054 | G11054V |
| 1191425 | T4 | 25 | 38 | 57 | PA | 25 | G11054 | G11054V |
| 1191430 | T4 | 30 | 38 | 74 | PA | 25 | G11054 | G11054V |
| 1191432 | T4 | 32 | 38 | 74 | PA | 25 | G11054 | G11054V |
| 1191513 | T5 | 13 | 26 | 45 | PA | 10 | G11063 | G11063V |
| 1191516 | T5 | 16 | 26 | 48 | PA | 10 | G11063 | G11063V |
| 1191520 | T5 | 20 | 26 | 53 | PA | 10 | G11063 | G11063V |
| 1191525 | T5 | 25 | 39 | 57 | PA | 10 | G11063 | G11063V |
| 1191530 | T5 | 30 | 39 | 74 | PA | 10 | G11063 | G11063V |
| 1191532 | T5 | 32 | 39 | 74 | PA | 10 | G11063 | G11063V |
| 1191535 | T5 | 35 | 44 | 80 | PA | 10 | G11063 | G11063V |
| 1191538 | T5 | 38 | 44 | 85 | PA | 10 | G11063 | G11063V |
| 1191540 | T5 | 40 | 44 | 85 | PA | 10 | G11063 | G11063V |
| 1191625 | T6 | 25 | 42 | 57 | PA | 10 | G11023 | G11023V |
| 1191630 | T6 | 30 | 42 | 74 | PA | 10 | G11023 | G11023V |
| 1191632 | T6 | 32 | 42 | 74 | PA | 10 | G11023 | G11023V |
| 1191635 | T6 | 35 | 47 | 80 | PA | 10 | G11023 | G11023V |
| 1191638 | T6 | 38 | 47 | 85 | PA | 10 | G11023 | G11023V |
| 1191640 | T6 | 40 | 47 | 85 | PA | 10 | G11023 | G11023V |
| 1191740 | T7 | 40 | 48 | 85 | PA | 10 | G11017 x2 | G11017V x2 |
| 1191745 | T7 | 45 | 48 | 85 | PA | 10 | G11017 x2 | G11017V x2 |
| 1191750 | T7 | 50 | 59 | 92 | PA | 10 | G11017 x2 | G11017V x2 |
| 1191752 | T7 | 52 | 59 | 92 | PA | 10 | G11017 x2 | G11017V x2 |
| 1191760 | T7 | 60 | 79 | 115 | PA | 10 | G11017 x2 | G11017V x2 |
| 1191960 | T9 | 60 | 84 | 120 | PA | 5 | G11067 x2 | G11067V x2 |
| 1191975 | T9 | 75 | 84 | 125 | PA | 5 | G11067 x2 | G11067V x2 |

NYLON®

RACCORDI CON ATTACCO A FORCHETTA FITTINGS WITH FORK COUPLING RACORES CON CONEXION DE HORQUILLA

Portagomma curvo 45° attacco femmina
45° hose fitting with female connection
Portamanguera curvo 45° conexión hembra

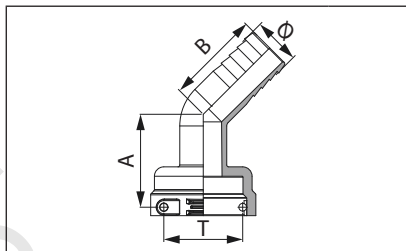

| COD. CODE CÓD. | T | Ø mm | A mm | B mm | Mat. Mat. Mat. | | COD. CODE CÓD. |
|----------------------|----|---------|---------|---------|----------------------|----|----------------------|
| 1192313 | T3 | 13 | 38 | 38 | PA | 25 | 010003 |
| 1192320 | T3 | 20 | 38 | 38 | PA | 25 | 010003 |
| 1192420 | T4 | 20 | 39 | 39 | PA | 25 | 010004 |
| 1192425 | T4 | 25 | 47 | 47 | PA | 25 | 010004 |
| 1192430 | T4 | 30 | 47 | 55 | PA | 25 | 010004 |
| 1192525 | T5 | 25 | 50 | 50 | PA | 10 | 010005 |
| 1192530 | T5 | 30 | 50 | 55 | PA | 10 | 010005 |
| 1192532 | T5 | 32 | 50 | 55 | PA | 10 | 010005 |
| 1192535 | T5 | 35 | 50 | 55 | PA | 10 | 010005 |
| 1192630 | T6 | 30 | 54 | 55 | PA | 10 | 010006 |
| 1192632 | T6 | 32 | 54 | 55 | PA | 10 | 010006 |
| 1192635 | T6 | 35 | 54 | 55 | PA | 10 | 010006 |
| 1192638 | T6 | 38 | 54 | 60 | PA | 10 | 010006 |
| 1192640 | T6 | 40 | 54 | 60 | PA | 10 | 010006 |
| 1192650 | T6 | 50 | 54 | 68 | PA | 10 | 010006 |
| 1192740 | T7 | 40 | 53 | 64 | PA | 5 | 010007 |
| 1192750 | T7 | 50 | 53 | 70 | PA | 5 | 010007 |
| 1192752 | T7 | 52 | 53 | 70 | PA | 5 | 010007 |
| 1192760 | T7 | 60 | 53 | 82 | PA | 5 | 010007 |
| 1192960 | T9 | 60 | 64 | 82 | PA | 5 | 010009 |
| 1192975 | T9 | 75 | 64 | 99 | PA | 5 | 010009 |

NYLON®

Portagomma curvo 45° attacco maschio
45° hose fitting with male connection
Portamanguera curvo 45° conexión macho

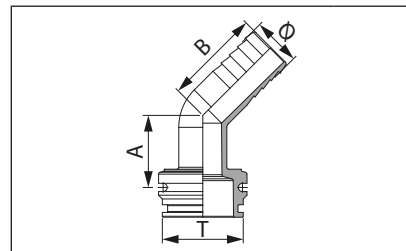

| COD. CODE CÓD. | T | Ø mm | A mm | B mm | Mat. Mat. Mat. | | COD. EPDM | COD. VITON |
|----------------------|----|---------|---------|---------|----------------------|----|--------------|---------------|
| 1193313 | T3 | 13 | 29 | 35 | PA | 25 | G11058 | G11058V |
| 1193320 | T3 | 20 | 29 | 45 | PA | 25 | G11058 | G11058V |
| 1193325 | T3 | 25 | 37 | 50 | PA | 25 | G11058 | G11058V |
| 1193420 | T4 | 20 | 29 | 45 | PA | 25 | G11054 | G11054V |
| 1193425 | T4 | 25 | 37 | 50 | PA | 25 | G11054 | G11054V |
| 1193430 | T4 | 30 | 37 | 55 | PA | 25 | G11054 | G11054V |
| 1193525 | T5 | 25 | 38 | 50 | PA | 10 | G11063 | G11063V |
| 1193530 | T5 | 30 | 38 | 55 | PA | 10 | G11063 | G11063V |
| 1193532 | T5 | 32 | 38 | 55 | PA | 10 | G11063 | G11063V |
| 1193535 | T5 | 35 | 38 | 55 | PA | 10 | G11063 | G11063V |
| 1193630 | T6 | 30 | 41 | 55 | PA | 10 | G11023 | G11023V |
| 1193632 | T6 | 32 | 41 | 55 | PA | 10 | G11023 | G11023V |
| 1193635 | T6 | 35 | 41 | 55 | PA | 10 | G11023 | G11023V |
| 1193638 | T6 | 38 | 41 | 60 | PA | 10 | G11023 | G11023V |
| 1193640 | T6 | 40 | 41 | 60 | PA | 10 | G11023 | G11023V |
| 1193740 | T7 | 40 | 37 | 64 | PA | 5 | G11017 x2 | G11017V x2 |
| 1193750 | T7 | 50 | 37 | 70 | PA | 5 | G11017 x2 | G11017V x2 |
| 1193752 | T7 | 52 | 37 | 70 | PA | 5 | G11017 x2 | G11017V x2 |
| 1193760 | T7 | 60 | 37 | 82 | PA | 5 | G11017 x2 | G11017V x2 |
| 1193960 | T9 | 60 | 45 | 82 | PA | 5 | G11067 x2 | G11067V x2 |
| 1193975 | T9 | 75 | 45 | 99 | PA | 5 | G11067 x2 | G11067V x2 |

NYLON®

RACCORDI CON ATTACCO A FORCHETTA FITTINGS WITH FORK COUPLING RACORES CON CONEXION DE HORQUILLA

Raccordo filettato maschio attacco femmina
Male threaded with female connection
Racor roscado macho con conexión hembra

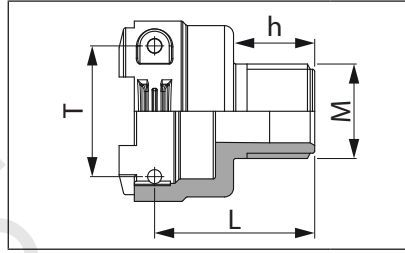

| COD. CODE Cód. | T | M | h mm | L mm | Mat. Mat. Mat. | | COD. CODE Cód. |
|----------------|----|----------|------|------|----------------|----|----------------|
| 249032 | T3 | G 1/2" | 18 | 36 | PA | 25 | 010003 |
| 249033 | T3 | G 3/4" | 22 | 40 | PA | 25 | 010003 |
| 249042 | T4 | G 1/2" | 18 | 37 | PA | 25 | 010004 |
| 249044 | T4 | G 1" | 22 | 41 | PA | 25 | 010004 |
| 249055 | T5 | G 1 1/4" | 24 | 46 | PA | 10 | 010005 |
| 249056 | T5 | G 1 1/2" | 24 | 47 | PA | 10 | 010005 |
| 249064 | T6 | G 1" | 22 | 46 | PA | 10 | 010006 |
| 249065 | T6 | G 1 1/4" | 24 | 48 | PA | 10 | 010006 |
| 249066 | T6 | G 1 1/2" | 24 | 49 | PA | 10 | 010006 |
| 249067 | T6 | G 2" | 27 | 47 | PA | 10 | 010006 |
| 249074 | T7 | G 1" | 22 | 51 | PA | 10 | 010007 |
| 249075 | T7 | G 1 1/4" | 24 | 53 | PA | 10 | 010007 |
| 249076 | T7 | G 1 1/2" | 24 | 53 | PA | 10 | 010007 |
| 249077 | T7 | G 2" | 27 | 59 | PA | 10 | 010007 |
| 249099 | T9 | G 3" | 35 | 73 | PA | 5 | 010009 |

NYLON®

Raccordo filettato maschio attacco maschio
Male threaded with male connection
Racor roscado macho con conexión macho

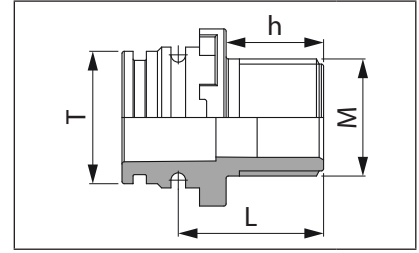

| COD. CODE Cód. | T | M | h mm | L mm | Mat. Mat. Mat. | | COD. EPDM | COD. VITON |
|----------------|----|----------|------|------|----------------|----|-----------|------------|
| 249112 | T1 | G 1/2" | 13 | 21 | PA | 25 | G11056 | G11056V |
| 249132 | T3 | G 1/2" | 18 | 27 | PA | 25 | G11058 | G11058V |
| 249133 | T3 | G 3/4" | 22 | 33 | PA | 25 | G11058 | G11058V |
| 249134 | T3 | G 1" | 22 | 36 | PA | 25 | G11058 | G11058V |
| 249144 | T4 | G 1" | 22 | 33 | PA | 25 | G11054 | G11054V |
| 249154 | T5 | G 1" | 22 | 32 | PA | 10 | G11063 | G11063V |
| 249155 | T5 | G 1 1/4" | 24 | 37 | PA | 10 | G11063 | G11063V |
| 249157 | T5 | G 2" | 27 | 40 | PA | 10 | G11063 | G11063V |
| 249166 | T6 | G 1 1/2" | 24 | 42 | PA | 10 | G11023 | G11023V |
| 249176 | T7 | G 1 1/2" | 24 | 38 | PA | 10 | G11017 x2 | G11017V x2 |
| 249177 | T7 | G 2" | 27 | 45 | PA | 10 | G11017 x2 | G11017V x2 |
| 249199 | T9 | G 3" | 35 | 54 | PA | 5 | G11067 x2 | G11067V x2 |

NYLON®

Raccordo passaparete filettato maschio attacco maschio
Bulkhead male threaded with male connection
Racor pasapared roscado macho con conexión macho

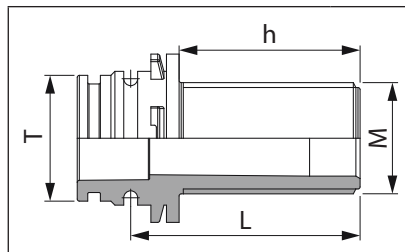

| COD. CODE Cód. | T | M | h mm | L mm | Mat. Mat. Mat. | | COD. EPDM | COD. VITON |
|----------------|----|----------|------|------|----------------|----|-----------|------------|
| 2491331 | T3 | G 3/4" | 43 | 55 | PA | 25 | G11058 | G11058V |
| 2491441 | T4 | G 1" | 50 | 62 | PA | 25 | G11054 | G11054V |
| 2491551 | T5 | G 1 1/4" | 55 | 68 | PA | 10 | G11063 | G11063V |
| 2491661 | T6 | G 1 1/2" | 50 | 68 | PA | 10 | G11023 | G11023V |
| 2491771 | T7 | G 2" | 50 | 68 | PA | 10 | G11017 x2 | G11017V x2 |

NYLON®

Manicotto Femmina / femmina
Female / female coupling
Manguito hembra / hembra

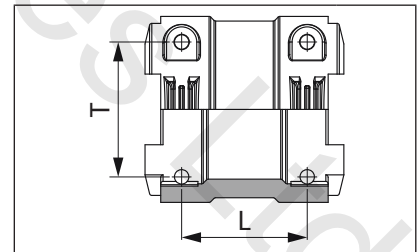

| COD. CODE Cód. | T | L mm | Mat. Mat. Mat. | | COD. CODE Cód. |
|----------------|----|------|----------------|----|----------------|
| 259011 | T1 | 21 | PA | 25 | 010001 |
| 259033 | T3 | 27 | PA | 25 | 010003 |
| 259044 | T4 | 30 | PA | 25 | 010004 |
| 259055 | T5 | 32 | PA | 10 | 010005 |
| 259066 | T6 | 41 | PA | 10 | 010006 |
| 259077 | T7 | 47 | PA | 10 | 010007 |
| 259099 | T9 | 54 | PA | 5 | 010009 |

NYLON®

RACCORDI CON ATTACCO A FORCHETTA FITTINGS WITH FORK COUPLING RACORES CON CONEXION DE HORQUILLA

Nipplo maschio / maschio
Male / male nipple
Unión macho / macho

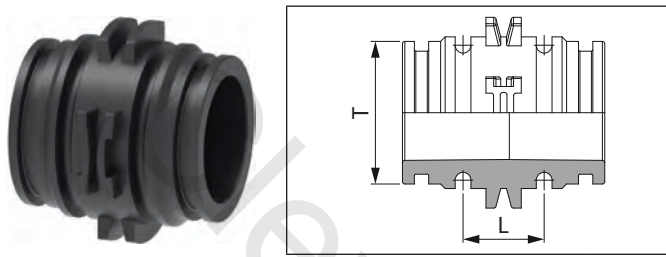

| COD. CODE CÓD. | T | L mm | Mat. Mat. Mat. | | O-ring | |
|----------------------|----|---------|----------------------|----|--------------|---------------|
| | | | | | COD. EPDM | COD. VITON |
| 259111 | T1 | 12 | PA | 25 | G11056 | G11056V |
| 259133 | T3 | 17 | PA | 25 | G11058 | G11058V |
| 259144 | T4 | 19 | PA | 25 | G11054 | G11054V |
| 259155 | T5 | 20 | PA | 10 | G11063 | G11063V |
| 259166 | T6 | 29 | PA | 10 | G11023 | G11023V |
| 259177 | T7 | 28 | PA | 10 | G11017x2 | G11017V x2 |
| 259199 | T9 | 31 | PA | 5 | G11067x2 | G11067V x2 |

NYLON®

Riduzione maschio / maschio
Male / male adapter
Reducción macho / macho

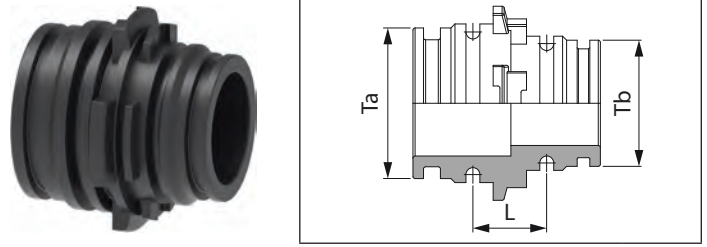

| COD. CODE CÓD. | L mm | Mat. Mat. Mat. | | Ta | O-ring | | Tb | O-ring | |
|----------------------|---------|----------------------|----|----|--------------|---------------|----|--------------|---------------|
| | | | | | COD. EPDM | COD. VITON | | COD. EPDM | COD. VITON |
| 259134 | 19 | PA | 10 | T4 | G11054 | G11054V | T3 | G11058 | G11058V |
| 259145 | 18 | PA | 10 | T5 | G11063 | G11063V | T4 | G11054 | G11054V |
| 259156 | 23 | PA | 10 | T6 | G11023 | G11023V | T5 | G11063 | G11063V |
| 259167 | 27 | PA | 10 | T7 | G11017 x2 | G11017V x2 | T6 | G11023 | G11023V |
| 259179 | 30 | PA | 5 | T9 | G11067 x2 | G11067V x2 | T7 | G11017 x2 | G11017V x2 |

NYLON®

Riduzione femmina / femmina
Female / female adapter
Reducción hembra / hembra

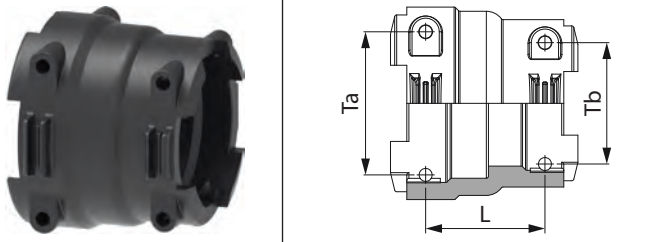

| COD. CODE CÓD. | L mm | Mat. Mat. Mat. | | Ta | fork | | |
|----------------------|---------|----------------------|----|----|----------------------|----|----------------------|
| | | | | | COD. CODE CÓD. | Tb | COD. CODE CÓD. |
| 259034 | 29 | PA | 25 | T4 | 010004 | T3 | 010003 |
| 259045 | 31 | PA | 10 | T5 | 010005 | T4 | 010004 |
| 259056 | 37 | PA | 10 | T6 | 010006 | T5 | 010005 |
| 259067 | 44 | PA | 10 | T7 | 010007 | T6 | 010006 |
| 259079 | 51 | PA | 5 | T9 | 010009 | T7 | 010007 |

NYLON®

Prolunga Femmina / maschio
Female / male extension
Prolongación hembra/macho

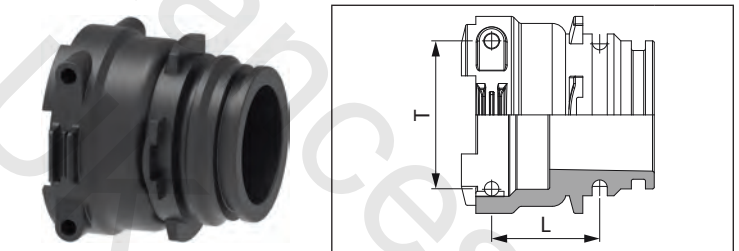

NEW

| COD. CODE CÓD. | T | L mm | Mat. Mat. Mat. | | fork | | O-ring | |
|----------------------|----|---------|----------------------|----|----------------------|--------------|---------------|--|
| | | | | | COD. CODE CÓD. | COD. EPDM | COD. VITON | |
| 259255 | T5 | 31 | PA | 10 | 010005 | G11063 | G11063V | |

NYLON®

RACCORDI CON ATTACCO A FORCHETTA FITTINGS WITH FORK COUPLING RACORES CON CONEXION DE HORQUILLA

Riduzione femmina / maschio
Female / male adapter
Reducción hembra / macho

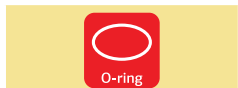
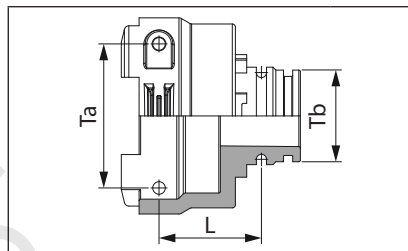

| COD. CODE CÓD. | L mm | Mat. Mat. Mat. | | Ta | COD. CODE CÓD. | Tb | COD. EPDM | COD. VITON |
|----------------|------|----------------|----|----|----------------|----|-----------|------------|
| 259236 | 19 | PA | 10 | T3 | 010003 | T6 | G11023 | G11023V |
| 259263 | 34 | PA | 10 | T6 | 010006 | T3 | G11058 | G11058V |
| 259267 | 40 | PA | 10 | T6 | 010006 | T7 | G11017 x2 | G11017V x2 |

NYLON®

Tappo femmina
Blanking cap
Tapón hembra

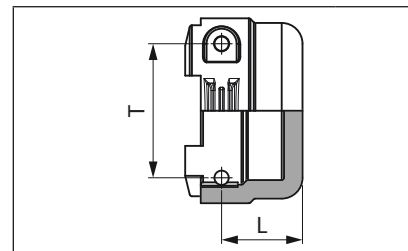

| COD. CODE CÓD. | T | L mm | Mat. Mat. Mat. | | COD. CODE CÓD. |
|----------------|----|------|----------------|----|----------------|
| 219010 | T1 | 14 | PA | 25 | 010001 |
| 219030 | T3 | 18 | PA | 25 | 010003 |
| 219040 | T4 | 19 | PA | 25 | 010004 |
| 219050 | T5 | 21 | PA | 10 | 010005 |
| 219060 | T6 | 24 | PA | 10 | 010006 |
| 219070 | T7 | 29 | PA | 10 | 010007 |
| 219090 | T9 | 33 | PA | 10 | 010009 |

NYLON®

Adattatore Camlock attacco femmina
Camlock adapter with female connection
Adaptador Camlock con conexión hembra

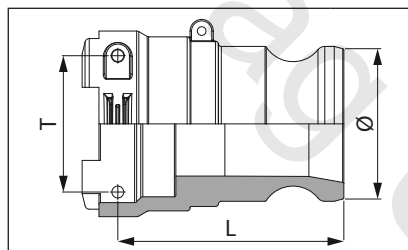

| COD. CODE CÓD. | T | Ø | L mm | Mat. Mat. Mat. | COD. CODE CÓD. |
|----------------|----|--------|------|----------------|----------------|
| 18106L | T6 | 1 1/2" | 80 | PA | 010006 |
| 18107L | T7 | 2" | 88 | PA | 010007 |
| 18109L | T9 | 3" | 100 | PA | 010009 |

NYLON®

Tappo maschio
Male plug
Tapón macho

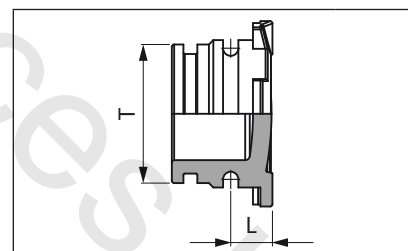

| COD. CODE CÓD. | T | L mm | Mat. Mat. Mat. | | COD. EPDM | COD. VITON |
|----------------|----|------|----------------|----|-----------|------------|
| 219110 | T1 | 6 | PA | 25 | G11056 | G11056V |
| 219130 | T3 | 9 | PA | 25 | G11058 | G11058V |
| 219140 | T4 | 10 | PA | 25 | G11054 | G11054V |
| 219150 | T5 | 10 | PA | 10 | G11063 | G11063V |
| 219160 | T6 | 13 | PA | 10 | G11023 | G11023V |
| 219170 | T7 | 14 | PA | 10 | G11017 x2 | G11017V x2 |
| 219190 | T9 | 16 | PA | 10 | G11067 x2 | G11067V x2 |

NYLON®

RACCORDI CON ATTACCO A FORCHETTA FITTINGS WITH FORK COUPLING RACORES CON CONEXION DE HORQUILLA

Raccordo 45° con attacco a forchetta femmina/femmina
45° fitting with female/female fork connection
Racor 45° con conexión de horquilla hembra/hembra

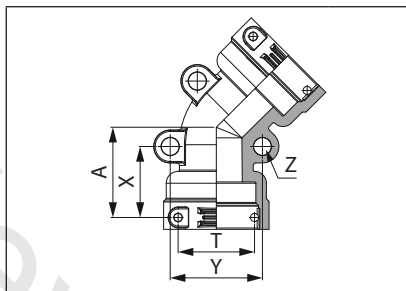

Raccordo 45° filettato maschio con attacco a forchetta femmina
45° fitting male threaded with female fork connection
Racor 45° roscado macho y conexión de horquilla hembra

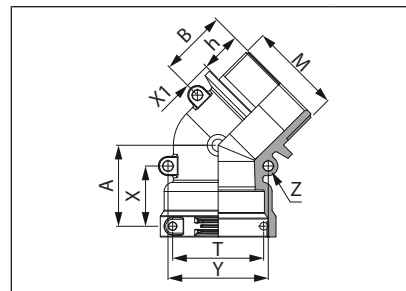

| COD. CODE Cód. | T | A mm | X mm | Y mm | Z mm | Mat. Mat. Mat. | | COD. CODE Cód. |
|----------------|----|------|------|------|------|----------------|----|----------------|
| 129333 | T3 | 34 | 27 | 35 | M6 | PA | 10 | 010003 |
| 129344 | T4 | 37 | 29 | 40 | M6 | PA | 10 | 010004 |
| 129355 | T5 | 41 | 31 | 48 | M6 | PA | 10 | 010005 |
| 129366 | T6 | 46 | 35 | 54 | M6 | PA | 10 | 010006 |
| 129377 | T7 | 53 | 39 | 65 | M6 | PA | 5 | 010007 |
| 129399 | T9 | 64 | 44 | 95 | M6 | PA | 5 | 010009 |



| COD. CODE Cód. | T | M | A mm | B mm | h mm | X mm | X1 mm | Y mm | Z mm | Mat. Mat. Mat. | | COD. CODE Cód. |
|----------------|----|------|------|------|------|------|-------|------|------|----------------|---|----------------|
| 11927B7 | T7 | G 2" | 52.5 | 57 | 27 | 39 | 16.5 | 65 | M6 | PA | 5 | 010007 |



NYLON®

NYLON®

Raccordo 45° con attacco a forchetta femmina/maschio
45° fitting with female/male fork connection
Racor 45° con conexión de horquilla hembra/macho

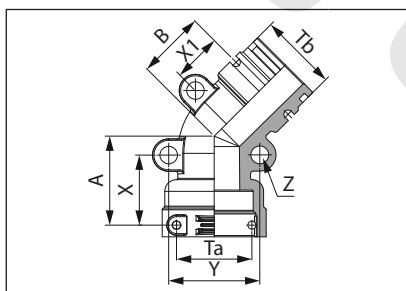

| COD. CODE Cód. | A mm | B mm | X mm | X1 mm | Y mm | Z mm | Mat. Mat. Mat. | | Ta | COD. CODE Cód. | Tb | O-ring | |
|----------------|------|------|------|-------|------|------|----------------|----|----|----------------|----|-----------|------------|
| | | | | | | | | | | | | COD. EPDM | COD. VITON |
| 129533 | 34 | 26 | 27 | 19 | 35 | M6 | PA | 10 | T3 | 010003 | T3 | G11058 | G11058V |
| 129544 | 37 | 27 | 29 | 19 | 40 | M6 | PA | 10 | T4 | 010004 | T4 | G11054 | G11054V |
| 129555 | 41 | 30 | 31 | 20 | 48 | M6 | PA | 10 | T5 | 010005 | T5 | G11063 | G11063V |
| 129566 | 46 | 33 | 35 | 22 | 54 | M6 | PA | 10 | T6 | 010006 | T6 | G11023 | G11023V |
| 129577 | 53 | 37 | 39 | 24 | 65 | M6 | PA | 5 | T7 | 010007 | T7 | G11017 x2 | G11017V x2 |
| 129599 | 64 | 45 | 44 | 24 | 95 | M6 | PA | 5 | T9 | 010009 | T9 | G11067 x2 | G11067V x2 |



NYLON®

RACCORDI CON ATTACCO A FORCHETTA FITTINGS WITH FORK COUPLING RACORES CON CONEXION DE HORQUILLA

Curva 90° femmina / femmina
90° female / female elbow
Curva 90° hembra / hembra



Curva 90° femmina / maschio
90° female / male elbow
Curva 90° hembra / macho

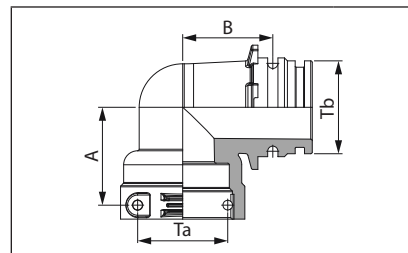
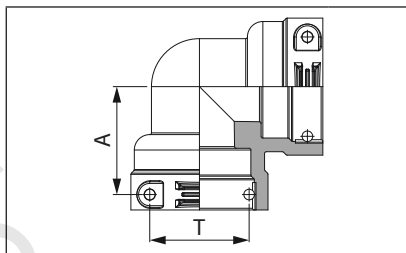

| COD. CODE CÓD. | T | A mm | Mat. Mat. Mat. |  | COD. CODE CÓD. |
|----------------------|----|---------|----------------------|---|----------------------|
| 129033 | T3 | 32 | PA | 10 | 010003 |
| 129044 | T4 | 36 | PA | 10 | 010004 |
| 129055 | T5 | 41 | PA | 10 | 010005 |
| 129066 | T6 | 49 | PA | 10 | 010006 |
| 129077 | T7 | 57 | PA | 5 | 010007 |
| 129099 | T9 | 75 | PA | 5 | 010009 |

NYLON®



| COD. CODE CÓD. | A mm | B mm | Mat. Mat. Mat. |  | Ta | COD. CODE CÓD. | Tb | COD. EPDM | COD. VITON |
|----------------------|---------|---------|----------------------|---|----|----------------------|----|--------------|---------------|
| 129211 | 30 | 17 | PA | 10 | T1 | 010001 | T1 | G11056 | G11056V |
| 129233 | 32 | 29 | PA | 10 | T3 | 010003 | T3 | G11058 | G11058V |
| 129244 | 36 | 33 | PA | 10 | T4 | 010004 | T4 | G11054 | G11054V |
| 129255 | 41 | 38 | PA | 10 | T5 | 010005 | T5 | G11063 | G11063V |
| 129266 | 49 | 49 | PA | 10 | T6 | 010006 | T6 | G11023 | G11023V |
| 129277 | 57 | 52 | PA | 5 | T7 | 010007 | T7 | G11017 x2 | G11017V x2 |
| 129299 | 75 | 69 | PA | 5 | T9 | 010009 | T9 | G11067 x2 | G11067V x2 |

NYLON®



RACCORDI CON ATTACCO A FORCHETTA

FITTINGS WITH FORK COUPLING

RACORES CON CONEXION DE HORQUILLA

Collettore a 3 vie
3 way manifold
Colector de 3 vias

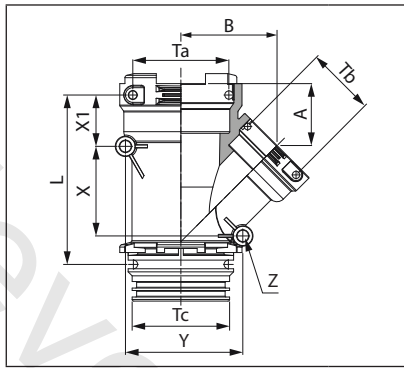

| COD. CODE CÓD. | A mm | B mm | L mm | X mm | X1 mm | Y mm | Z mm | Mat. Mat. Mat. | 5 | Ta | fork | | Tc | O-ring | | |
|----------------------|---------|---------|---------|---------|----------|---------|---------|----------------------|---|----|----------------------|----|--------|----------------------|----------------------|------------|
| | | | | | | | | | | | COD. CODE CÓD. | Tb | | COD. CODE CÓD. | COD. CODE CÓD. | |
| 179275 | 38 | 59 | 104 | 55 | 31 | 72 | M6 | PA | 5 | T7 | 010007 | T5 | 010005 | T7 | G11017 x2 | G11017V x2 |

NYLON®

Collettore a 3 vie
3 way manifold
Colector de 3 vias

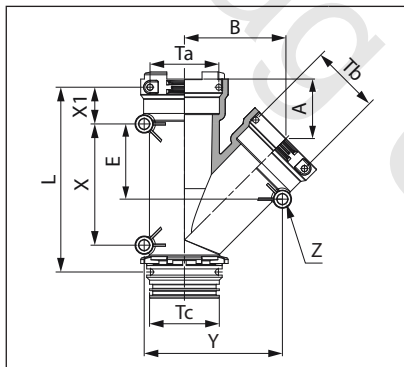

| COD. CODE CÓD. | A mm | B mm | E mm | L mm | X mm | X1 mm | Y mm | Z mm | Mat. Mat. Mat. | 5 | Ta | fork | | Tc | O-ring | |
|----------------------|---------|---------|---------|---------|---------|----------|---------|---------|----------------------|---|----|----------------------|----|--------|----------------------|----------------------|
| | | | | | | | | | | | | COD. CODE CÓD. | Tb | | COD. CODE CÓD. | COD. CODE CÓD. |
| 179266 | 37 | 71 | 54 | 133 | 82 | 29 | 95 | M6 | PA | 5 | T6 | 010006 | T6 | 010006 | T6 | G11023 |
| 179277 | 44 | 87 | 65 | 159 | 104 | 32 | 119 | M6 | PA | 5 | T7 | 010007 | T7 | 010007 | T7 | G11017 x 2 |
| 179299 | 48 | 109 | 78 | 192 | 131 | 36 | 161 | M8 | PA | 5 | T9 | 010009 | T9 | 010009 | T9 | G11067 x 2 |

NYLON®

RACCORDI CON ATTACCO A FORCHETTA FITTINGS WITH FORK COUPLING RACORES CON CONEXION DE HORQUILLA

Raccordo a "T" con attacco femmina
Tee fitting with female connection
Racor en "T" con conexión hembra

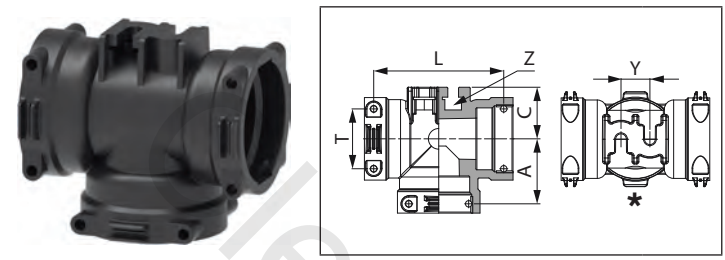

| COD. CODE Cód. | T | A mm | C mm | L mm | Y mm | Z mm | Mat. Mat. Mat. | | COD. CODE Cód. |
|----------------|----|------|------|------|------|------|----------------|----|----------------|
| 139033 | T3 | 36 | 27 | 63 | 14 | M5 | PA | 10 | 010003 |
| 139044 | T4 | 32 | 25 | 71 | 14 | M5 | PA | 10 | 010004 |
| 139055 | T5 | 41 | 32 | 81 | 16 | M6 | PA | 10 | 010005 |
| 139066 | T6 | 49 | 35 | 97 | 24 | M6 | PA | 10 | 010006 |
| 139077 | T7 | 57 | 41 | 113 | 32 | M6 | PA | 5 | 010007 |
| 139099 | T9 | 75 | 57 | 150 | 50 | M8 | PA | 5 | 010009 |

NYLON®

Raccordo 4 vie a 90° con attacco femmina
4-way fitting with female connection
Racor de 4 vías a 90° con conexión hembra

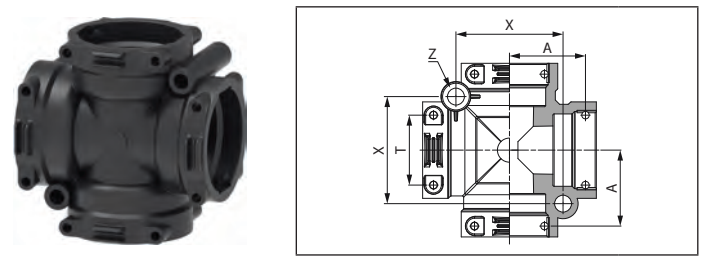

| COD. CODE Cód. | T | A mm | X mm | Z mm | Mat. Mat. Mat. | | COD. CODE Cód. |
|----------------|----|------|------|------|----------------|----|----------------|
| 159033 | T3 | 32 | 44 | M6 | PA | 10 | 010003 |
| 159044 | T4 | 36 | 51 | M6 | PA | 10 | 010004 |
| 159055 | T5 | 41 | 59 | M6 | PA | 10 | 010005 |
| 159066 | T6 | 49 | 67 | M6 | PA | 10 | 010006 |
| 159077 | T7 | 57 | 77 | M6 | PA | 5 | 010007 |
| 159099 | T9 | 75 | 108 | M6 | PA | 1 | 010009 |

NYLON®

Raccordo a "T" con attacco maschio
Tee fitting with male connection
Racor en "T" con conexión macho

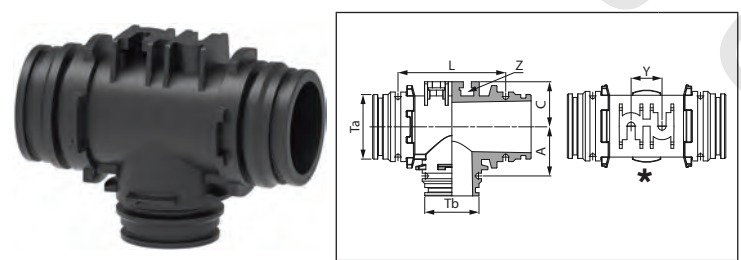

| COD. CODE Cód. | A mm | C mm | L mm | Y mm | Z mm | Mat. Mat. Mat. | | Ta | | COD. EPDM | COD. VITON | Tb | COD. EPDM | COD. VITON |
|----------------|------|------|------|------|------|----------------|---|----|--|-----------|------------|----|-----------|------------|
| 139165 | 38 | 35 | 84 | 24 | M6 | PA | 5 | T6 | | G11023 | G11023V | T5 | G11063 | G11063V |
| 139166 | 42 | 35 | 84 | 24 | M6 | PA | 5 | T6 | | G11023 | G11023V | T6 | G11023 | G11023V |

NYLON®

Il raccordo può essere fissato ad una superficie, mediante due viti a testa esagonale da inserire nelle asole poste sulla parte superiore del raccordo.

The union is fastened to a surface with two hexagonal-head screws inserted into slots on the upper part of the union.

El racor puede ser fijado a una superficie por medio de dos tornillos de cabeza hexagonal para introducir en las ranuras colocadas en la parte superior del racor.

RACCORDI CON ATTACCO A FORCHETTA FITTINGS WITH FORK COUPLING RACORES CON CONEXION DE HORQUILLA

Raccordo maschio con portamanometro G 1/4 F
Male fitting for pressure gauge G 1/4 F
Racor macho con portamanómetro G1/4F

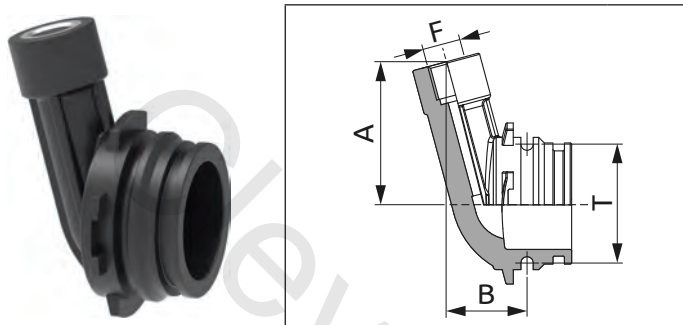

O-ring

| COD. CODE CÓD. | T | F | A mm | B mm | Mat. Mat. Mat. | COD. EPDM | COD. VITON |
|----------------------|----|--------|---------|---------|----------------------|--------------|---------------|
| 219350 | T5 | G 1/4" | 49 | 37 | PA | G11063 | G11063V |
| 219360 | T6 | G 1/4" | 49 | 30 | PA | G11023 | G11023V |

NYLON®

Raccordo femmina con portamanometro G 1/4 F
Female fitting for pressure gauge G 1/4 F
Racor hembra con portamanómetro G1/4F

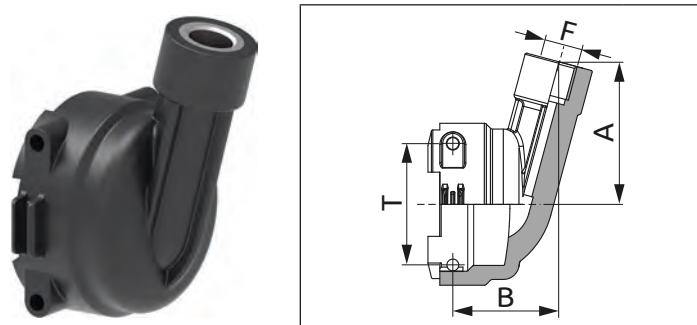

fork

| COD. CODE CÓD. | T | F | A mm | B mm | Mat. Mat. Mat. | COD. CODE CÓD. |
|----------------------|----|--------|---------|---------|----------------------|----------------------|
| 219250 | T5 | G 1/4" | 49 | 28 | PA | 010005 |
| 219260 | T6 | G 1/4" | 49 | 41 | PA | 010006 |

NYLON®



RACCORDI A FORCHETTA PER TUBO RIGIDO FORK FITTINGS FOR RIGID PIPE RACORES DE HORQUILLA PARA TUBO RÍGIDO

Raccordo dritto maschio per tubo rigido
Straight male fitting for rigid pipe
Racor recto macho para tubo rígido

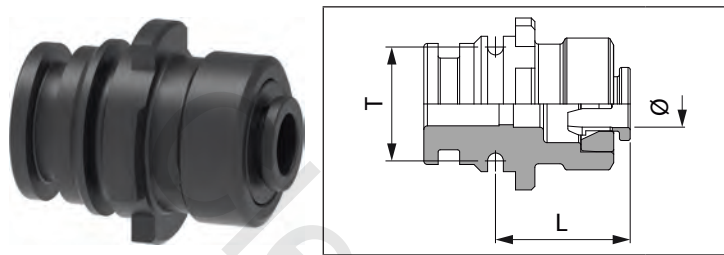

| COD. CODE CÓD. | T | Ø | L mm | | O-ring | |
|----------------------|----|-------|---------|---|--------------|---------------|
| | | | | | COD. EPDM | COD. VITON |
| 10911C00 | T1 | 1/4" | 19 | 5 | G11056 | G11056V |
| 10911C01 | T1 | 3/8" | 19 | 5 | G11056 | G11056V |
| 10911C08 | T1 | 8 mm | 22 | 5 | G11056 | G11056V |
| ▶ 10913C00 | T3 | 1/4" | 22 | 5 | G11058 | G11058V |
| ▶ 10913C01 | T3 | 3/8" | 22 | 5 | G11058 | G11058V |
| ▶ 10913C08 | T3 | 8 mm | 22 | 5 | G11058 | G11058V |
| ▶ 10913C10 | T3 | 10 mm | 22 | 5 | G11058 | G11058V |

NYLON®

Raccordo curvo maschio per tubo rigido
Elbow male fitting for rigid pipe
Racor curvo macho para tubo rígido

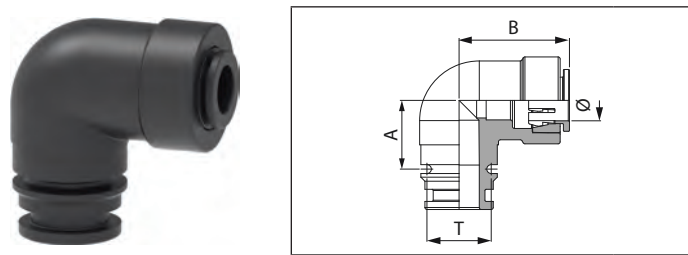

| COD. CODE CÓD. | T | Ø | A mm | B mm | | O-ring | |
|----------------------|----|-------|---------|---------|---|--------------|---------------|
| | | | | | | COD. EPDM | COD. VITON |
| 11911C00 | T1 | 1/4" | 17 | 28 | 5 | G11056 | G11056V |
| 11911C01 | T1 | 3/8" | 17 | 28 | 5 | G11056 | G11056V |
| 11911C08 | T1 | 8 mm | 17 | 28 | 5 | G11056 | G11056V |
| ▶ 11913C00 | T3 | 1/4" | 25 | 28 | 5 | G11058 | G11058V |
| ▶ 11913C01 | T3 | 3/8" | 25 | 28 | 5 | G11058 | G11058V |
| ▶ 11913C08 | T3 | 8 mm | 25 | 28 | 5 | G11058 | G11058V |
| ▶ 11913C10 | T3 | 10 mm | 25 | 28 | 5 | G11058 | G11058V |
| ▶ 11913C16A | T3 | 16 mm | 25 | 42 | 5 | G11058 | G11058V |

NYLON®

Raccordo dritto femmina per tubo rigido
Straight female fitting for rigid pipe
Racor recto hembra para tubo rígido

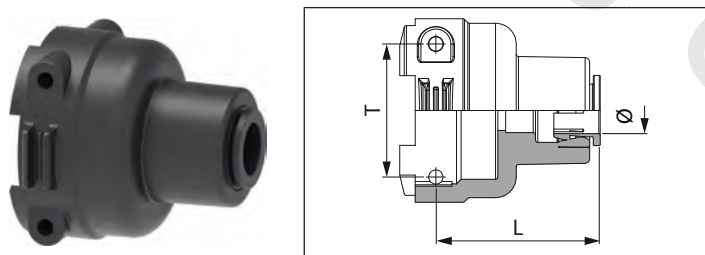

NEW

| COD. CODE CÓD. | T | Ø | L mm | | fork |
|----------------------|----|-------|---------|---|----------------------|
| | | | | | COD. CODE CÓD. |
| ▶ 10903C00 | T3 | 1/4" | 29 | 5 | 010003 |
| ▶ 10903C01 | T3 | 3/8" | 29 | 5 | 010003 |
| ▶ 10903C08 | T3 | 8 mm | 29 | 5 | 010003 |
| ▶ 10903C10 | T3 | 10 mm | 29 | 5 | 010003 |

NYLON®

Raccordo curvo femmina per tubo rigido
Elbow female fitting for rigid pipe
Racor curvo hembra para tubo rígido

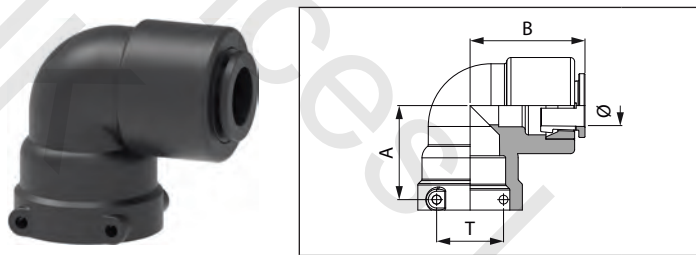

| COD. CODE CÓD. | T | Ø | A mm | B mm | | fork |
|----------------------|----|-------|---------|---------|---|----------------------|
| | | | | | | COD. CODE CÓD. |
| ▶ 11901C10 | T1 | 10 mm | 25 | 27 | 5 | 010013 |
| ▶ 11903C00 | T3 | 1/4" | 25 | 27 | 5 | 010003 |
| ▶ 11903C01 | T3 | 3/8" | 25 | 27 | 5 | 010003 |
| ▶ 11903C08 | T3 | 8 mm | 25 | 27 | 5 | 010003 |
| ▶ 11903C10 | T3 | 10 mm | 25 | 27 | 5 | 010003 |

NYLON®

Compatible
Compatible
Compatible



PASSAPARETE CISTERNA TANK BULKHEAD PASAMUROS DEPOSITOS

Bocchettone di scarico con attacco a forchetta T7 / T9
Drain union with T7 / T9 fork coupling
Boca de descarga con racor de horquilla T7 / T9

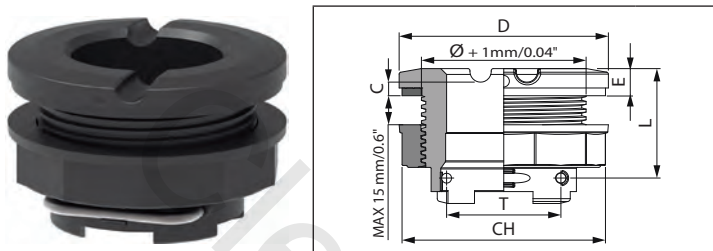

| COD. CODE Cód. | T | Ø mm | C mm | D mm | E mm | L mm | CH mm | Mat. Mat. Mat. |
|----------------|----|------|------|------|------|------|-------|----------------|
| 229070 | T7 | 85 | 7 | 108 | 14 | 57 | 100 | PA |
| 229090 | T9 | 116 | 7 | 143 | 16 | 61 | 134 | PA |

NYLON®

Guarnizione in EPDM (a richiesta in VITON®)
EPDM gasket (VITON® optional)
Junta de sellado en EPDM (Viton® bajo pedido)

Presse antivortice filettata maschio con attacco a forchetta
Male threaded anti-vortex intake with fork coupling
Conexión antirremolino rosca macho con empalme de horquilla

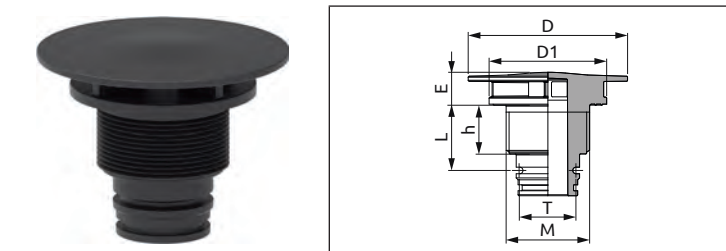

NEW



| COD. CODE Cód. | T | M | D mm | D1 mm | E mm | h mm | L mm | Mat. Mat. Mat. | COD. EPDM | COD. VITON |
|----------------|----|----------|------|-------|------|------|------|----------------|-----------|------------|
| 229430 | T3 | G 1 1/4" | 80 | 59 | 16 | 25 | 33 | PA | G11058 | G11058V |

NYLON®

Presse antivortice con attacco a forchetta T7 / T9
Anti-vortex intake with T7 / T9 fork coupling
Conexión antirremolino con racor de horquilla T7 / T9

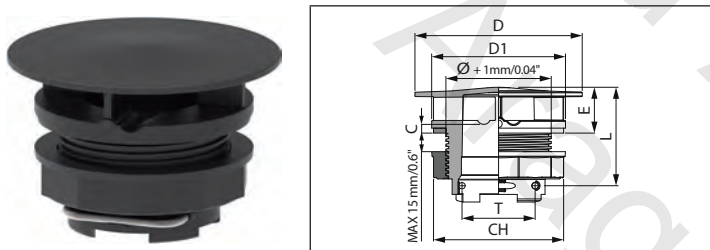

| COD. CODE Cód. | T | Ø mm | C mm | D mm | D1 mm | E mm | L mm | CH mm | Mat. Mat. Mat. |
|----------------|----|------|------|------|-------|------|------|-------|----------------|
| 229170 | T7 | 85 | 7 | 135 | 108 | 37 | 57 | 100 | PA |
| 229190 | T9 | 116 | 7 | 170 | 143 | 43 | 88 | 134 | PA |

NYLON®

Guarnizione in EPDM (a richiesta in VITON®)
EPDM gasket (VITON® optional)
Junta de sellado en EPDM (Viton® bajo pedido)

Passaparete filettato maschio con attacco a forchetta
Male threaded bulkhead connector with fork coupling
Pasamuros rosca macho con empalme de horquilla

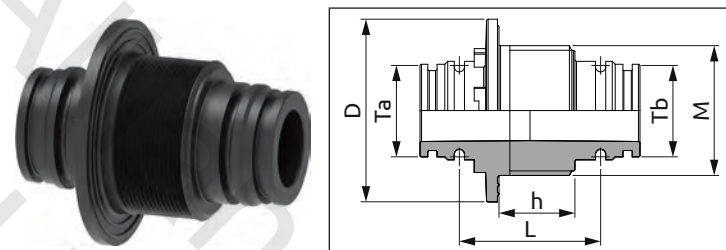

NEW



| COD. CODE Cód. | M | D mm | h mm | L mm | Mat. Mat. Mat. | Ta | COD. EPDM | COD. VITON | Tb | COD. EPDM | COD. VITON |
|----------------|----------|------|------|------|----------------|----|-----------|------------|----|-----------|------------|
| 229533 | G 1 1/4" | 59 | 25 | 46 | PA | T3 | G11058 | G11058V | T3 | G11058 | G11058V |

NYLON®

Raccordo passaparete attacco a forchetta T7 / T9
Bulkhead fitting with T7 / T9 fork coupling
Racor pasamuros de horquilla T7 / T9

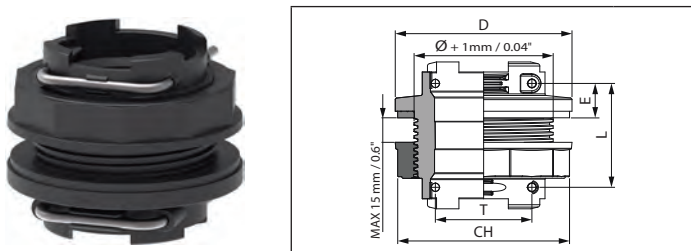

| COD. CODE Cód. | T | Ø mm | D mm | E mm | L mm | CH mm | Mat. Mat. Mat. |
|----------------|----|------|------|------|------|-------|----------------|
| 229277 | T7 | 85 | 108 | 14 | 57 | 100 | PA |
| 229299 | T9 | 116 | 143 | 16 | 61 | 134 | PA |

NYLON®

Guarnizione in EPDM (a richiesta in VITON®)
EPDM gasket (VITON® optional)
Junta de sellado en EPDM (Viton® bajo pedido)

RACCORDI ATTACCO A MORSETTO HOSE FITTING WITH CLAMP COUPLING RACORES SOPORTE ABRAZADERA

Adattatore maschio flangiato attacco a morsetto*
Flanged male adapter, clamp coupling*
Adaptador macho soporte abrazadera*



Adattatore femmina flangiato attacco a morsetto*
Flanged female adapter with clamp coupling*
Adaptador hembra soporte abrazadera*

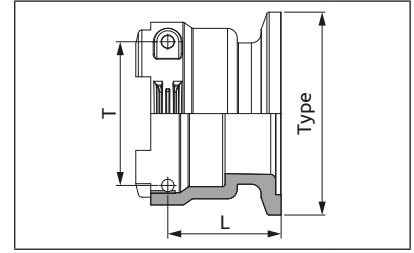
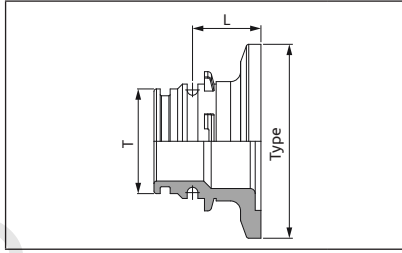

| COD. CODE Cód. | T | Tipo Type Tipo | L mm | Mat. Mat. Mat. | | O-ring | |
|----------------|----|----------------|------|----------------|----|-----------|------------|
| | | | | | | COD. EPDM | COD. VITON |
| 279134 | T3 | 1" Full port | 27 | PA | 10 | G11058 | G11058V |
| 279144 | T4 | 1" Full port | 27 | PA | 10 | G11054 | G11054V |
| 279154 | T5 | 1" Full port | 28 | PA | 10 | G11063 | G11063V |
| 279157 | T5 | 2" Std. port | 28 | PA | 10 | G11063 | G11063V |
| 279167 | T6 | 2" Std. port | 31 | PA | 10 | G11023 | G11023V |
| 2791671 | T6 | 2" Full port | 31 | PA | 10 | G11023 | G11023V |
| 279177 | T7 | 2" Std. port | 32 | PA | 10 | G11017 x2 | G11017V x2 |
| 2791771 | T7 | 2" Full port | 32 | PA | 10 | G11017 x2 | G11017V x2 |
| 279199 | T9 | 3" Full port | 36 | PA | 5 | G11067 x2 | G11067V x2 |

| COD. CODE Cód. | T | Tipo Type Tipo | L mm | Mat. Mat. Mat. | | fork | |
|----------------|----|----------------|------|----------------|----|----------------|----------------|
| | | | | | | COD. CODE Cód. | COD. CODE Cód. |
| 279034 | T3 | 1" Full port | 36 | PA | 10 | 010003 | |
| 279044 | T4 | 1" Full port | 37 | PA | 10 | 010004 | |
| 279054 | T5 | 1" Full port | 39 | PA | 10 | 010005 | |
| 279057 | T5 | 2" Std port | 39 | PA | 10 | 010005 | |
| 279067 | T6 | 2" Std port | 43 | PA | 10 | 010006 | |
| 2790671 | T6 | 2" Full port | 43 | PA | 10 | 010006 | |
| 279077 | T7 | 2" Std port | 46 | PA | 10 | 010007 | |
| 2790771 | T7 | 2" Full port | 46 | PA | 10 | 010007 | |
| 279099 | T9 | 3" Full port | 53 | PA | 5 | 010009 | |

NYLON®

*: *Compatibile con attacchi tipo Banjo®, Hypro® e Bee Valve®*
*: *Suitable for use with Banjo®, Hypro® and Bee Valve® connections*
*: *Compatible con las conexiones tipo Banjo®, Hypro® y Bee Valve®*

NYLON®

*: *Compatibile con attacchi tipo Banjo®, Hypro® e Bee Valve®*
*: *Suitable for use with Banjo®, Hypro® and Bee Valve® connections*
*: *Compatible con las conexiones tipo Banjo®, Hypro® y Bee Valve®*

Kit morsetto di serraggio completo di vite
Kit of tightening clamp with screw
Kit abrazadera completa con tornillo

| COD. CODE Cód. | F | Tipo Type Tipo | | EPDM | | Viton® | |
|----------------|--------------|----------------|----|------------|------------|--------|------------|
| | | | | 3 | 10 | 3 | 10 |
| 1 10A00100 | 1" Full port | NYLON® | 10 | 18103B.050 | 18123B.050 | 10 | 18123B.050 |
| 1 10A00200 | 2" Std. port | NYLON® | 10 | 18106B.050 | 18126B.050 | 10 | 18126B.050 |
| 1 10A00220 | 2" Full port | NYLON® | 10 | 18107B.050 | 18127B.050 | 10 | 18127B.050 |
| 1 10A00300 | 3" Full port | NYLON® | 10 | 18109B.050 | 18129B.050 | 10 | 18129B.050 |
| 2 10A01100 | 1" Full port | INOX | 10 | 18103B.050 | 18123B.050 | 10 | 18123B.050 |
| 2 10A01200 | 2" Std. port | INOX | 10 | 18106B.050 | 18126B.050 | 10 | 18126B.050 |
| 2 10A01220 | 2" Full port | INOX | 10 | 18107B.050 | 18127B.050 | 10 | 18127B.050 |
| 2 10A01300 | 3" Full port | INOX | 10 | 18109B.050 | 18129B.050 | 10 | 18129B.050 |



Accessori da ordinare separatamente
Accessories to order separately
Accesorios a pedir por separado

RACCORDI ATTACCO A MORSETTO

HOSE FITTING WITH CLAMP COUPLING

RACORES SOPORTE ABRAZADERA

Raccordi dritti attacco a morsetto*
Straight hose fitting with clamp coupling*
Racores rectos soporte abrazadera*

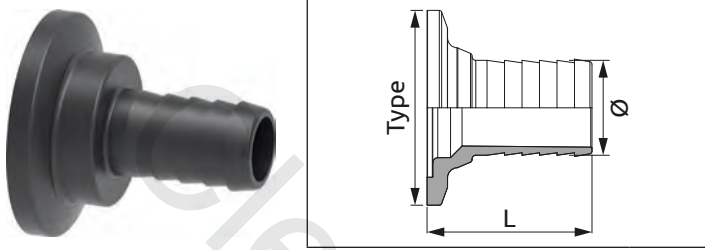

| COD. CODE CÓD. | Tipo Type Tipo | Ø mm | Ø inch | L mm | Mat. Mat. Mat. | |
|----------------------|----------------------|---------|-----------|---------|----------------------|----|
| 10A120 | 1" Full port | 20 | 3/4" | 53 | PA | 10 |
| 10A125 | 1" Full port | 25 | 1" | 53 | PA | 10 |
| 10A132 | 1" Full port | 32 | 1 1/4" | 58 | PA | 10 |
| 10A225 | 2" Std port | 25 | 1" | 53 | PA | 5 |
| 10A232 | 2" Std port | 32 | 1 1/4" | 58 | PA | 5 |
| 10A238 | 2" Std port | 38 | 1 1/2" | 66 | PA | 5 |
| 10A252 | 2" Std port | 52 | 2" | 73 | PA | 5 |
| 10A325 | 2" Full port | 25 | 1" | 53 | PA | 5 |
| 10A332 | 2" Full port | 32 | 1 1/4" | 58 | PA | 5 |
| 10A338 | 2" Full port | 38 | 1 1/2" | 66 | PA | 5 |
| 10A352 | 2" Full port | 52 | 2" | 73 | PA | 5 |
| 10A363 | 2" Full port | 63 | 2 1/2" | 88 | PA | 5 |
| 10A452 | 3" Full port | 52 | 2" | 73 | PA | 2 |
| 10A475 | 3" Full port | 75 | 3" | 98 | PA | 2 |

NYLON®

*: *Compatibile con attacchi tipo Banjo®, Hypro® e Bee Valve®*
*: *Suitable for use with Banjo®, Hypro® and Bee Valve® connections*
*: *Compatible con las conexiones tipo Banjo®, Hypro® y Bee Valve®*

Raccordi 45° attacco a morsetto*
45° hose fitting with clamp coupling*
Racores 45° soporte abrazadera*

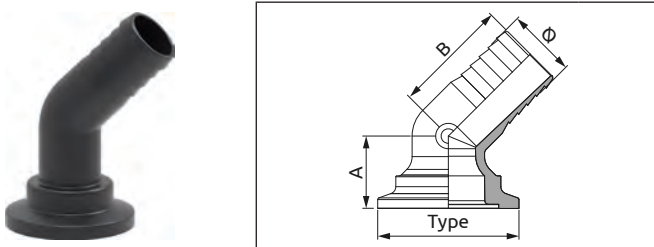

| COD. CODE CÓD. | Tipo Type Tipo | Ø mm | Ø inch | A mm | B mm | Mat. Mat. Mat. | |
|----------------------|----------------------|---------|-----------|---------|---------|----------------------|----|
| 11A0125 | 1" Full port | 25 | 1" | 46 | 50 | PA | 10 |
| 11A0238 | 2" Std port | 38 | 1 1/2" | 40 | 64 | PA | 5 |
| 11A0252 | 2" Std port | 52 | 2" | 40 | 70 | PA | 5 |
| 11A0338 | 2" Full port | 38 | 1 1/2" | 40 | 64 | PA | 5 |
| 11A0352 | 2" Full port | 52 | 2" | 40 | 70 | PA | 5 |
| 11A0475 | 3" Full port | 75 | 3" | 47 | 99 | PA | 2 |

NYLON®

*: *Compatibile con attacchi tipo Banjo®, Hypro® e Bee Valve®*
*: *Suitable for use with Banjo®, Hypro® and Bee Valve® connections*
*: *Compatible con las conexiones tipo Banjo®, Hypro® y Bee Valve®*

Raccordi 90° attacco a morsetto*
90° hose fitting with clamp coupling*
Racores 90° soporte abrazadera*

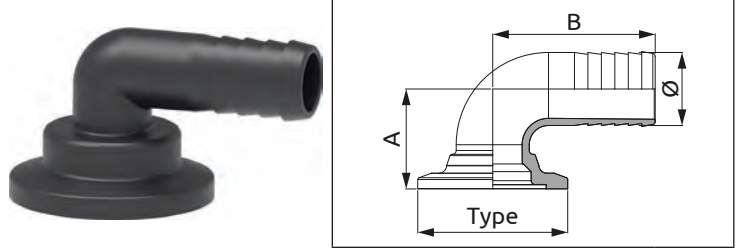

| COD. CODE CÓD. | Tipo Type Tipo | Ø mm | Ø inch | A mm | B mm | Mat. Mat. Mat. | |
|----------------------|----------------------|---------|-----------|---------|---------|----------------------|----|
| 11A2120 | 1" Full port | 20 | 3/4" | 34 | 53 | PA | 10 |
| 11A2125 | 1" Full port | 25 | 1" | 47 | 57 | PA | 10 |
| 11A2132 | 1" Full port | 32 | 1 1/4" | 47 | 74 | PA | 10 |
| 11A2225 | 2" Std port | 25 | 1" | 47 | 57 | PA | 5 |
| 11A2232 | 2" Std port | 32 | 1 1/4" | 47 | 74 | PA | 5 |
| 11A2238 | 2" Std port | 38 | 1 1/2" | 52 | 85 | PA | 5 |
| 11A2252 | 2" Std port | 52 | 2" | 63 | 92 | PA | 5 |
| 11A2338 | 2" Full port | 38 | 1 1/2" | 52 | 85 | PA | 5 |
| 11A2352 | 2" Full port | 52 | 2" | 63 | 92 | PA | 5 |
| 11A2452 | 3" Full port | 52 | 2" | 63 | 92 | PA | 2 |
| 11A2475 | 3" Full port | 75 | 3" | 87 | 125 | PA | 2 |

NYLON®

*: *Compatibile con attacchi tipo Banjo®, Hypro® e Bee Valve®*
*: *Suitable for use with Banjo®, Hypro® and Bee Valve® connections*
*: *Compatible con las conexiones tipo Banjo®, Hypro® y Bee Valve®*

Raccordi 90° attacco a morsetto*
90° fitting with clamp coupling*
Racores 90° soporte abrazadera*

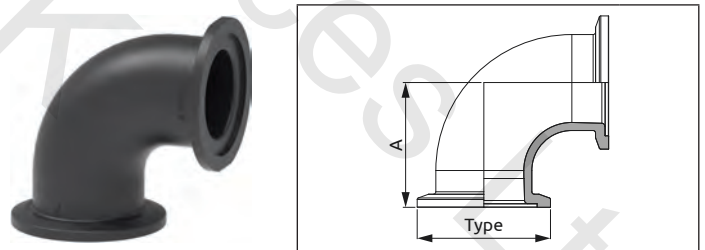

| COD. CODE CÓD. | Tipo Type Tipo | A mm | Mat. Mat. Mat. | |
|----------------------|----------------------|---------|----------------------|----|
| 12A211 | 1" Full port | 47 | PA | 10 |
| 12A222 | 2" Std port | 63 | PA | 5 |
| 12A233 | 2" Full port | 78 | PA | 5 |
| 12A244 | 3" Full port | 76 | PA | 2 |

NYLON®

*: *Compatibile con attacchi tipo Banjo®, Hypro® e Bee Valve®*
*: *Suitable for use with Banjo®, Hypro® and Bee Valve® connections*
*: *Compatible con las conexiones tipo Banjo®, Hypro® y Bee Valve®*

RACCORDI ATTACCO A MORSETTO HOSE FITTING WITH CLAMP COUPLING RACORES SOPORTE ABRAZADERA

Raccordi 45° attacco a morsetto*
45° fitting with clamp coupling*
Racores 45° soporte abrazadera*

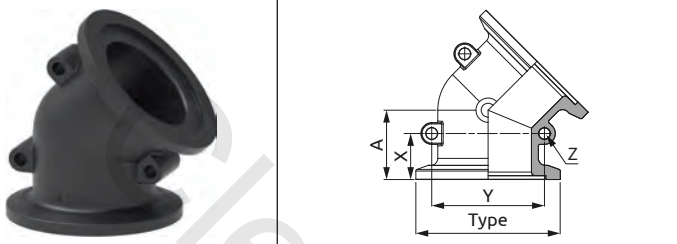

| COD. CODE CÓD. | Tipo Type Tipo | A mm | X mm | Y mm | Z mm | Mat. Mat. Mat. | |
|----------------|----------------|------|------|------|------|----------------|---|
| 12A011 | 1" Full port | 38 | - | - | - | PA | 5 |
| 12A022 | 2" Std port | 40 | - | - | - | PA | 5 |
| 12A033 | 2" Full port | 40 | 27 | 65 | M6 | PA | 5 |
| 12A044 | 3" Full port | 46 | 27 | 95 | M6 | PA | 5 |

NYLON®

*: *Compatibile con attacchi tipo Banjo®, Hypro® e Bee Valve®*
*: *Suitable for use with Banjo®, Hypro® and Bee Valve® connections*
*: *Compatible con las conexiones tipo Banjo®, Hypro® y Bee Valve®*

Raccordo a 4 vie attacco a morsetto*
4-way fitting with clamp coupling*
Racor de 4 vías soporte abrazadera*

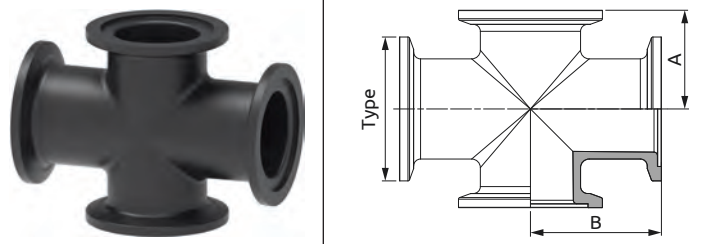

| COD. CODE CÓD. | Tipo Type Tipo | A mm | B mm | Mat. Mat. Mat. | |
|----------------|----------------|------|------|----------------|---|
| 15A011 | 1" Full port | 45 | 45 | PA | 5 |
| 15A022 | 2" Std port | 57 | 57 | PA | 5 |
| 15A033 | 2" Full port | 57 | 76 | PA | 5 |
| 15A044 | 3" Full port | 71 | 89 | PA | 2 |

NYLON®

*: *Compatibile con attacchi tipo Banjo®, Hypro® e Bee Valve®*
*: *Suitable for use with Banjo®, Hypro® and Bee Valve® connections*
*: *Compatible con las conexiones tipo Banjo®, Hypro® y Bee Valve®*

Raccordi T attacco a morsetto*
3-way Tee fitting with clamp coupling*
Racores T soporte abrazadera*

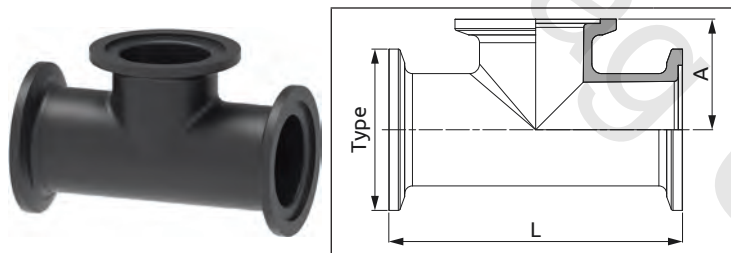

| COD. CODE CÓD. | Tipo Type Tipo | A mm | L mm | Mat. Mat. Mat. | |
|----------------|----------------|------|------|----------------|---|
| 13A011 | 1" Full port | 46 | 91 | PA | 5 |
| 13A022 | 2" Std port | 57 | 114 | PA | 5 |
| 13A033 | 2" Full port | 57 | 152 | PA | 5 |
| 13A044 | 3" Full port | 71 | 178 | PA | 2 |

NYLON®

*: *Compatibile con attacchi tipo Banjo®, Hypro® e Bee Valve®*
*: *Suitable for use with Banjo®, Hypro® and Bee Valve® connections*
*: *Compatible con las conexiones tipo Banjo®, Hypro® y Bee Valve®*

Raccordo Y 3 vie attacco a morsetto*
3-way Y fitting with clamp coupling*
Racor Y (3 vías) soporte abrazadera*

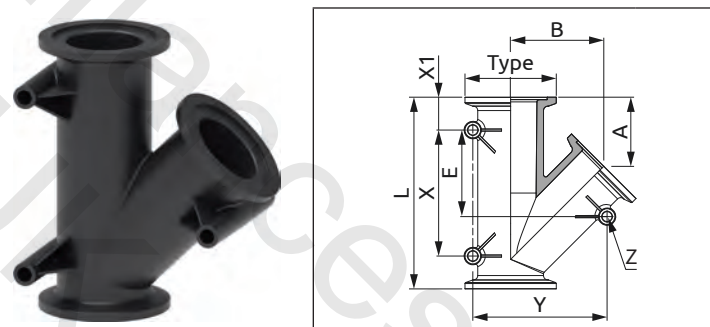

| COD. CODE CÓD. | Tipo Type Tipo | A mm | B mm | E mm | L mm | X mm | X1 mm | Y mm | Z mm | Mat. Mat. Mat. |
|----------------|----------------|------|------|------|------|------|-------|------|------|----------------|
| 17A033 | 2" Full port | 63 | 85 | 79 | 175 | 115 | 30 | 122 | M8 | PA |
| 17A044 | 3" Full port | 75 | 110 | 101 | 218 | 158 | 30 | 171 | M8 | PA |

NYLON®

*: *Compatibile con attacchi tipo Banjo®, Hypro® e Bee Valve®*
*: *Suitable for use with Banjo®, Hypro® and Bee Valve® connections*
*: *Compatible con las conexiones tipo Banjo®, Hypro® y Bee Valve®*

RACCORDI ATTACCO A MORSETTO

HOSE FITTING WITH CLAMP COUPLING

RACORES SOPORTE ABRAZADERA

Riduzione attacco a morsetto*
Clamp fitting adapter*
Reducción soporte abrazadera*

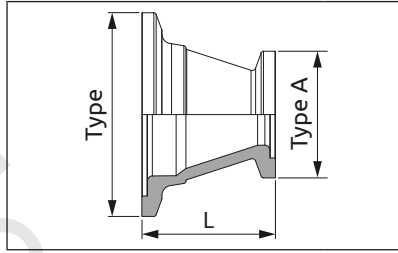
**NEW**

| COD. CODE CÓD. | Tipo Type Tipo | Tipo A A Type Tipo A | L mm | Mat. Mat. Mat. | |
|----------------------|----------------------|----------------------------|---------|----------------------|----|
| ▶ 25A021 | 2" Std port | 1" Full port | 54 | PA | 10 |
| ▶ 25A031 | 2" Full port | 1" Std port | 55 | PA | 10 |
| ▶ 25A032 | 2" Full port | 2" Std port | 54 | PA | 10 |
| ▶ 25A042 | 3" Full port | 2" Std port | 54 | PA | 10 |
| ▶ 25A043 | 3" Full port | 2" Full port | 54 | PA | 10 |

NYLON®

*: *Compatibile con attacchi tipo Banjo®, Hypro® e Bee Valve®*
*: *Suitable for use with Banjo®, Hypro® and Bee Valve® connections*
*: *Compatible con las conexiones tipo Banjo®, Hypro® y Bee Valve®*

Adattatore Camlock - attacco a morsetto*
Camlock adapter with clamp fitting*
Adaptador Camlock - Soporte abrazadera*

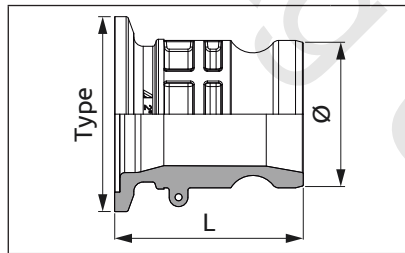
**NEW**

| COD. CODE CÓD. | Tipo Type Tipo | Ø | L mm | Mat. Mat. Mat. | |
|----------------------|----------------------|----|---------|----------------------|---|
| ▶ 18107M7 | 2" Full port | 2" | 81 | PA | 5 |
| ▶ 18109M9 | 3" Full port | 3" | 93 | PA | 5 |

NYLON®

*: *Compatibile con attacchi tipo Banjo®, Hypro® e Bee Valve®*
*: *Suitable for use with Banjo®, Hypro® and Bee Valve® connections*
*: *Compatible con las conexiones tipo Banjo®, Hypro® y Bee Valve®*

Tappo con attacco a morsetto*
Cap plug with clamp fitting*
Tapa con soporte abrazadera*

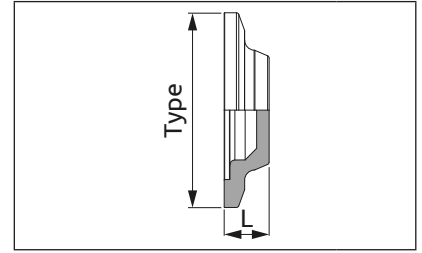
**NEW**

| COD. CODE CÓD. | Tipo Type Tipo | L mm | Mat. Mat. Mat. | |
|----------------------|----------------------|---------|----------------------|----|
| ▶ 21A010 | 1" Full port | 18 | PA | 10 |
| ▶ 21A020 | 2" Std port | 18 | PA | 10 |
| ▶ 21A030 | 2" Full port | 18 | PA | 10 |
| ▶ 21A040 | 3" Full port | 18 | PA | 5 |

NYLON®

*: *Compatibile con attacchi tipo Banjo®, Hypro® e Bee Valve®*
*: *Suitable for use with Banjo®, Hypro® and Bee Valve® connections*
*: *Compatible con las conexiones tipo Banjo®, Hypro® y Bee Valve®*

Portamanometro con attacco a morsetto*
Pressure gage box with clamp fitting*
Portamanómetro con soporte abrazadera*

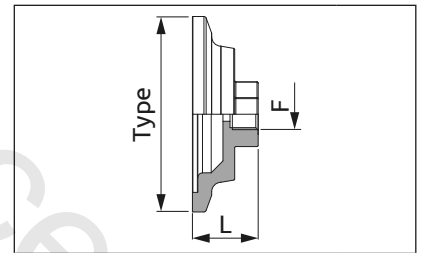
**NEW**

| COD. CODE CÓD. | Tipo Type Tipo | F | L mm | Mat. Mat. Mat. | |
|----------------------|----------------------|----------|---------|----------------------|---|
| ▶ 21A220 | 2" Std port | 1/4" | 28 | PA | 5 |
| ▶ 21A230 | 2" Full port | 1/4" | 28 | PA | 5 |
| ▶ 21A240 | 3" Full port | 1/4" | 28 | PA | 5 |
| ▶ 21A220N | 2" Std port | 1/4" NPT | 28 | PA | 5 |
| ▶ 21A230N | 2" Full port | 1/4" NPT | 28 | PA | 5 |
| ▶ 21A240N | 3" Full port | 1/4" NPT | 28 | PA | 5 |

NYLON®

*: *Compatibile con attacchi tipo Banjo®, Hypro® e Bee Valve®*
*: *Suitable for use with Banjo®, Hypro® and Bee Valve® connections*
*: *Compatible con las conexiones tipo Banjo®, Hypro® y Bee Valve®*

RACCORDI PORTAGOMMA FILETTATI HOSE THREAD FITTINGS RACORES PORTAMANGUERA ROSCADOS

Raccordo portagomma dritto filetto maschio
Straight hose fitting with male thread
Racor portamanguera recto rosca macho

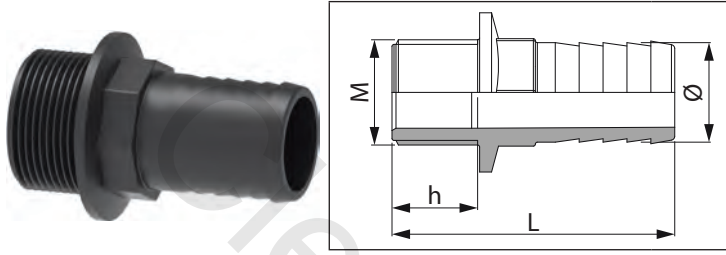

Raccordo portagomma curvo filetto maschio
90° hose fitting with male thread
Racor portamanguera curvo rosca macho

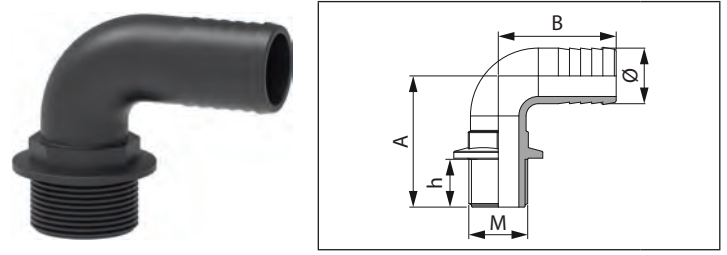

| COD. CODE CÓD. | M | Ø mm | h mm | L mm | |
|----------------------|----------|---------|---------|---------|----|
| 1032008 | G 1/4" | 8 | 13 | 48 | 25 |
| 1032010 | G 1/4" | 10 | 13 | 53 | 25 |
| 1032013 | G 1/4" | 13 | 13 | 53 | 25 |
| 1032108 | G 3/8" | 8 | 16 | 52 | 25 |
| 1032110 | G 3/8" | 10 | 16 | 57 | 25 |
| 1032113 | G 3/8" | 13 | 16 | 57 | 25 |
| 1032115 | G 3/8" | 16 | 16 | 57 | 25 |
| 1032210 | G 1/2" | 10 | 18 | 60 | 25 |
| 1032213 | G 1/2" | 13 | 18 | 60 | 25 |
| 1032215 | G 1/2" | 16 | 18 | 60 | 25 |
| 1032220 | G 1/2" | 20 | 18 | 65 | 25 |
| 1032313 | G 3/4" | 13 | 22 | 66 | 25 |
| 1032315 | G 3/4" | 16 | 22 | 66 | 25 |
| 1032320 | G 3/4" | 20 | 22 | 71 | 25 |
| 1032322 | G 3/4" | 22 | 22 | 71 | 25 |
| 1032325 | G 3/4" | 25 | 22 | 71 | 25 |
| 1032420 | G 1" | 20 | 22 | 73 | 25 |
| 1032422 | G 1" | 22 | 22 | 73 | 25 |
| 1032425 | G 1" | 25 | 22 | 73 | 25 |
| 1032430 | G 1" | 30 | 22 | 78 | 25 |
| 1032432 | G 1" | 32 | 22 | 78 | 25 |
| 1032520 | G 1 1/4" | 20 | 24 | 75 | 25 |
| 1032525 | G 1 1/4" | 25 | 24 | 75 | 25 |
| 1032530 | G 1 1/4" | 30 | 24 | 80 | 25 |
| 1032532 | G 1 1/4" | 32 | 24 | 80 | 25 |
| 1032535 | G 1 1/4" | 35 | 24 | 85 | 25 |
| 1032538 | G 1 1/4" | 38 | 24 | 85 | 25 |
| 1032540 | G 1 1/4" | 40 | 24 | 90 | 25 |
| 1032630 | G 1 1/2" | 30 | 24 | 80 | 10 |
| 1032632 | G 1 1/2" | 32 | 24 | 80 | 10 |
| 1032635 | G 1 1/2" | 35 | 24 | 85 | 10 |
| 1032638 | G 1 1/2" | 38 | 24 | 85 | 10 |
| 1032640 | G 1 1/2" | 40 | 24 | 90 | 10 |
| 1032645 | G 1 1/2" | 45 | 24 | 90 | 10 |
| 1032650 | G 1 1/2" | 50 | 24 | 95 | 10 |
| 1032750 | G 2" | 50 | 27 | 101 | 10 |
| 1032760 | G 2" | 60 | 27 | 113 | 10 |
| 1032860 | G 2 1/2" | 60 | 32 | 120 | 5 |
| 1032975 | G 3" | 75 | 35 | 139 | 5 |

| COD. CODE CÓD. | M | Ø mm | A mm | B mm | h mm | Tipo Type Tipo | |
|----------------------|----------|---------|---------|---------|---------|----------------------|----|
| 1132110 | G 3/8" | 10 | 41 | 35 | 16 | - | 25 |
| 1132113 | G 3/8" | 13 | 41 | 45 | 16 | - | 25 |
| 1132115 | G 3/8" | 16 | 41 | 48 | 16 | - | 25 |
| 1132213 | G 1/2" | 13 | 44 | 45 | 18 | - | 25 |
| 1132215 | G 1/2" | 16 | 44 | 48 | 18 | - | 25 |
| 1132220 | G 1/2" | 20 | 44 | 53 | 18 | - | 25 |
| 1132313 | G 3/4" | 13 | 50 | 45 | 22 | - | 25 |
| 1132315 | G 3/4" | 16 | 50 | 48 | 22 | - | 25 |
| 1132320 | G 3/4" | 20 | 50 | 53 | 22 | - | 25 |
| 1132325 | G 3/4" | 25 | 59 | 57 | 22 | - | 25 |
| 1132420 | G 1" | 20 | 50 | 53 | 22 | - | 25 |
| 1132425 | G 1" | 25 | 59 | 57 | 22 | - | 25 |
| 1132430 | G 1" | 30 | 60 | 60 | 22 | - | 25 |
| 1132432 | G 1" | 32 | 60 | 60 | 22 | - | 25 |
| 1132525 | G 1 1/4" | 25 | 65 | 57 | 24 | - | 25 |
| 1132530 | G 1 1/4" | 30 | 62 | 60 | 24 | - | 25 |
| 1132532 | G 1 1/4" | 32 | 62 | 60 | 24 | - | 25 |
| 1132535 | G 1 1/4" | 35 | 70 | 80 | 24 | - | 10 |
| 1132538 | G 1 1/4" | 38 | 70 | 85 | 24 | - | 10 |
| 1132540 | G 1 1/4" | 40 | 70 | 85 | 24 | - | 10 |
| 1132630 | G 1 1/2" | 30 | 62 | 60 | 24 | - | 10 |
| 1132632 | G 1 1/2" | 32 | 62 | 60 | 24 | - | 10 |
| 1132635 | G 1 1/2" | 35 | 70 | 80 | 24 | - | 10 |
| 1132638 | G 1 1/2" | 38 | 70 | 85 | 24 | - | 10 |
| 1132640 | G 1 1/2" | 40 | 70 | 85 | 24 | - | 10 |
| 1132750 | G 2" | 50 | 88 | 89 | 27 | - | 10 |
| 1132752 | G 2" | 52 | 88 | 89 | 27 | - | 10 |
| 1132960 | G 3" | 60 | 125 | 120 | 35 | - | 5 |
| 1132975 | G 3" | 75 | 125 | 125 | 35 | - | 5 |
| 113213L | G 1/2" | 13 | 50 | 45 | 27 | Bulkhead | 25 |
| 113215L | G 1/2" | 16 | 50 | 48 | 27 | Bulkhead | 25 |
| 113220L | G 1/2" | 20 | 50 | 53 | 27 | Bulkhead | 25 |

RACCORDI PORTAGOMMA FILETTATI

HOSE THREAD FITTINGS

RACORES PORTAMANGUERA ROSCADOS

Raccordo portagomma curvo 45° filetto maschio
45° hose fitting with male thread
Racor portamanguera curvo 45° rosca macho

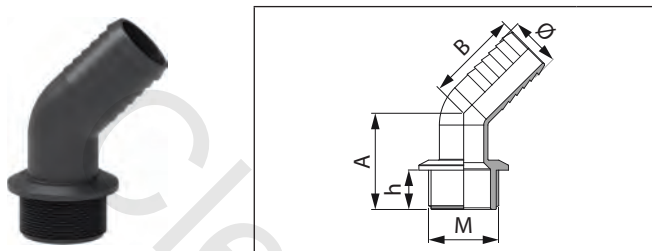

| COD. CODE CÓD. | M | Ø mm | A mm | B mm | h mm | |
|----------------------|----------|---------|---------|---------|---------|----|
| 114530 | G 1 1/4" | 30 | 58 | 55 | 24 | 10 |
| 114535 | G 1 1/4" | 35 | 58 | 55 | 24 | 10 |
| 114540 | G 1 1/4" | 40 | 58 | 60 | 24 | 10 |
| 114630 | G 1 1/2" | 30 | 59 | 55 | 24 | 10 |
| 114635 | G 1 1/2" | 35 | 59 | 55 | 24 | 10 |
| 114640 | G 1 1/2" | 40 | 59 | 60 | 24 | 10 |

Raccordo portagomma 45° filetto femmina
45° hose fitting with female thread
Racor portamanguera 45° con rosca hembra

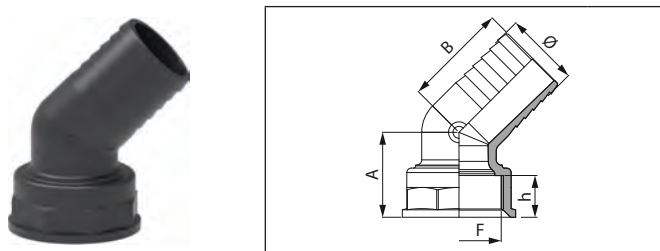

| COD. CODE CÓD. | F | Ø mm | A mm | B mm | h mm | |
|----------------------|------|---------|---------|---------|---------|----|
| 111750 | G 2" | 50 | 57 | 70 | 28 | 10 |

Raccordo portagomma curvo filetto femmina
90° hose fitting with female thread
Racor portamanguera curvo rosca hembra

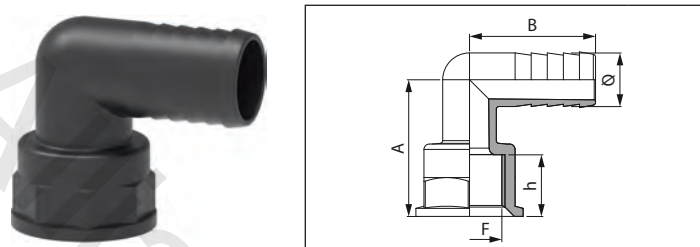

| COD. CODE CÓD. | F | Ø mm | A mm | B mm | h mm | |
|----------------------|--------|---------|---------|---------|---------|----|
| 1102320 | G 3/4" | 20 | 51 | 47 | 23 | 25 |
| 110322 | G 3/4" | 22 | 58 | 53 | 23 | 25 |
| 1102325 | G 3/4" | 25 | 51 | 50 | 23 | 25 |
| 110330 | G 3/4" | 30 | 53 | 57 | 26 | 25 |
| 1102430 | G 1" | 30 | 51 | 55 | 23 | 25 |
| 1102432 | G 1" | 32 | 51 | 55 | 23 | 25 |

Raccordo portagomma dritto filetto femmina
Straight hose fitting with female thread
Racor portamanguera recto rosca hembra

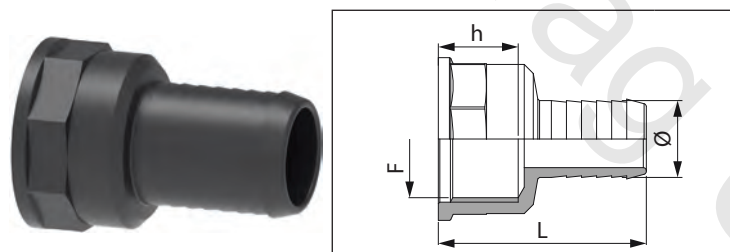

| COD. CODE CÓD. | F | Ø mm | h mm | L mm | Mat. Mat. Mat. | |
|----------------------|----------|---------|---------|---------|----------------------|----|
| 100215 | G 1/2" | 16 | 15 | 51 | PA | 25 |
| 100219 | G 1/2" | 19 | 15 | 55 | PA | 25 |
| 100519 | G 1 1/4" | 19 | 28 | 69 | - | 25 |
| 100521 | G 1 1/4" | 21 | 28 | 69 | - | 25 |
| 100525 | G 1 1/4" | 25 | 28 | 69 | - | 25 |
| 100530 | G 1 1/4" | 30 | 28 | 78 | - | 25 |
| 100533 | G 1 1/4" | 32 | 28 | 78 | - | 25 |
| 100535 | G 1 1/4" | 35 | 28 | 78 | - | 25 |
| 100540 | G 1 1/4" | 40 | 28 | 78 | - | 25 |
| 100635 | G 1 1/2" | 35 | 19 | 67 | - | 10 |
| 100640 | G 1 1/2" | 40 | 19 | 67 | - | 10 |
| 100645 | G 1 1/2" | 45 | 19 | 63 | - | 10 |
| 100650 | G 1 1/2" | 50 | 19 | 61 | - | 10 |
| 100745 | G 2" | 45 | 21 | 70 | - | 10 |
| 100750 | G 2" | 50 | 21 | 70 | - | 10 |
| 100760 | G 2" | 60 | 21 | 75 | - | 10 |

RACCORDI PORTAGOMMA PER GIRELLO HOSE FITTINGS FOR FLY NUT RACOR PORTAMANGUERA PARA TUERCA

Raccordo portagomma dritto per girello
Straight hose fittings for fly nut
Racor portamanguera recto para tuerca

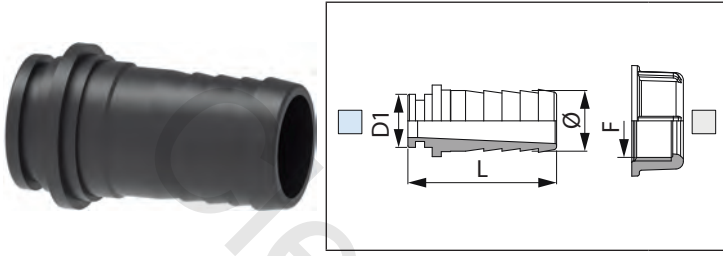

| COD. CODE CÔD. | Ø mm | D1 mm | L mm | | COD. EPDM | COD. CODE CÔD. | F |
|----------------|------|-------|------|----|-----------|----------------|----------|
| 106210 | 10 | 13.7 | 43 | 25 | G11060 | 2002020 | G 1/2" |
| 106213 | 13 | 13.7 | 43 | 25 | G11060 | 2002020 | G 1/2" |
| 106313 | 13 | 17.5 | 44 | 25 | G10031 | 2002030 | G 3/4" |
| 106315 | 16 | 17.5 | 44 | 25 | G10031 | 2002030 | G 3/4" |
| 106320 | 20 | 17.5 | 49 | 25 | G10031 | 2002030 | G 3/4" |
| 106410 | 10 | 24.5 | 47 | 25 | G10041 | 2002040 | G 1" |
| 106413 | 13 | 24.5 | 47 | 25 | G10041 | 2002040 | G 1" |
| 106415 | 16 | 24.5 | 47 | 25 | G10041 | 2002040 | G 1" |
| 106420 | 20 | 24.5 | 52 | 25 | G10041 | 2002040 | G 1" |
| 106422 | 22 | 24.5 | 52 | 25 | G10041 | 2002040 | G 1" |
| 106425 | 25 | 24.5 | 52 | 25 | G10041 | 2002040 | G 1" |
| 106522 | 22 | 31.5 | 53 | 25 | G10051 | 2002050 | G 1 1/4" |
| 106525 | 25 | 31.5 | 53 | 25 | G10051 | 2002050 | G 1 1/4" |
| 106530 | 30 | 31.5 | 58 | 25 | G10051 | 2002050 | G 1 1/4" |
| 106533 | 32 | 31.5 | 58 | 25 | G10051 | 2002050 | G 1 1/4" |
| 106625 | 25 | 37.5 | 55 | 25 | G10061 | 2002060 | G 1 1/2" |
| 106630 | 30 | 37.5 | 60 | 25 | G10061 | 2002060 | G 1 1/2" |
| 106633 | 32 | 37.5 | 60 | 25 | G10061 | 2002060 | G 1 1/2" |
| 106635 | 35 | 37.5 | 62 | 25 | G10061 | 2002060 | G 1 1/2" |
| 106638 | 38 | 37.5 | 68 | 25 | G10061 | 2002060 | G 1 1/2" |
| 106640 | 40 | 37.5 | 68 | 25 | G10061 | 2002060 | G 1 1/2" |
| 106740 | 40 | 47 | 74 | 10 | G10071 x2 | 2002070 | G 2" |
| 106745 | 45 | 47 | 76 | 10 | G10071 x2 | 2002070 | G 2" |
| 106750 | 50 | 47 | 81 | 10 | G10071 x2 | 2002070 | G 2" |
| 106752 | 52 | 47 | 81 | 10 | G10071 x2 | 2002070 | G 2" |
| 106860 | 60 | 63 | 98 | 5 | G10081 x2 | 2002080 | G 2 1/2" |
| 106960 | 60 | 75 | 105 | 5 | G10091 x2 | 2002090 | G 3" |
| 106975 | 75 | 75 | 115 | 5 | G10091 x2 | 2002090 | G 3" |

Raccordo portagomma curvo per girello
Angled hose fittings for fly nut
Racor portamanguera curvo para tuerca

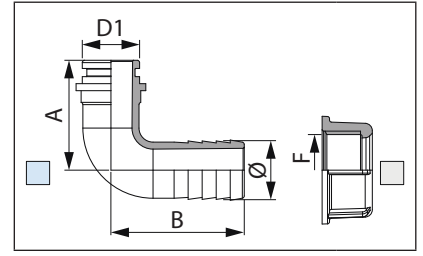

| COD. CODE CÔD. | Ø mm | A mm | B mm | D1 mm | | COD. EPDM | COD. CODE CÔD. | F |
|----------------|------|------|------|-------|----|-----------|----------------|----------|
| 116210 | 10 | 35 | 33 | 13.7 | 25 | G11060 | 2002020 | G 1/2" |
| 116313 | 13 | 40 | 36 | 17.5 | 25 | G10031 | 2002030 | G 3/4" |
| 116315 | 16 | 37 | 45 | 17.5 | 25 | G10031 | 2002030 | G 3/4" |
| 116317 | 17 | 37 | 39 | 17.5 | 25 | G10031 | 2002030 | G 3/4" |
| 116320 | 20 | 39 | 45 | 17.5 | 25 | G10031 | 2002030 | G 3/4" |
| 116415 | 15 | 37 | 45 | 24.5 | 25 | G10041 | 2002040 | G 1" |
| 116420 | 20 | 37 | 45 | 24.5 | 25 | G10041 | 2002040 | G 1" |
| 116425 | 25 | 47 | 57 | 24.5 | 25 | G10041 | 2002040 | G 1" |
| 116522 | 22 | 51 | 53 | 31.5 | 25 | G10051 | 2002050 | G 1 1/4" |
| 116525 | 25 | 51 | 57 | 31.5 | 25 | G10051 | 2002050 | G 1 1/4" |
| 116530 | 30 | 54 | 60 | 31.5 | 25 | G10051 | 2002050 | G 1 1/4" |
| 116533 | 32 | 54 | 60 | 31.5 | 25 | G10051 | 2002050 | G 1 1/4" |
| 116625 | 25 | 56 | 57 | 37.5 | 25 | G10061 | 2002060 | G 1 1/2" |
| 116630 | 30 | 54 | 60 | 37.5 | 25 | G10061 | 2002060 | G 1 1/2" |
| 116633 | 32 | 54 | 60 | 37.5 | 25 | G10061 | 2002060 | G 1 1/2" |
| 116635 | 35 | 65 | 80 | 37.5 | 25 | G10061 | 2002060 | G 1 1/2" |
| 116638 | 38 | 65 | 85 | 37.5 | 25 | G10061 | 2002060 | G 1 1/2" |
| 116640 | 40 | 65 | 85 | 37.5 | 25 | G10061 | 2002060 | G 1 1/2" |
| 116740 | 40 | 65 | 85 | 47 | 10 | G10071 x2 | 2002070 | G 2" |
| 116745 | 45 | 71 | 85 | 47 | 10 | G10071 x2 | 2002070 | G 2" |
| 116750 | 50 | 75 | 92 | 47 | 10 | G10071 x2 | 2002070 | G 2" |
| 116752 | 52 | 75 | 92 | 47 | 10 | G10071 x2 | 2002070 | G 2" |
| 116860 | 60 | 94 | 120 | 63 | 5 | G10081 x2 | 2002080 | G 2 1/2" |
| 116960 | 60 | 108 | 120 | 75 | 5 | G10091 x2 | 2002090 | G 3" |
| 116975 | 75 | 108 | 125 | 75 | 5 | G10091 x2 | 2002090 | G 3" |

RACCORDI PORTAGOMMA PER GIRELLO HOSE FITTINGS FOR FLY NUT RACOR PORTAMANGUERA PARA TUERCA

Raccordo portagomma curvo a 45° per girello
45° angled hose fittings for fly nut
Racor portamanguera curva a 45° para tuerca

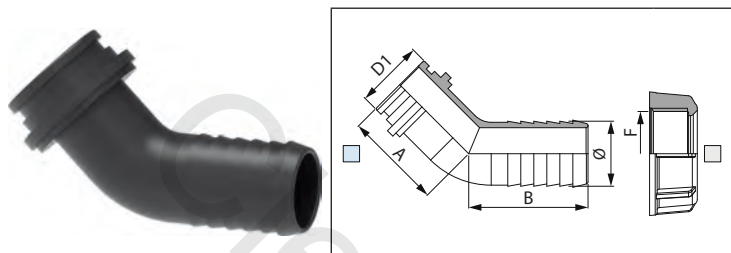

| COD. CODE Cód. | Ø mm | A mm | B mm | D1 mm | Mat. Mat. Mat. | 25 | O-ring | | F |
|----------------|------|------|------|-------|----------------|----|-----------|----------------|----------|
| | | | | | | | COD. EPDM | COD. CODE Cód. | |
| 117213 | 13 | 27 | 24 | 13.7 | PA | 25 | G11060 | 2002020 | G 1/2" |
| 117530 | 30 | 45 | 55 | 31.5 | - | 10 | G10051 | 2002050 | G 1/4" |
| 117532 | 32 | 45 | 55 | 31.5 | - | 10 | G10051 | 2002050 | G 1/4" |
| 117630 | 30 | 47 | 55 | 37.5 | - | 10 | G10061 | 2002060 | G 1 1/2" |
| 117632 | 32 | 47 | 55 | 37.5 | - | 10 | G10061 | 2002060 | G 1 1/2" |
| 117635 | 35 | 47 | 55 | 37.5 | - | 10 | G10061 | 2002060 | G 1 1/2" |
| 117640 | 40 | 47 | 60 | 37.5 | - | 10 | G10061 | 2002060 | G 1 1/2" |
| 117745 | 45 | 47 | 65 | 47 | - | 10 | G10071 x2 | 2002070 | G 2" |
| 117750 | 50 | 47 | 68 | 47 | - | 10 | G10071 x2 | 2002070 | G 2" |

Raccordo portagomma dritto con sede piana per girello
Flat seat straight hose tail for fly nut
Racor portamanguera recta con asiento plano para tuerca

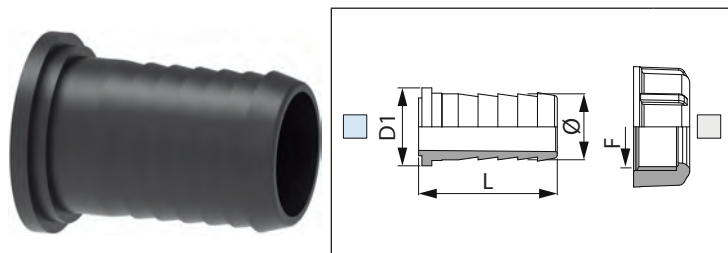

| COD. CODE Cód. | Ø mm | D1 mm | L mm | Mat. Mat. Mat. | 25 | Gasket | | F |
|----------------|------|-------|------|----------------|----|-----------|----------------|----------|
| | | | | | | COD. EPDM | COD. CODE Cód. | |
| 105108 | 8 | 15 | 31 | PA | 25 | G424190 | 200010 | G 3/8" |
| 105110 | 10 | 15 | 36 | - | 25 | G424190 | 200010 | G 3/8" |
| 105210 | 10 | 18 | 36 | - | 25 | G40012 | 2002020 | G 1/2" |
| 105213 | 13 | 18 | 36 | - | 25 | G40012 | 2002020 | G 1/2" |
| 105313 | 13 | 24 | 36 | - | 25 | G40013 | 2002030 | G 3/4" |
| 105315 | 16 | 24 | 36 | - | 25 | G40013 | 2002030 | G 3/4" |
| 105320 | 20 | 24 | 41 | - | 25 | G40013 | 2002030 | G 3/4" |
| 105420 | 20 | 30 | 42 | - | 25 | G40014 | 2002040 | G 1" |
| 105425 | 25 | 30 | 42 | - | 25 | G40014 | 2002040 | G 1" |
| 105530 | 30 | 38.5 | 52 | - | 25 | G40015 | 2002050 | G 1 1/4" |
| 105640 | 40 | 44.5 | 56 | - | 10 | G40004 | 2002060 | G 1 1/2" |

Giunto filettato maschio per girello
Coupling with male thread for fly nut
Racor roscada macho para tuerca

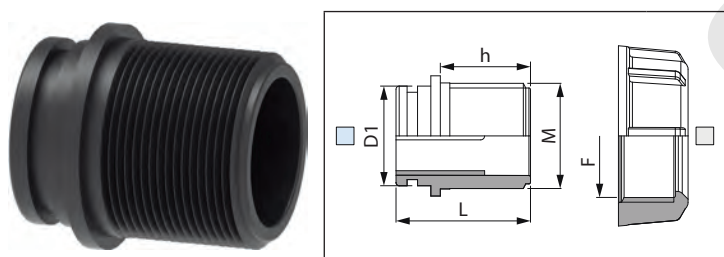

| COD. CODE Cód. | M | D1 mm | h mm | L mm | 25 | O-ring | | F |
|----------------|----------|-------|------|------|----|-----------|----------------|----------|
| | | | | | | COD. EPDM | COD. CODE Cód. | |
| 265031 | G 3/8" | - | 15 | 22 | 25 | G40013* | 2002030 | G 3/4" |
| 265054 | G 1" | 31.5 | 28.5 | 43 | 25 | G10051 | 2002050 | G 1 1/4" |
| 265065 | G 1 1/4" | 37.5 | 37 | 52 | 25 | G10061 | 2002060 | G 1 1/2" |
| 265076 | G 1 1/2" | 47 | 39.5 | 61 | 25 | G10071 x2 | 2002070 | G 2" |

* con sede piana.
* with flat seat.
* con asiento plano.

Raccordo portagomma curvo con sede piana per girello
90° hose tail flat seat for fly nut
Racor portamanguera curva con asiento plano para tuerca

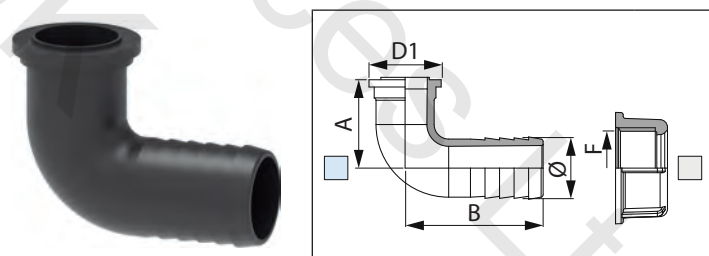

| COD. CODE Cód. | Ø mm | A mm | B mm | D1 mm | 25 | Gasket | | F |
|----------------|------|------|------|-------|----|-----------|----------------|----------|
| | | | | | | COD. EPDM | COD. CODE Cód. | |
| 115210 | 10 | 29 | 33 | 18 | 25 | G40012 | 2002020 | G 1/2" |
| 115313 | 13 | 32 | 36 | 24 | 25 | G40013 | 2002030 | G 3/4" |
| 115315 | 16 | 29 | 45 | 24 | 25 | G40013 | 2002030 | G 3/4" |
| 115320 | 20 | 31 | 45 | 24 | 25 | G40013 | 2002030 | G 3/4" |
| 115425 | 25 | 37 | 57 | 30 | 25 | G40014 | 2002040 | G 1" |
| 115530 | 30 | 45 | 60 | 38.5 | 25 | G40015 | 2002050 | G 1 1/4" |
| 115640 | 40 | 53 | 85 | 44.5 | 10 | G40004 | 2002060 | G 1 1/2" |

RACCORDI PORTAGOMMA PER GIRELLO HOSE FITTINGS FOR FLY NUT RACOR PORTAMANGUERA PARA TUERCA

Raccordi passaparete tutto un pezzo dritto con ghiera
One-piece bulkhead hose tail with lock ring
Racor pasapared de una sola pieza recto con Tuerca

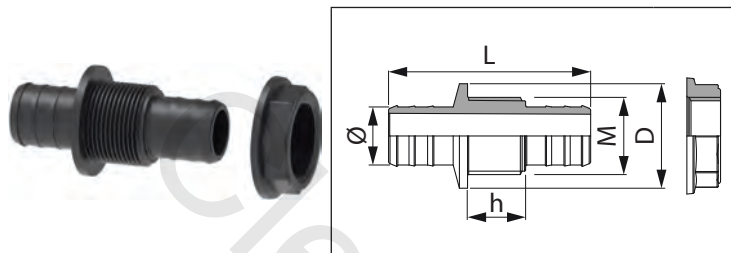

| COD. CODE CÓD. | M | Ø mm | D mm | h mm | L mm | |
|----------------------|------|---------|---------|---------|---------|----|
| 108425 | G 1" | 25 | 45 | 25 | 58 | 25 |

Raccordi passaparete tutto un pezzo curvo con ghiera
90° one-piece bulkhead hose tail with lock ring
Racor pasapared de una sola pieza curvo con Tuerca

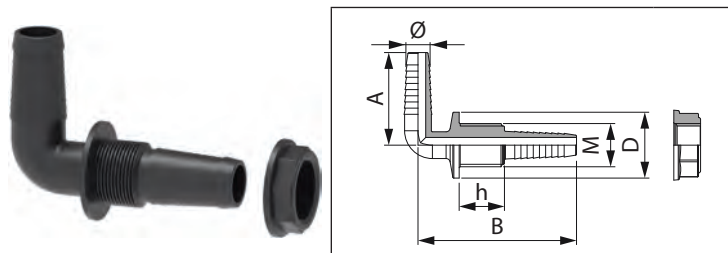

| COD. CODE CÓD. | M | Ø mm | A mm | B mm | D mm | h mm | |
|----------------------|--------|---------|---------|---------|---------|---------|----|
| 118213 | G 1/2" | 11÷13 | 45 | 77 | 32 | 22 | 25 |
| 118215 | G 1/2" | 15÷17 | 49 | 84 | 32 | 22 | 25 |
| 118319 | G 3/4" | 20÷22 | 69 | 107 | 40 | 23 | 25 |
| 118426 | G 1" | 26÷29 | 69 | 107 | 50 | 23 | 25 |



RACCORDI FILETTATI THREAD FITTINGS RACORES CON ROSCA

Raccordo filettato curvo 90° femmina/femmina
90° female/female fittings
Racor curvo 90° hembra/hembra

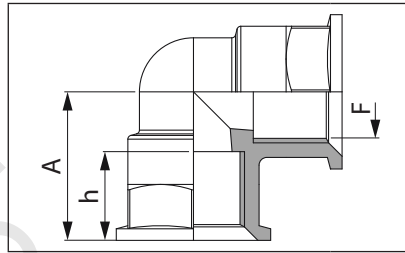

O-ring
COD. EPDM

| COD. CODE CÔD. | F | A mm | h mm | | COD. EPDM |
|----------------|----------|------|------|----|-----------|
| 1202022 | G 1/2" | 34 | 21 | 25 | G10041 |
| 1202033 | G 3/4" | 39 | 23 | 25 | G11058 |
| 1202044 | G 1" | 43 | 23 | 25 | G11059 |
| 1202055 | G 1 1/4" | 50 | 25 | 10 | G10052 |
| 1202066 | G 1 1/2" | 53 | 25 | 10 | G10062 |
| 1202077 | G 2" | 63 | 28 | 10 | G10073 |
| 1202099 | G 3" | 85 | 36 | 5 | G10092 |

Raccordo filettato curvo 90° maschio/maschio
90° male/male fittings
Racor curvo 90° macho/macho

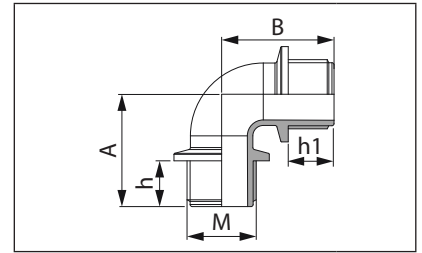

| COD. CODE CÔD. | M | A mm | B mm | h mm | h1 mm | |
|----------------|----------|------|------|------|-------|----|
| 123044 | G 1" | 54 | 54 | 22 | 22 | 25 |
| 123055 | G 1 1/4" | 64 | 67 | 23 | 23 | 10 |
| 123255 | G 1 1/4" | 55 | 80 | 23 | 41 | 10 |
| 1232077 | G 2" | 88 | 89 | 27 | 27 | 10 |

Raccordo filettato curvo 90° maschio/femmina
90° male/female fittings
Racor curvo macho/hembra

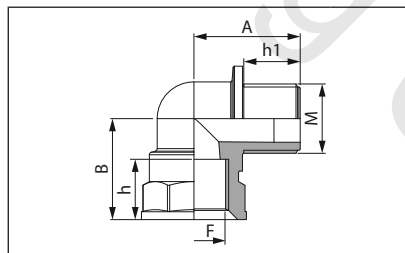

O-ring
COD. EPDM

| COD. CODE CÔD. | F* | M* | A mm | B mm | h mm | h1 mm | | COD. EPDM |
|----------------|----------|----------|------|------|------|-------|----|-----------|
| 1262022 | G 1/2" | G 1/2" | 34 | 35 | 21 | 18 | 25 | G10041 |
| 1262033 | G 3/4" | G 3/4" | 39 | 41 | 23 | 22 | 25 | G11058 |
| 1262044 | G 1" | G 1" | 43 | 47 | 23 | 22 | 25 | G11059 |
| 1262055 | G 1 1/4" | G 1 1/4" | 50 | 53 | 25 | 24 | 10 | G10052 |
| 1262066 | G 1 1/2" | G 1 1/2" | 53 | 57 | 25 | 24 | 10 | G10062 |
| 1262077 | G 2" | G 2" | 63 | 66 | 28 | 27 | 10 | G10073 |

* A richiesta filettature NPT
* NPT threads on request
* Bajo pedido roscas NPT

Raccordo 45° filettato femmina/maschio
Female/Male 45° threaded fitting
Racor 45° con rosca hembra/macho

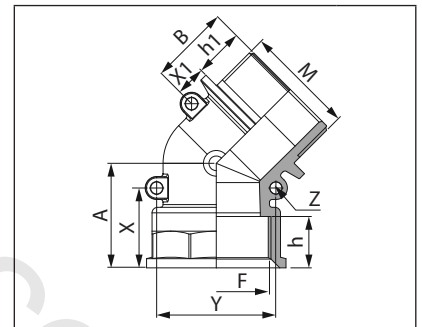

O-ring
COD. EPDM

| COD. CODE CÔD. | F | M | A mm | B mm | h mm | h1 mm | X mm | X1 mm | Y mm | Z mm | | COD. EPDM |
|----------------|------|------|------|------|------|-------|------|-------|------|------|----|-----------|
| 127077 | G 2" | G 2" | 57 | 57 | 28 | 27 | 43.5 | 16.5 | 65 | M6 | 10 | G10073 |

Raccordo filettato a "T" maschio
 Male Tees fittings
 Rácor en "T" macho

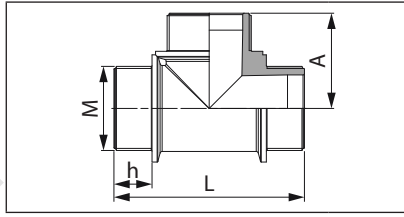

| COD. CODE CÓD. | M | A mm | h mm | L mm | |
|----------------------|----------|---------|---------|---------|----|
| 1312050 | G 1 1/4" | 54 | 24 | 108 | 10 |
| 1312060 | G 1 1/2" | 58 | 24 | 115 | 10 |
| 1312070 | G 2" | 68 | 27 | 135 | 10 |

Raccordo filettato a "T" maschio/femmina
 Male/female Tees
 Rácor en "T" macho/hembra

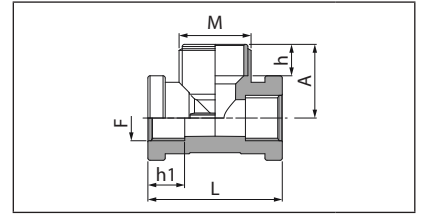

| COD. CODE CÓD. | F | M | A mm | h mm | h1 mm | L mm | |
|----------------------|--------|------|---------|---------|----------|---------|----|
| 133024 | G 1/2" | G 1" | 35 | 16 | 17 | 60 | 25 |
| 133034 | G 3/4" | G 1" | 35 | 16 | 17 | 60 | 25 |

Raccordo filettato a "T" femmina
 Female Tees fittings
 Rácor en "T" hembra

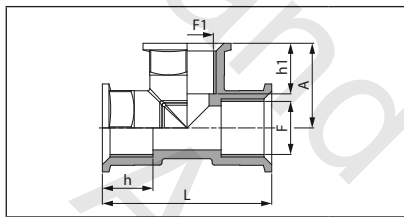

| COD. CODE CÓD. | F | F1 | A mm | h mm | h1 mm | L mm | | O-ring | COD. EPDM |
|----------------------|----------|----------|---------|---------|----------|---------|----|------------|-----------------|
| 1302020 | G 1/2" | G 1/2" | 34 | 21 | 21 | 67 | 25 | | G10041 |
| 1302032 | G 1/2" | G 3/4" | 39 | 23 | 21 | 67 | 25 | | G10041 + G11058 |
| 1302030 | G 3/4" | G 3/4" | 39 | 23 | 23 | 77 | 25 | | G11058 |
| 1302023 | G 3/4" | G 1/2" | 39 | 21 | 23 | 77 | 25 | | G10041 + G11058 |
| 1302040 | G 1" | G 1" | 43 | 23 | 23 | 85 | 10 | | G11059 |
| 1302050 | G 1 1/4" | G 1 1/4" | 50 | 25 | 25 | 100 | 10 | | G10052 |
| 1302060 | G 1 1/2" | G 1 1/2" | 53 | 25 | 25 | 105 | 10 | | G10062 |
| 1302070 | G 2" | G 2" | 63 | 28 | 28 | 125 | 10 | | G10073 |

Raccordi a "T" con asole di fissaggio, femmina
 T-shape unions with fastening eyelets, female
 Rácores en "T" con ranuras de fijación, hembra

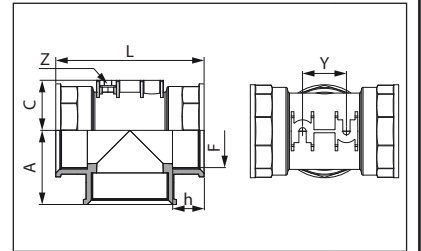

| COD. CODE CÓD. | F | A mm | C mm | h mm | L mm | Y mm | Z mm | | O-ring | COD. EPDM |
|----------------------|------|---------|---------|---------|---------|---------|---------|---|------------|--------------|
| 1302090 | G 3" | 85 | 57 | 36 | 169 | 50 | M8 | 5 | | G10092 |

Raccordi a "T" con asole di fissaggio, femmina/maschio
 Union "Tees" with fastening slots, female/male
 Rácores en "T" con ranuras de fijación, hembra / macho

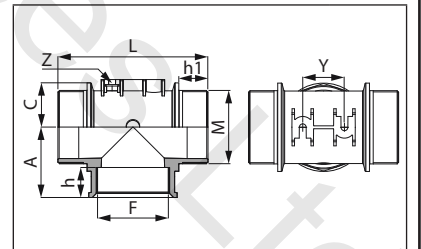

| COD. CODE CÓD. | F | M | A mm | C mm | h mm | h1 mm | L mm | Y mm | Z mm | O-ring | COD. EPDM |
|----------------------|------|------|---------|---------|---------|----------|---------|---------|---------|------------|--------------|
| 1322090 | G 3" | G 3" | 85 | 57 | 36 | 35 | 180 | 50 | M8 | | G10092 |

Raccordo filettato a "T" femmina/maschio
 Female/male Tees fittings
 Rácor en "T" hembra/macho

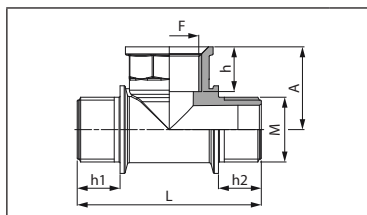

| COD. CODE CÓD. | F | M | A mm | h mm | h1 mm | h2 mm | L mm | |
|----------------------|----------|----------|---------|---------|----------|----------|---------|----|
| 1322040 | G 1" | G 1" | 42 | 23 | 22 | 22 | 98 | 25 |
| 132050 | G 1 1/4" | G 1 1/4" | 59 | 18 | 16 | 31 | 126 | 10 |
| 1322070 | G 2" | G 2" | 68 | 28 | 27 | 27 | 135 | 10 |



Schema di montaggio raccordi con tenuta tramite OR

Assembly diagram for fittings with OR seal

Esquema de montaje racores con asiento de sellado mediante OR

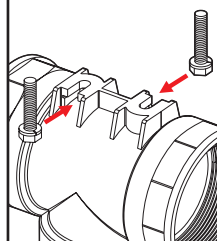
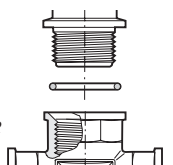

Il raccordo può essere fissato ad una superficie, mediante due viti a testa esagonale da inserire nelle asole poste sulla parte superiore del raccordo.

The union is fastened to a surface with two hexagonal-head screws inserted into slots on the upper part of the union.

El racor puede ser fijado a una superficie por medio de dos tornillos de cabeza hexagonal para introducir en las ranuras colocadas en la parte superior del racor.

RACCORDI FILETTATI THREAD FITTINGS RACORES CON ROSCA

Raccordo filettato a 4 vie 45° maschio
45°, four-way male fitting
Rácor de cuatro vías a 45° macho

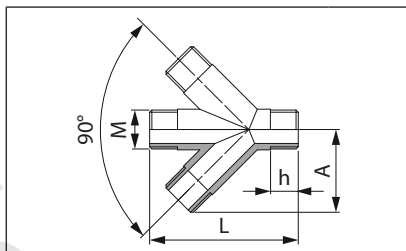

| COD. CODE CÓD. | M | A mm | h mm | L mm | |
|----------------------|--------|---------|---------|---------|----|
| 160020 | G 1/2" | 45 | 15 | 80 | 25 |

Raccordo filettato a 4 vie 90° maschio
90°, four-way male fitting
Rácor de cuatro vías a 90° macho

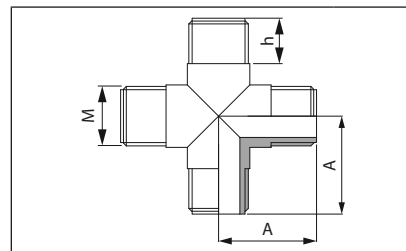

| COD. CODE CÓD. | M | A mm | h mm | |
|----------------------|--------|---------|---------|----|
| 150020 | G 1/2" | 35 | 16 | 25 |

Raccordo filettato a 4 vie 45° maschio/femmina
45°, four-way male/female fitting
Rácor de cuatro vías a 45° macho/hembra

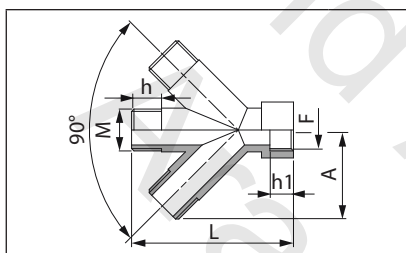

| COD. CODE CÓD. | F | M | A mm | h mm | h1 mm | L mm | |
|----------------------|--------|--------|---------|---------|----------|---------|----|
| 160120 | G 1/2" | G 1/2" | 45 | 15 | 13 | 81 | 25 |

Raccordo filettato a 4 vie 90° maschio/femmina
90°, four-way male/female fitting
Rácor de cuatro vías a 90° macho/hembra

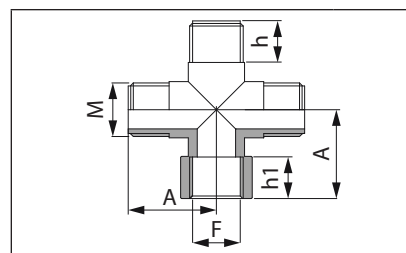

| COD. CODE CÓD. | F | M | A mm | h mm | h1 mm | |
|----------------------|--------|--------|---------|---------|----------|----|
| 150120 | G 1/2" | G 1/2" | 34 | 16 | 15 | 25 |

Raccordi a "Y"
"Y" fitting
Rácor en "Y"

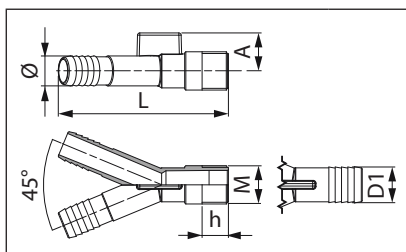

| COD. CODE CÓD. | M | Ø mm | A mm | D1 mm | h mm | L mm | |
|----------------------|------|---------|---------|----------|---------|---------|----|
| 140001 | G 1" | 25 | 33 | - | 21 | 148 | 10 |
| 140002 | - | 25 | 33 | 25 | - | 148 | 10 |
| 140003 | - | 25 | 33 | 30 | - | 148 | 10 |

Raccordo collettore a 3-6 vie
3-6 way fitting
Colector roscado de 3-6 vías

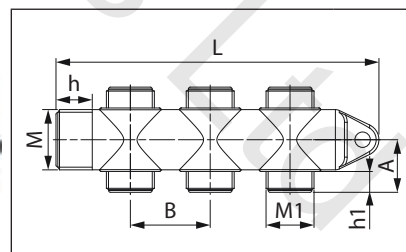

| COD. CODE CÓD. | Tipo Type Tipo | M | M1 | A mm | B mm | h mm | h1 mm | L mm | Mat. Mat. Mat. | |
|----------------------|----------------------|------|--------|---------|---------|---------|----------|---------|----------------------|----|
| 152343 | 3 vie/ways | G 1" | G 3/4" | 24 | 44 | 19 | 11 | 178 | PA | 10 |
| 152643 | 6 vie/ways | G 1" | G 3/4" | 29 | 44 | 19 | 11 | 178 | PA | 10 |

NYLON®

Niplo simmetrico e passaparete
 Symmetrical and bulkhead nipple
 Unión simétrico y pasapared

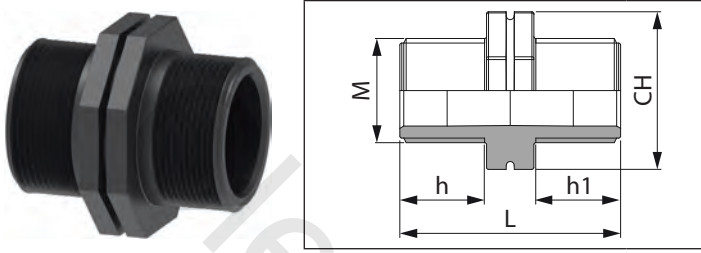

| COD. CODE CÓD. | Tipo Type Tipo | M | h mm | h1 mm | L mm | CH mm | |
|----------------------|----------------------|----------|---------|----------|---------|----------|----|
| 2502020 | Symmetrical | G 1/2" | 18 | 18 | 48 | 32 | 25 |
| 2502030 | Symmetrical | G 3/4" | 22 | 22 | 56 | 40 | 25 |
| 2502040 | Symmetrical | G 1" | 22 | 22 | 56 | 45 | 25 |
| 2502050 | Symmetrical | G 1 1/4" | 24 | 24 | 62 | 56 | 25 |
| 2502060 | Symmetrical | G 1 1/2" | 24 | 24 | 62 | 62 | 10 |
| 2502070 | Symmetrical | G 2" | 27 | 27 | 68 | 76 | 10 |
| 2502080 | Symmetrical | G 2 1/2" | 32 | 32 | 78 | 92 | 10 |
| 2502090 | Symmetrical | G 3" | 35 | 35 | 84 | 106 | 5 |
| 2502021 | Bulkhead | G 1/2" | 38 | 18 | 68 | 32 | 25 |
| 2502031 | Bulkhead | G 3/4" | 40 | 22 | 74 | 40 | 25 |
| 2502041 | Bulkhead | G 1" | 45 | 22 | 79 | 45 | 25 |
| 2502051 | Bulkhead | G 1 1/4" | 54 | 24 | 88 | 56 | 25 |
| 2502061 | Bulkhead | G 1 1/2" | 50 | 24 | 88 | 62 | 10 |
| 2502071 | Bulkhead | G 2" | 50 | 27 | 91 | 76 | 10 |
| 2502081 | Bulkhead | G 2 1/2" | 65 | 32 | 111 | 92 | 10 |
| 2502091 | Bulkhead | G 3" | 73 | 35 | 122 | 106 | 5 |

Riduzione maschio/maschio
 Male/male reducer nipple
 Reduccion Macho / Macho

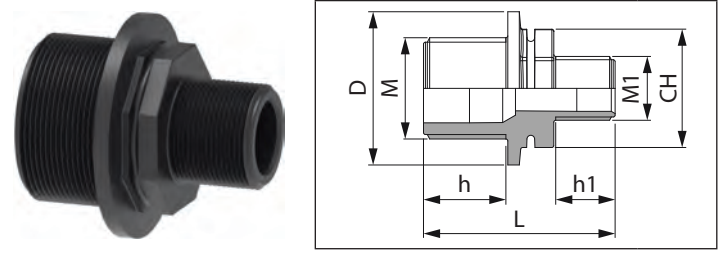

| COD. CODE CÓD. | M | M1 | D mm | h mm | h1 mm | L mm | CH mm | |
|----------------------|----------|----------|---------|---------|----------|---------|----------|----|
| 2402020 | G 1/2" | G 1/4" | 32 | 18 | 13 | 43 | 21 | 25 |
| 2402021 | G 1/2" | G 3/8" | 32 | 18 | 16 | 46 | 27 | 25 |
| 2402031 | G 3/4" | G 3/8" | 40 | 22 | 16 | 50 | 27 | 25 |
| 2402032 | G 3/4" | G 1/2" | 40 | 22 | 18 | 52 | 32 | 25 |
| 2402042 | G 1" | G 1/2" | 45 | 22 | 18 | 52 | 32 | 25 |
| 2402043 | G 1" | G 3/4" | 45 | 22 | 22 | 56 | 40 | 25 |
| 2402053 | G 1 1/4" | G 3/4" | 56 | 24 | 22 | 60 | 40 | 25 |
| 2402054 | G 1 1/4" | G 1" | 56 | 24 | 22 | 60 | 45 | 25 |
| 2402064 | G 1 1/2" | G 1" | 62 | 24 | 22 | 60 | 45 | 10 |
| 2402065 | G 1 1/2" | G 1 1/4" | 62 | 24 | 24 | 62 | 56 | 10 |
| 2402075 | G 2" | G 1 1/4" | 76 | 27 | 24 | 65 | 56 | 10 |
| 2402076 | G 2" | G 1 1/2" | 76 | 27 | 24 | 65 | 62 | 10 |
| 2402087 | G 2 1/2" | G 2" | 93 | 32 | 27 | 73 | 76 | 10 |
| 2402097 | G 3" | G 2" | 106 | 35 | 27 | 76 | 76 | 10 |
| 2402098 | G 3" | G 2 1/2" | 106 | 35 | 32 | 81 | 93 | 10 |

Manicotto
 Threaded coupling
 Manguito

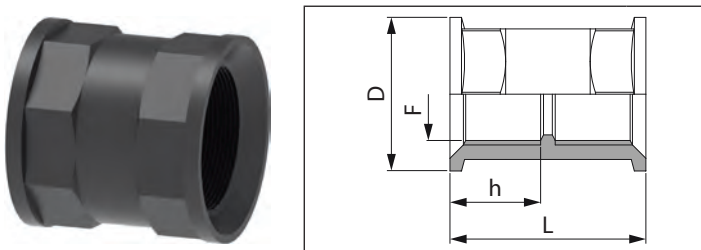

| COD. CODE CÓD. | F | D mm | h mm | L mm | |
|----------------------|----------|---------|---------|---------|----|
| 2302010 | G 3/8" | 27 | 17 | 38 | 25 |
| 2302020 | G 1/2" | 32 | 19 | 43 | 25 |
| 2302030 | G 3/4" | 40 | 23 | 51 | 25 |
| 2302040 | G 1" | 45 | 23 | 51 | 25 |
| 2302050 | G 1 1/4" | 56 | 25 | 55 | 25 |
| 2302060 | G 1 1/2" | 62 | 25 | 55 | 10 |
| 2302070 | G 2" | 76 | 28 | 61 | 10 |

Giunto semplice
 Threaded barrel nipple
 Unión simple

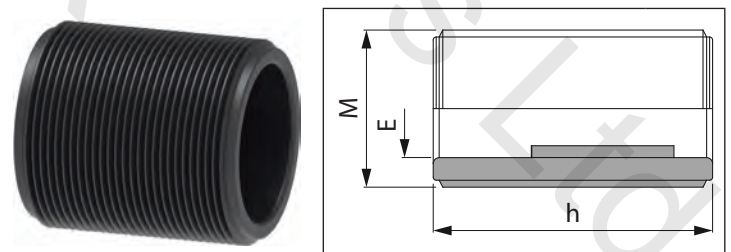

| COD. CODE CÓD. | M | E mm | h mm | |
|----------------------|----------|---------|---------|----|
| 230530 | G 3/4" | 18 | 47 | 25 |
| 230540 | G 1" | 25 | 51 | 25 |
| 230550 | G 1 1/4" | 32 | 34 | 25 |
| 230551 | G 1 1/4" | 32 | 48 | 25 |
| 230560 | G 1 1/2" | 38 | 46 | 10 |
| 230570 | G 2" | 47 | 69 | 10 |

RACCORDI FILETTATI THREAD FITTINGS RACORES CON ROSCA

Riduzione femmina/femmina
Female/female reducer nipple
Reduccion Hembra / Hembra

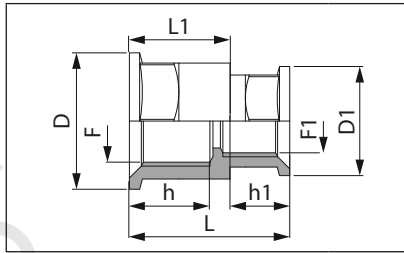

| COD. CODE CÓD. | F | F1 | D mm | D1 mm | h mm | h1 mm | L mm | L1 mm | |
|----------------------|----------|----------|---------|----------|---------|----------|---------|----------|----|
| 2352010 | G 3/8" | G 1/4" | 27 | 21 | 18 | 14 | 35 | 23 | 25 |
| 2352020 | G 1/2" | G 1/4" | 32 | 21 | 19 | 14 | 38 | 26 | 25 |
| 2352021 | G 1/2" | G 3/8" | 32 | 27 | 19 | 17 | 41 | 26 | 25 |
| 2352031 | G 3/4" | G 3/8" | 40 | 27 | 23 | 17 | 45 | 30 | 25 |
| 2352032 | G 3/4" | G 1/2" | 40 | 32 | 23 | 19 | 47 | 30 | 25 |
| 2352042 | G 1" | G 1/2" | 45 | 32 | 23 | 19 | 47 | 30 | 25 |
| 2352043 | G 1" | G 3/4" | 45 | 40 | 23 | 23 | 51 | 30 | 25 |
| 2352053 | G 1 1/4" | G 3/4" | 56 | 40 | 25 | 23 | 53 | 32 | 25 |
| 2352054 | G 1 1/4" | G 1" | 56 | 45 | 25 | 23 | 53 | 32 | 25 |
| 2352064 | G 1 1/2" | G 1" | 62 | 45 | 25 | 23 | 53 | 32 | 10 |
| 2352065 | G 1 1/2" | G 1 1/4" | 62 | 56 | 25 | 25 | 55 | 32 | 10 |
| 2352075 | G 2" | G 1 1/4" | 76 | 56 | 28 | 25 | 58 | 35 | 10 |
| 2352076 | G 2" | G 1 1/2" | 76 | 62 | 28 | 25 | 58 | 35 | 10 |

Prolunga maschio/femmina
Male/female extension
Prolongación macho/hembra

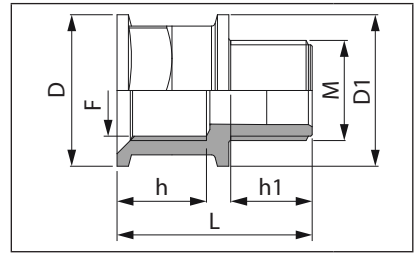

| COD. CODE CÓD. | F | M | D mm | D1 mm | h mm | h1 mm | L mm | |
|----------------------|----------|----------|---------|----------|---------|----------|---------|----|
| 2452022 | G 1/2" | G 1/2" | 32 | 32 | 19 | 18 | 44 | 25 |
| 2452033 | G 3/4" | G 3/4" | 40 | 40 | 23 | 22 | 52 | 25 |
| 2452044 | G 1" | G 1" | 45 | 45 | 23 | 22 | 52 | 25 |
| 2452055 | G 1 1/4" | G 1 1/4" | 56 | 56 | 25 | 24 | 56 | 25 |
| 2452066 | G 1 1/2" | G 1 1/2" | 62 | 62 | 25 | 24 | 56 | 10 |
| 2452077 | G 2" | G 2" | 76 | 76 | 28 | 27 | 62 | 10 |

Riduzione femmina/maschio
Female/male reducer nipple
Reduccion Hembra / Macho

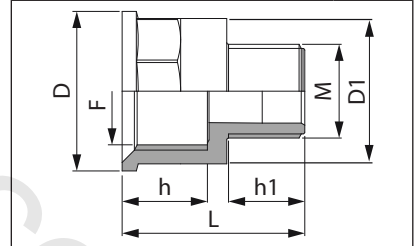

Riduzione maschio/femmina
Male/female reducer nipple
Reduccion Macho / Hembra

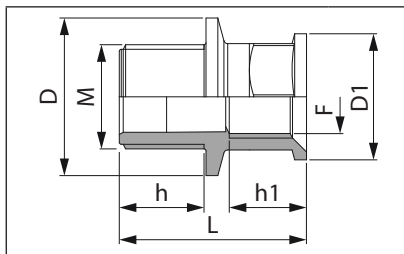

| COD. CODE CÓD. | F | M | D mm | D1 mm | h mm | h1 mm | L mm | |
|----------------------|----------|----------|---------|----------|---------|----------|---------|----|
| 245010 | G 1/4" | G 3/8" | 22 | 22 | 13 | 10 | 23 | 25 |
| 2452032 | G 1/2" | G 3/4" | 40 | 32 | 22 | 19 | 48 | 25 |
| 2452042 | G 1/2" | G 1" | 45 | 32 | 22 | 19 | 48 | 25 |
| 2452043 | G 3/4" | G 1" | 45 | 40 | 22 | 23 | 52 | 25 |
| 2452053 | G 3/4" | G 1 1/4" | 56 | 40 | 24 | 23 | 54 | 25 |
| 2452054 | G 1" | G 1 1/4" | 56 | 45 | 24 | 23 | 54 | 25 |
| 2452064 | G 1" | G 1 1/2" | 62 | 45 | 24 | 23 | 54 | 10 |
| 2452065 | G 1 1/4" | G 1 1/2" | 62 | 56 | 24 | 25 | 56 | 10 |
| 2452075 | G 1 1/4" | G 2" | 76 | 56 | 27 | 25 | 59 | 10 |
| 2452076 | G 1 1/2" | G 2" | 76 | 62 | 27 | 25 | 59 | 10 |
| 2452097 | G 2" | G 3" | 106 | 76 | 35 | 28 | 73 | 10 |

| COD. CODE CÓD. | F | M | D mm | D1 mm | h mm | h1 mm | L mm | |
|----------------------|----------|----------|---------|----------|---------|----------|---------|----|
| 2452001 | G 3/8" | G 1/4" | 27 | 22 | 17 | 11 | 36 | 25 |
| 2452002 | G 1/2" | G 1/4" | 32 | 21 | 19 | 13 | 39 | 25 |
| 2452012 | G 1/2" | G 3/8" | 32 | 27 | 19 | 16 | 42 | 25 |
| 2452013 | G 3/4" | G 3/8" | 40 | 27 | 23 | 16 | 46 | 25 |
| 2452023 | G 3/4" | G 1/2" | 40 | 32 | 23 | 18 | 48 | 25 |
| 2452024 | G 1" | G 1/2" | 45 | 32 | 23 | 18 | 48 | 25 |
| 2452034 | G 1" | G 3/4" | 45 | 40 | 23 | 22 | 52 | 25 |
| 2452035 | G 1 1/4" | G 3/4" | 56 | 40 | 25 | 22 | 54 | 25 |
| 2452045 | G 1 1/4" | G 1" | 56 | 45 | 25 | 22 | 54 | 25 |
| 2452046 | G 1 1/2" | G 1" | 62 | 45 | 25 | 22 | 54 | 10 |
| 2452056 | G 1 1/2" | G 1 1/4" | 62 | 56 | 25 | 24 | 56 | 10 |
| 2452057 | G 2" | G 1 1/4" | 76 | 56 | 28 | 24 | 59 | 10 |
| 2452067 | G 2" | G 1 1/2" | 76 | 62 | 28 | 24 | 59 | 10 |
| 2452079 | G 3" | G 2" | 106 | 100 | 36 | 26 | 74 | 10 |

Ghiera
Lock ring
Tuerca pasante

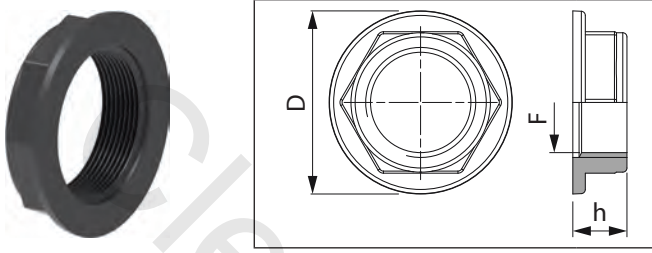

| COD. CODE CÓD. | F | D mm | h mm | |
|----------------------|----------|---------|---------|----|
| 205010 | G 3/8" | 31 | 13 | 25 |
| 2052020 | G 1/2" | 34 | 13 | 25 |
| 2052030 | G 3/4" | 44 | 13 | 25 |
| 2052040 | G 1" | 50 | 15 | 25 |
| 2052050 | G 1 1/4" | 59 | 15 | 25 |
| 2052060 | G 1 1/2" | 67 | 15 | 25 |
| 2052070 | G 2" | 80 | 20 | 10 |
| 2052080 | G 2 1/2" | 100 | 20 | 10 |
| 2052090 | G 3" | 110 | 22 | 10 |
| 2050E0 | M 24x2 | 40 | 10 | 25 |

Tappo femmina
Blanking cap
Tapón hembra

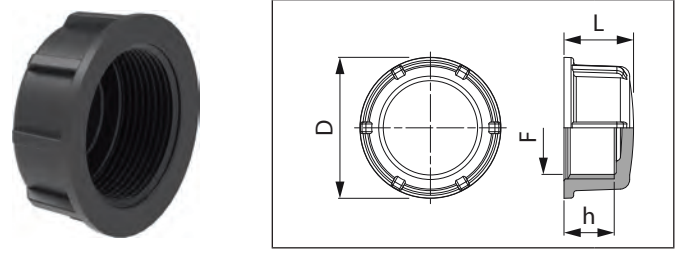

| COD. CODE CÓD. | F | D mm | h mm | L mm | Mat. Mat. Mat. | |
|----------------------|----------|---------|---------|---------|----------------------|----|
| 210005 | G 1/4" | 19 | 7 | 11 | PA | 25 |
| 210010 | G 3/8" | 29 | 14 | 18 | - | 25 |
| 2102020 | G 1/2" | 31 | 13 | 18 | - | 25 |
| 2102030 | G 3/4" | 38 | 13 | 18 | - | 25 |
| 2102040 | G 1" | 46 | 17 | 22 | - | 25 |
| 2102050 | G 1 1/4" | 57 | 18 | 24 | - | 25 |
| 2102060 | G 1 1/2" | 64 | 19 | 25 | - | 25 |
| 2102070 | G 2" | 77 | 19 | 26 | - | 10 |
| 2102080 | G 2 1/2" | 92 | 20 | 27 | - | 10 |
| 2102090 | G 3" | 105 | 25 | 33 | - | 10 |

Tappo maschio
Male plug
Tapón macho

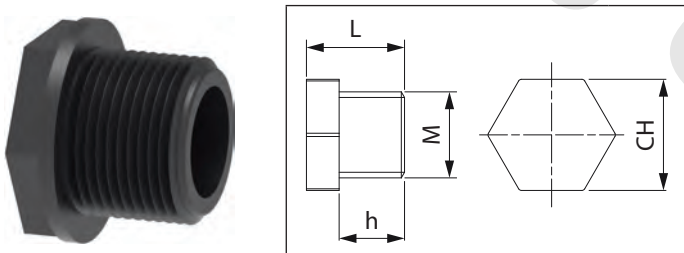

| COD. CODE CÓD. | M | h mm | L mm | CH mm | Mat. Mat. Mat. | |
|----------------------|----------|---------|---------|----------|----------------------|----|
| 215001 | G 1/4" | 9 | 15 | 17 | PA | 25 |
| 215010 | G 3/8" | 10 | 22 | 24 | - | 25 |
| 215020 | G 1/2" | 15 | 23 | 24 | - | 25 |
| 2152030 | G 3/4" | 22 | 34 | 27 | - | 25 |
| 215040 | G 1" | 19 | 30 | 36 | - | 25 |
| 215050 | G 1 1/4" | 21 | 27 | 43 | - | 25 |

Girello
Fly nut
Tuerca para racor

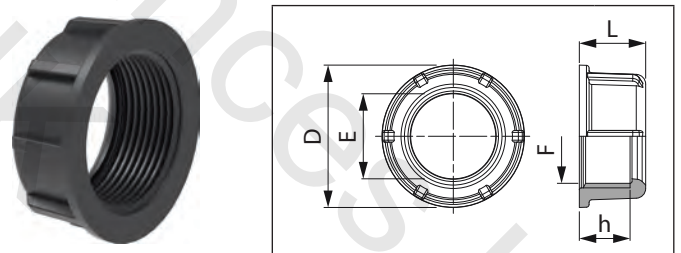

| COD. CODE CÓD. | F | D mm | E mm | h mm | L mm | |
|----------------------|----------|---------|---------|---------|---------|----|
| 200010 | G 3/8" | 29 | 13 | 14 | 18 | 25 |
| 2002020 | G 1/2" | 31 | 15.5 | 13 | 17 | 25 |
| 2002024 | G 1/2" | 31 | 12.5 | 13 | 17 | 25 |
| 2002030 | G 3/4" | 38 | 21.8 | 13 | 17 | 25 |
| 2002040 | G 1" | 46 | 27.8 | 17 | 21 | 25 |
| 2002050 | G 1 1/4" | 57 | 35 | 18 | 22 | 25 |
| 2002060 | G 1 1/2" | 64 | 41 | 19 | 24 | 25 |
| 2002070 | G 2" | 77 | 53.5 | 19 | 24 | 10 |
| 2002080 | G 2 1/2" | 92 | 66 | 20 | 25 | 10 |
| 2002090 | G 3" | 105 | 77 | 25 | 30 | 10 |

Guarnizioni, pagina G-31
Gaskets, page G-31
Juntas, page G-31

GHIERE, GIRELLI, TAPPI
LOCK RING, FLY NUT, PLUG
ACCESORIOS, TUERCAS, TAPÓNES

Manicotto per agitatore
Mixer coupling
Manguito para agitador

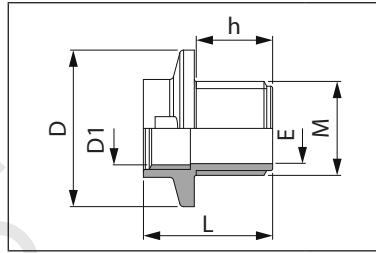

| COD. CODE CÓD. | M | D mm | D1 | E mm | h mm | L mm | |
|----------------------|---------|---------|-----------|---------|---------|---------|----|
| 225224 | M24 x 2 | 40 | G 1/2 BSP | 18 | 20 | 33 | 25 |

Bocchettone scarico
Drain outlet
Racor de desagüe

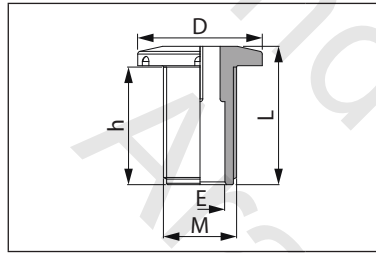

| COD. CODE CÓD. | M | D mm | E mm | h mm | L mm | |
|----------------------|----------|---------|---------|---------|---------|----|
| 220020 | G 1/2" | 38 | 14 | 43 | 48 | 25 |
| 220030 | G 3/4" | 45 | 18 | 43 | 50 | 25 |
| 220040 | G 1" | 50 | 25 | 50 | 55 | 25 |
| 220050 | G 1 1/4" | 58 | 32 | 40 | 45 | 25 |
| 220052 | G 1 1/4" | 59 | 32 | 55 | 60 | 25 |
| 220060 | G 1 1/2" | 66 | 38 | 46 | 52 | 25 |
| 220070 | G 2" | 76 | 47.5 | 66 | 74 | 10 |
| 220080 | G 2 1/2" | 100 | 63.5 | 70 | 76 | 10 |

Raccordo livello atomizzatore
Atomiser level fitting
Racor nivel atomizador

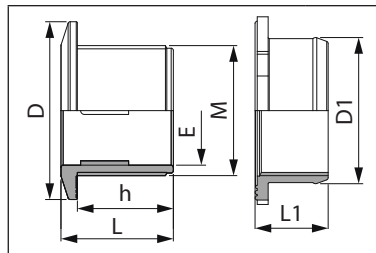

| COD. CODE CÓD. | M | D mm | D1 mm | E mm | h mm | L mm | L1 mm | |
|----------------------|------|---------|----------|---------|---------|---------|----------|----|
| 260010 | G 2" | 84 | 66 | 50 | 45 | 52 | 33 | 25 |

Prese d'acqua antivortice
Anti-vortex outlets
Conexiones antirremolino

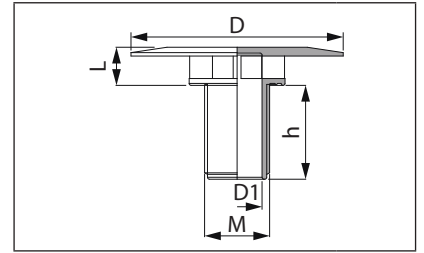

| COD. CODE CÓD. | M | D mm | D1 mm | h mm | L mm |
|----------------------|----------|---------|----------|---------|---------|
| 504104 | G 1" | 108 | 25 | 46 | 19 |
| 504105 | G 1 1/4" | 108 | 32 | 46 | 19 |
| 5042106 | G 1 1/2" | 100 | 38 | 49 | 27 |
| 5042107 | G 2" | 120 | 47.5 | 56 | 27 |
| 504108 | G 2 1/2" | 120 | 63.5 | 56 | 31 |

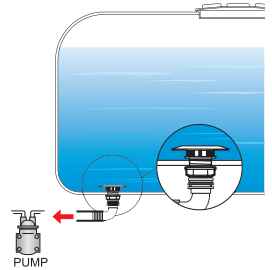

Prese d'acqua antivortice
Anti-vortex outlets
Conexiones antirremolino

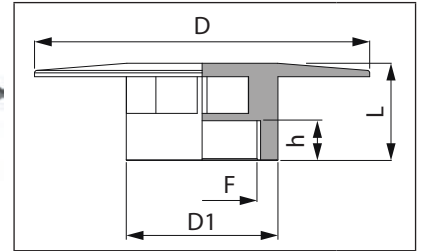
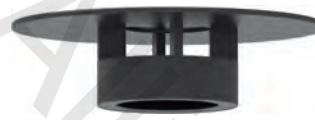

| COD. CODE CÓD. | F | D mm | D1 mm | h mm | L mm |
|----------------------|----------|---------|----------|---------|---------|
| 504116 | G 1 1/2" | 135 | 62 | 16 | 40 |

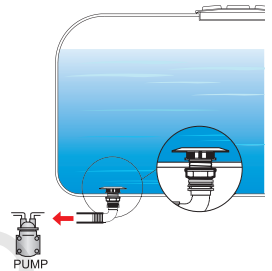

Bocchettone di scarico
Drain outlet
Racor de desagüe

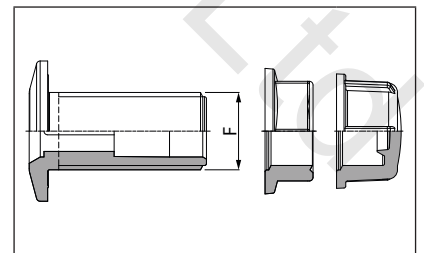

| COD. CODE CÓD. | F | |
|----------------------|----------|----|
| 220029 | G 1/2" | 25 |
| 220039 | G 3/4" | 25 |
| 220049 | G 1" | 25 |
| 220059 | G 1 1/4" | 25 |
| 220069 | G 1 1/2" | 25 |
| 220079 | G 2" | 10 |
| 220089 | G 2 1/2" | 10 |

Guarnizioni, pagina G-31
 Gaskets, page G-31
 Juntas, page G-31

Guarnizioni per raccordi portagomma con OR
Gasket for hose fittings with OR
Juntas para racores con OR

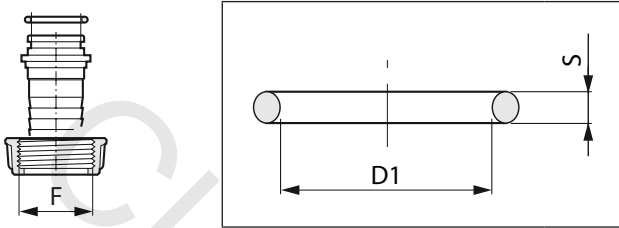

| F | COD. CODE CÒD. | D1 mm | S mm | |
|----------|----------------|-------|------|----|
| G 3/8" | G11057 | 9.1 | 2.6 | 50 |
| G 1/2" | G11060 | 10.5 | 2 | 25 |
| G 3/4" | G10031 | 13.1 | 2.6 | 50 |
| G 1" | G10041 | 20.2 | 2.6 | 50 |
| G 1 1/4" | G10051 | 26.7 | 2.6 | 50 |
| G 1 1/2" | G10061 | 29.2 | 3 | 50 |
| G 2" | G10071 | 39.3 | 2.6 | 50 |
| G 2 1/2" | G10081 | 56.7 | 3.5 | 25 |
| G 3" | G10091 | 68.3 | 3.5 | 10 |

Guarnizioni per raccordi portagomma con sede piana
Gasket for hose fittings with flat seat
Juntas para racores con asiento plano

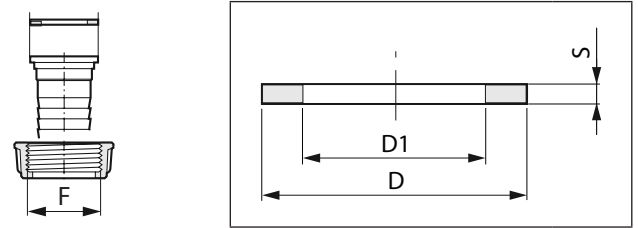

| F | COD. CODE CÒD. | D mm | D1 mm | S mm | |
|----------|----------------|------|-------|------|----|
| G 3/8" | 424190 | 14 | 10 | 2 | 25 |
| G 1/2" | G40012 | 19.2 | 11.5 | 2.5 | 50 |
| G 3/4" | G40013 | 24.5 | 17 | 2.5 | 50 |
| G 1" | G40014 | 30.7 | 20 | 2.5 | 50 |
| G 1 1/4" | G40015 | 39.5 | 27.5 | 2.5 | 50 |

Guarnizioni per raccordi a tenuta con OR
Gasket for OR seal fittings
Juntas para racores con estanqueidad con OR

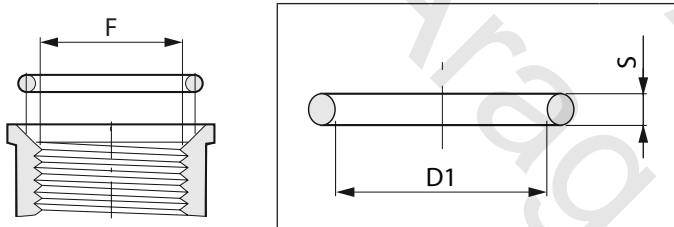

| F | COD. CODE CÒD. | D1 mm | S mm | |
|----------|----------------|-------|------|----|
| G 1" | G10041 | 20.2 | 2.6 | 50 |
| G 3/4" | G11058 | 25 | 2.6 | 50 |
| G 1" | G11059 | 29.8 | 2.6 | 50 |
| G 1 1/4" | G10052 | 39.7 | 3.5 | 50 |
| G 1 1/2" | G10062 | 47.2 | 3.5 | 50 |
| G 2" | G10073 | 58.7 | 3.5 | 25 |
| G 2 1/2" | G10082 | 74.6 | 3.5 | 25 |
| G 3" | G10092 | 85.5 | 3.5 | 10 |

Guarnizioni per filetti maschio passaparete
Gasket for bulkhead male threads
Juntas para roscas macho pasapared

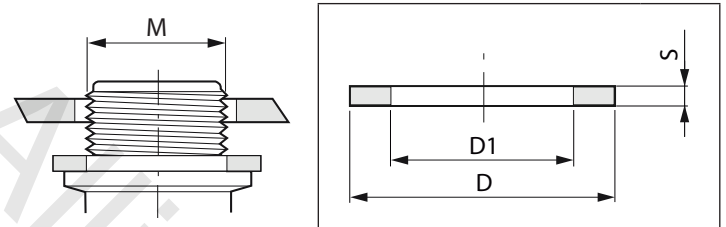

| M | COD. CODE CÒD. | D mm | D1 mm | S mm | |
|----------|----------------|------|-------|------|----|
| G 1/2" | G40002 | 33 | 21 | 2.5 | 50 |
| G 3/4" | G40015 | 39.5 | 27.5 | 2.5 | 50 |
| G 1" | G40004 | 45 | 33 | 3 | 50 |
| G 1 1/4" | G40005 | 57.5 | 40 | 4 | 50 |
| G 1 1/2" | G40006 | 67 | 47 | 3 | 50 |
| G 2" | G40007 | 86 | 59 | 4 | 25 |
| G 2 1/2" | G40008 | 94.5 | 76 | 4 | 25 |
| G 3" | G40009 | 110 | 90 | 4 | 25 |

Guarnizioni per tappi femmina con OR
Gasket for blanking caps with OR
Juntas para tapones hembra con OR

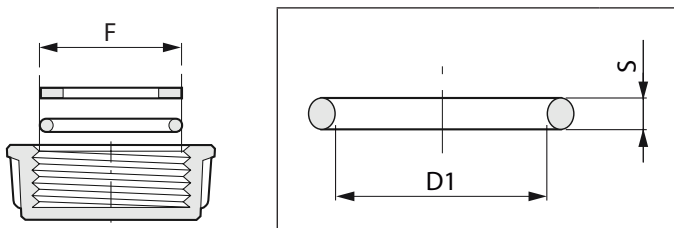

| F | COD. CODE CÒD. | D1 mm | S mm | |
|--------|----------------|-------|------|----|
| G 1/2" | G10020 | 14 | 3 | 50 |
| G 3/8" | G11068 | 12 | 2.6 | 50 |

Guarnizioni per tappi femmina
Gasket for blanking caps
Juntas para tapones hembra

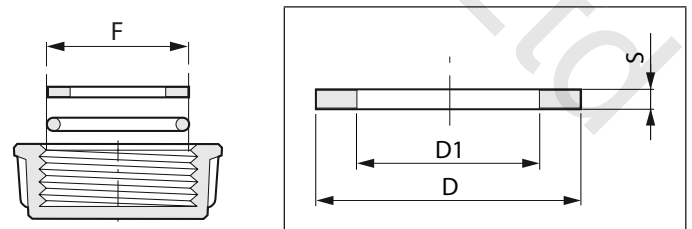

| F | COD. CODE CÒD. | D mm | D1 mm | S mm | |
|----------|----------------|------|-------|------|----|
| G 3/4" | G40013 | 24.5 | 17 | 2.5 | 50 |
| G 1" | G40014 | 30.7 | 20 | 2.5 | 50 |
| G 1 1/4" | G40015 | 39.5 | 27.5 | 2.5 | 50 |
| G 1 1/2" | G40004 | 45 | 33 | 3 | 50 |
| G 2" | G40005 | 57.5 | 40 | 4 | 50 |
| G 2 1/2" | G40010 | 75 | 55 | 4 | 25 |
| G 3" | G40007 | 86 | 59 | 4 | 25 |

ACCOPIATORI CON BLOCCAGGIO A CAMME

COUPLINGS WITH CAM LOCKING

ACOPLES CON BLOQUEO DE EXCENTRICAS

- Compatibili con gli accoppiatori MIL-C-27487
- Leve di bloccaggio in acciaio INOX per una massima resistenza meccanica ed alla corrosione (2 leve nei modelli fino a 3" e 3 leve nei modelli da 4")
- Il materiale impiegato, polipropilene rinforzato con fibra di vetro, assicura un'ottima resistenza meccanica e agli agenti chimici
- Su richiesta disponibili anche in Nylon® rinforzato con fibra di vetro
- Filettatura GAS (NPT a richiesta)
- Nelle versioni con filettatura GAS femmina è presente la sede conica per la tenuta con O-ring (compatibile con tutta la nuova produzione di raccorderia ARAG)
- Pressione di utilizzo max 9 BAR (130 PSI) per i modelli da 1/4" a 2"; max 5 BAR (75 PSI) per i modelli da 3" e 4"
- Guarnizioni di tenuta standard in EPDM (Viton® e NBR a richiesta)
- Suitable to couplings MIL-C-27487
- STAINLESS STEEL locking levers for maximum mechanical strength and corrosion resistance (2 locking levers up to 3" models and 3 levers for 4" models)
- The material used, fibreglass-reinforced polypropylene, ensures excellent mechanical strength and good resistance against chemical agents
- On request, also available in fibreglass-reinforced Nylon®
- BSP threads (NPT on request)
- A tapered seat for the O-ring seal is fitted in the female thread BSP versions (compatible with all new ARAG fittings)
- Max. working pressure 9 BAR (130 PSI) for the 3/4" to 2" models; max. 5 BAR (75 PSI) for the 3" and 4" models
- EPDM standard gaskets (Viton® and NBR on request)
- Compatibles con las conexiones MIL-C-27487
- Levas de bloqueo de acero INOX, máxima resistencia mecánica y a la corrosión (2 levas hasta modelos de 3" y 3 levas para el modelo de 4")
- El material utilizado, polipropileno reforzado con fibra de vidrio, asegura una óptima resistencia mecánica y a los agentes químicos
- Bajo pedido están disponibles en Nylon® reforzado con fibra de vidrio
- Roscas disponibles GAS (NPT bajo pedido)
- Las versiones con rosca GAS hembra incorporan el asiento conico para la estanqueidad con O-ring (compatible con toda la nueva producción de racores ARAG)
- Presión de utilización Máx 9 BAR (130 PSI) para los modelos de 3/4" a 2", máx. 5 BAR (75 PSI) para los modelos de 3" y de 4".
- Juntas de estanqueidad en EPDM (Viton® y NBR bajo pedido)

Adattatore maschio / Filetto femmina
Male adapter / Female thread
Adaptador macho / Rosca hembra



| COD. CODE CÓD. | Corpo Body Cuerpo | F |
|----------------------|-------------------------|----------|
| 18103A2 | 3/4" | G 1/2" |
| 18103A | 3/4" | G 3/4" |
| 18104A | 1" | G 1" |
| 18105A | 1 1/4" | G 1 1/4" |
| 18106A5 | 1 1/2" | G 1 1/4" |
| 18106A | 1 1/2" | G 1 1/2" |
| 18107A | 2" | G 2" |
| 18109A8 | 3" | G 2 1/2" |
| 18109A | 3" | G 3" |
| 1810AA | 4" | G 4" |

Accoppiatore femmina / Filetto maschio
Female coupler / Male thread
Conexión hembra / Rosca macho



| COD. CODE CÓD. | Corpo Body Cuerpo | M |
|----------------------|-------------------------|----------|
| 18103B2 | 3/4" | G 1/2" |
| 18103B | 3/4" | G 3/4" |
| 18104B | 1" | G 1" |
| 18105B | 1 1/4" | G 1 1/4" |
| 18106B5 | 1 1/2" | G 1 1/4" |
| 18106B | 1 1/2" | G 1 1/2" |
| 18107B | 2" | G 2" |
| 18109B8 | 3" | G 2 1/2" |
| 18109B | 3" | G 3" |
| 1810AB | 4" | G 4" |

Accoppiatore femmina / Portagomma
Female coupler / Hose fitting
Conexión hembra / Portamangueras



| COD. CODE CÓD. | Corpo Body Cuerpo | Ø mm |
|----------------------|-------------------------|---------|
| 18103C2 | 3/4" | 13 |
| 18103C | 3/4" | 19 |
| 18104C | 1" | 25 |
| 18104C5 | 1" | 32 |
| 18105C30 | 1 1/4" | 30 |
| 18105C | 1 1/4" | 32 |
| 18106C5 | 1 1/2" | 32 |
| 18106C | 1 1/2" | 38 |
| 18106C40 | 1 1/2" | 40 |
| 18107C | 2" | 50 |
| 18107C53 | 2" | 53 |
| 18107C55 | 2" | 55 |
| 18109C60 | 3" | 60 |
| 18109C8 | 3" | 63 |
| 18109C | 3" | 75 |
| 18109C78 | 3" | 78 |
| 18109C87 | 3" | 87 |
| 1810AC105 | 4" | 105 |

ACCOPIATORI CON BLOCCAGGIO A CAMME COUPLINGS WITH CAM LOCKING ACOPLES CON BLOQUEO DE EXCENTRICAS

Accoppiatore femmina / Filetto femmina
Female coupler / Female thread
Conexión hembra / Rosca hembra



| COD. CODE CÓD. | Corpo Body Cuerpo | F |
|----------------------|-------------------------|----------|
| 18103D2 | 3/4" | G 1/2" |
| 18103D | 3/4" | G 3/4" |
| 18104D | 1" | G 1" |
| 18105D | 1 1/4" | G 1 1/4" |
| 18106D5 | 1 1/2" | G 1 1/4" |
| 18106D | 1 1/2" | G 1 1/2" |
| 18107D | 2" | G 2" |
| 18109D8 | 3" | G 2 1/2" |
| 18109D | 3" | G 3" |
| 1810AD | 4" | G 4" |

Adattatore maschio / Filetto maschio
Male adapter / Male thread
Adaptador macho / Rosca macho



| COD. CODE CÓD. | Corpo Body Cuerpo | M |
|----------------------|-------------------------|----------|
| 18103F2 | 3/4" | G 1/2" |
| 18103F | 3/4" | G 3/4" |
| 18104F | 1" | G 1" |
| 18105F | 1 1/4" | G 1 1/4" |
| 18106F5 | 1 1/2" | G 1 1/4" |
| 18106F | 1 1/2" | G 1 1/2" |
| 18107F | 2" | G 2" |
| 18109F8 | 3" | G 2 1/2" |
| 18109F | 3" | G 3" |
| 1810AF | 4" | G 4" |

Tappo per adattatore maschio
Plug for male adapter
Tapón para adaptador macho



| COD. CODE CÓD. | Corpo Body Cuerpo |
|----------------------|-------------------------|
| 18103H | 3/4" |
| 18104H | 1" |
| 18105H | 1 1/4" |
| 18106H | 1 1/2" |
| 18107H | 2" |
| 18109H | 3" |
| 1810AH | 4" |

Adattatore maschio / Portagomma
Male adapter / Hose fitting
Adaptador macho / Portamangueras



| COD. CODE CÓD. | Corpo Body Cuerpo | Ø mm |
|----------------------|-------------------------|---------|
| 18103E2 | 3/4" | 13 |
| 18103E | 3/4" | 19 |
| 18104E | 1" | 25 |
| 18104E5 | 1" | 32 |
| 18105E30 | 1 1/4" | 30 |
| 18105E | 1 1/4" | 32 |
| 18106E5 | 1 1/2" | 32 |
| 18106E | 1 1/2" | 38 |
| 18106E40 | 1 1/2" | 40 |
| 18107E | 2" | 50 |
| 18107E53 | 2" | 53 |
| 18107E55 | 2" | 55 |
| 18109E60 | 3" | 60 |
| 18109E8 | 3" | 63 |
| 18109E | 3" | 75 |
| 18109E78 | 3" | 78 |
| 18109E87 | 3" | 87 |
| 1810AE105 | 4" | 105 |

Tappo per accoppiatore femmina
Plug for female coupler
Tapón para conexión hembra



| COD. CODE CÓD. | Corpo Body Cuerpo |
|----------------------|-------------------------|
| 18103G | 3/4" |
| 18104G | 1" |
| 18105G | 1 1/4" |
| 18106G | 1 1/2" |
| 18107G | 2" |
| 18109G | 3" |
| 1810AG | 4" |

Molla antiapertura
Locking spring
Traba anti-apertura para conexión rápida



| COD. CODE CÓD. | Corpo Body Cuerpo |
|----------------------|-------------------------|
| 181030 | 3/4" |
| 181040 | 1" |
| 181050 | 1 1/4" |
| 181060 | 1 1/2" |
| 181070 | 2" |
| 181090 | 3" |

REGOLATORI MODULARI MODULAR REGULATORS REGULADORES MODULARES

Regolatori modulari per macchine a basso volume
Modular regulators for low volume sprayers
Reguladores modulares para máquinas de bajo volumen



Collettore modulare T4 M/F uscita T3M
T3M output T4 M/F modular manifold
Colector modular T4 M/H salida T3M

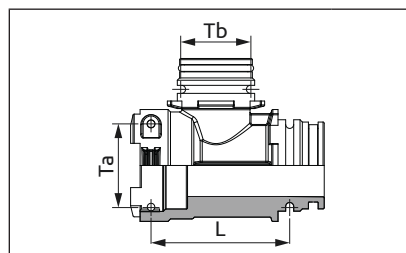
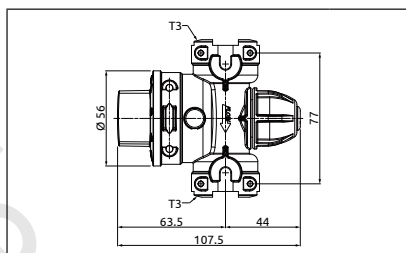

| COD. CODE CÒD. | T |
|----------------|----|
| 441135 | T3 |
| 441235 | T3 |



Portate / Flowrate cod. 441135
Disco calibrato / Calibrated disc Ø 1.2 ± 5.0 mm - NERO / BLACK

| Ø fori Holes Ø (mm) | Pos. | Pressione / Pressure (bar) | | | | | | | |
|---------------------|------|----------------------------|-------|-------|-------|-------|-------|-------|--|
| | | 1 | 1.5 | 2 | 2.5 | 3 | 3.5 | 4 | |
| 1.20 | 1 | 0.88 | 1.05 | 1.19 | 1.33 | 1.45 | 1.57 | 1.67 | |
| 1.60 | 2 | 1.59 | 1.86 | 2.11 | 2.33 | 2.53 | 2.69 | 2.83 | |
| 2.00 | 3 | 2.46 | 2.86 | 3.12 | 3.41 | 3.88 | 4.16 | 4.42 | |
| 2.60 | 4 | 4.20 | 4.98 | 5.57 | 6.13 | 6.64 | 7.11 | 7.55 | |
| 3.00 | 5 | 5.36 | 6.61 | 7.56 | 8.28 | 8.94 | 9.51 | 10.05 | |
| 3.50 | 6 | 7.62 | 9.22 | 10.23 | 11.19 | 12.11 | 12.95 | 13.74 | |
| 4.00 | 7 | 9.70 | 11.87 | 13.23 | 14.56 | 15.77 | 16.83 | 17.89 | |
| 5.00 | 8 | 15.82 | 18.86 | 20.01 | 20.95 | 22.67 | 24.37 | 25.91 | |



| COD. CODE CÒD. | Ta | Tb | L | COD. CODE CÒD. |
|----------------|----|----|----|----------------|
| 463T2001.300 | T4 | T3 | 57 | 010004 |

Forchetta da ordinare separatamente
Fork to be ordered separately
Horquilla para pedir por separado



Portate / Flowrate cod. 441235
Disco calibrato / Calibrated disc Ø 0.8 ± 3.0 mm - GRIGIO / GREY

| Ø fori Holes Ø (mm) | Pos. | Pressione / Pressure (bar) | | | | | | | |
|---------------------|------|----------------------------|------|------|------|------|------|------|--|
| | | 1 | 1.5 | 2 | 2.5 | 3 | 3.5 | 4 | |
| 0.8 | 1 | 0.43 | 0.52 | 0.60 | 0.62 | 0.68 | 0.73 | 0.77 | |
| 1.00 | 2 | 0.60 | 0.71 | 0.80 | 0.89 | 0.97 | 1.04 | 1.11 | |
| 1.30 | 3 | 0.97 | 1.15 | 1.32 | 1.46 | 1.59 | 1.71 | 1.83 | |
| 1.60 | 4 | 1.44 | 1.72 | 1.96 | 2.19 | 2.39 | 2.58 | 2.75 | |
| 1.90 | 5 | 2.00 | 2.40 | 2.76 | 3.09 | 3.37 | 3.64 | 3.88 | |
| 2.20 | 6 | 3.07 | 3.47 | 3.91 | 4.31 | 4.67 | 5.01 | 5.33 | |
| 2.60 | 7 | 4.06 | 4.90 | 5.49 | 6.03 | 6.54 | 6.98 | 7.42 | |
| 3.00 | 8 | 5.81 | 6.63 | 7.31 | 8.03 | 8.73 | 9.35 | 9.93 | |

Regolatori modulari per macchine a basso volume
Modular regulators for low volume sprayers
Reguladores modulares para máquinas de bajo volumen



Corpo con singolo attacco a forchetta T1
Body with single fork coupling T1
Cuerpo acople simple a horquilla T1

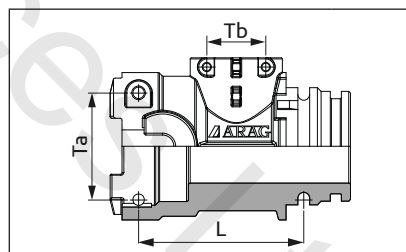
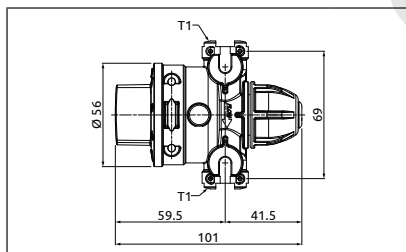

| COD. CODE CÒD. | T |
|----------------|----|
| 441115 | T1 |
| 441215 | T1 |



Portate / Flowrate cod. 441115
Disco calibrato / Calibrated disc Ø 1.2 ± 5.0 mm - NERO / BLACK

| Ø fori Holes Ø (mm) | Pos. | Pressione / Pressure (bar) | | | | | | | |
|---------------------|------|----------------------------|-------|-------|-------|-------|-------|-------|--|
| | | 1 | 1.5 | 2 | 2.5 | 3 | 3.5 | 4 | |
| 1.20 | 1 | 0.88 | 1.05 | 1.19 | 1.33 | 1.45 | 1.57 | 1.67 | |
| 1.60 | 2 | 1.59 | 1.86 | 2.11 | 2.33 | 2.53 | 2.69 | 2.83 | |
| 2.00 | 3 | 2.46 | 2.86 | 3.12 | 3.41 | 3.88 | 4.16 | 4.42 | |
| 2.60 | 4 | 4.20 | 4.98 | 5.57 | 6.13 | 6.64 | 7.11 | 7.55 | |
| 3.00 | 5 | 5.36 | 6.61 | 7.56 | 8.28 | 8.94 | 9.51 | 10.05 | |
| 3.50 | 6 | 7.62 | 9.22 | 10.23 | 11.19 | 12.11 | 12.95 | 13.74 | |
| 4.00 | 7 | 9.70 | 11.87 | 13.23 | 14.56 | 15.77 | 16.83 | 17.89 | |
| 5.00 | 8 | 15.82 | 18.86 | 20.01 | 20.95 | 22.67 | 24.37 | 25.91 | |

| COD. CODE CÒD. | Ta | Tb | L |
|----------------|----|----|----|
| 440C31 | T3 | T1 | 45 |



Portate / Flowrate cod. 441215
Disco calibrato / Calibrated disc Ø 0.8 ± 3.0 mm - GRIGIO / GREY

| Ø fori Holes Ø (mm) | Pos. | Pressione / Pressure (bar) | | | | | | | |
|---------------------|------|----------------------------|------|------|------|------|------|------|--|
| | | 1 | 1.5 | 2 | 2.5 | 3 | 3.5 | 4 | |
| 0.8 | 1 | 0.43 | 0.52 | 0.60 | 0.62 | 0.68 | 0.73 | 0.77 | |
| 1.00 | 2 | 0.60 | 0.71 | 0.80 | 0.89 | 0.97 | 1.04 | 1.11 | |
| 1.30 | 3 | 0.97 | 1.15 | 1.32 | 1.46 | 1.59 | 1.71 | 1.83 | |
| 1.60 | 4 | 1.44 | 1.72 | 1.96 | 2.19 | 2.39 | 2.58 | 2.75 | |
| 1.90 | 5 | 2.00 | 2.40 | 2.76 | 3.09 | 3.37 | 3.64 | 3.88 | |
| 2.20 | 6 | 3.07 | 3.47 | 3.91 | 4.31 | 4.67 | 5.01 | 5.33 | |
| 2.60 | 7 | 4.06 | 4.90 | 5.49 | 6.03 | 6.54 | 6.98 | 7.42 | |
| 3.00 | 8 | 5.81 | 6.63 | 7.31 | 8.03 | 8.73 | 9.35 | 9.93 | |

Esempio di montaggio
Assembly example
Ejemplo de montaje

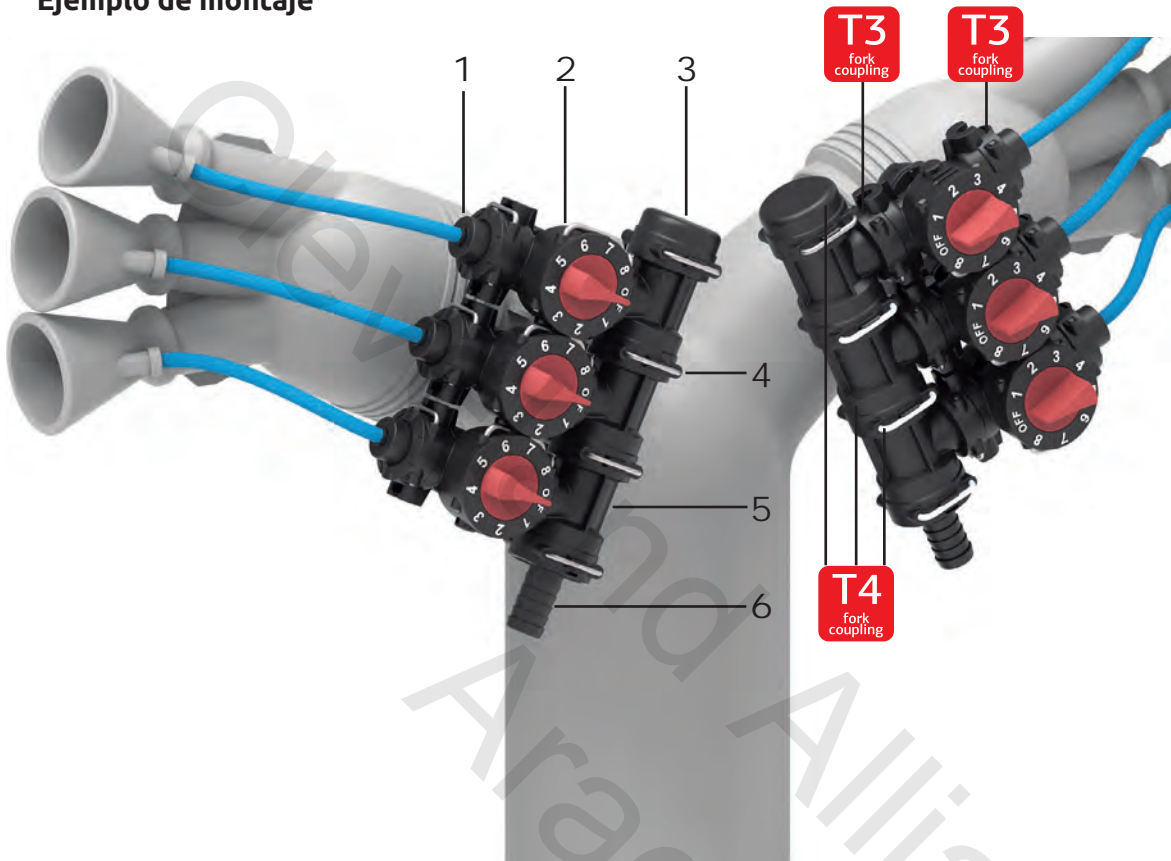

| | COD. CODE CÓD. | PAG. PAGE PÁG. |
|---|----------------------|----------------------|
| 1 | 10913C00 | G-13 |
| 2 | 441135 | G-34 |
| 3 | 219040 | G-7 |
| 4 | 010004 | --- |
| 5 | 463T2001.300 | G-34 |
| 6 | 1091420 | G-2 |

Esempio di montaggio
Assembly example
Ejemplo de montaje

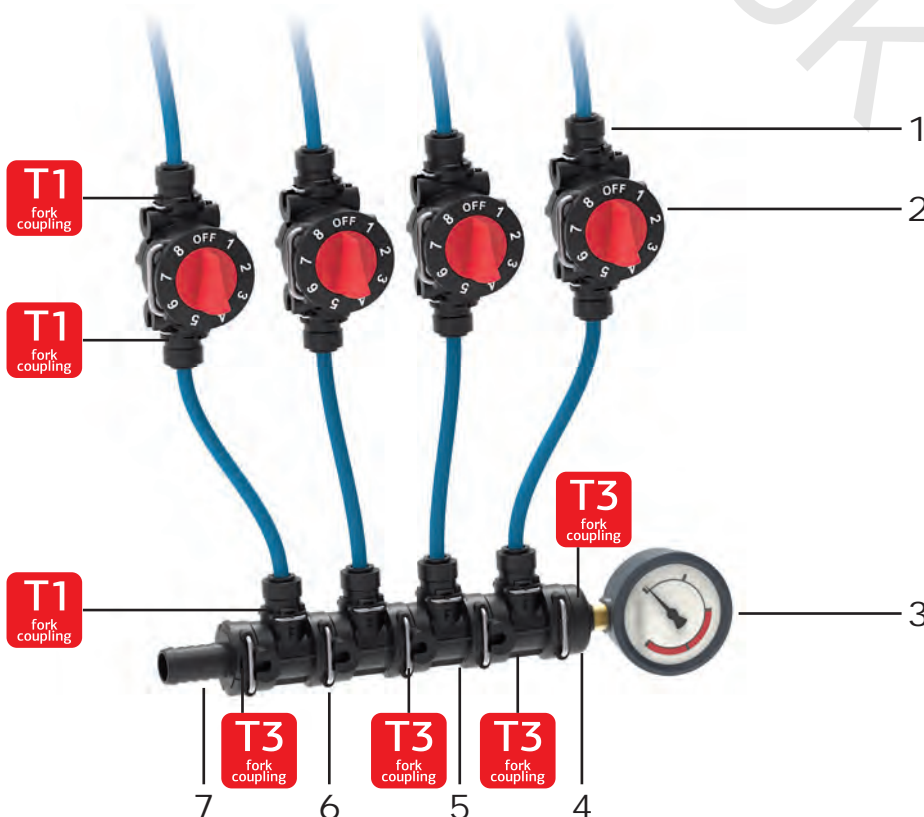

| | COD. CODE CÓD. | PAG. PAGE PÁG. |
|---|----------------------|----------------------|
| 1 | 10911C01 | G-13 |
| 2 | 441115 | G-34 |
| 3 | 9180525 | L-34 |
| 4 | 219035 | G-36 |
| 5 | 440C31 | G-34 |
| 6 | 010003 | --- |
| 7 | 1091320 | G-2 |

REGOLATORI MODULARI MODULAR REGULATORS REGULADORES MODULARES

Regolatori modulari per macchine a basso volume

La modularità del sistema offre soluzioni per le più disparate configurazioni di macchina, garantendo nel contempo altissima precisione d'esercizio. La ghiera graduata consente di preimpostare agevolmente i parametri di lavoro per ogni tipo di trattamento.



Raccordo maschio portamanometro G 1/4"
Male fitting for pressure gauge G 1/4"
Racor macho con portamanómetro G 1/4"

COD. / CODE / CÓD.
219135

*
T3
fork
coupling

Raccordi di completamento con attacco a forchetta nel capitolo: FITTINGS
End fittings with fork coupling in chapter: FITTINGS
Racores de terminación con conexión de horquilla en el capítulo: FITTINGS

Modular regulators for low volume sprayers

The modularity of the system offers solutions for any kind of machine's configuration, granting at the same time very high precision of exercise. The graduated nut allows the easy setting up of working parameters for every kind of treatment.

Reguladores modulares para máquinas de bajo volumen

La modularidad del sistema ofrece soluciones para las más disparatadas configuraciones de máquina, garantizando en el mismo tiempo una muy altísima precisión en el ejercicio. La tuerca graduada permite imponer los parámetros de trabajo para cada tipo de tratamiento.

COD. / CODE / CÓD.
G11058

O-ring



COD. / CODE / CÓD.
440D31

Corpo con doppio attacco a forchetta
Body with double fork coupling
Cuerpo con acople doble a horquilla



Portagetto con antigoccia, rubinetto e attacco rapido
Nozzle holder with check valve, stopcock and quick fitting
Portaboquillas con antigota, grifo y conexión rápida

| COD. / CODE / CÓD. | |
|--------------------|-----------|
| 402315C | 10 |



Portagetto con antigoccia e attacco rapido
Nozzle holder with check valve and quick fitting
Portaboquillas con antigota y conexión rápida

| COD. / CODE / CÓD. | |
|--------------------|-----------|
| 402315 | 10 |

Testina attacco rapido
Quick fitting cap
Cabezal de conexión rápida

COD. / CODE / CÓD.
40290403



Portagomma per tubo Ø 8 mm
Hosetail for hose Ø 8 mm
Portamanguera para tubo Ø 8 mm

COD. / CODE / CÓD.
105108R

Portagetto con innesto rapido per tubo e antigoccia
Nozzle holder with quick coupling for hose and check valve
Portaboquillas con conexión rápida para tubo y antigota

| COD. / CODE / CÓD. | Ø |
|--------------------|------|
| 402415 | 6 mm |
| 402425 | 8 mm |

Portagomma
Hosetail
Portamanguera

| COD. / CODE / CÓD. | Ø |
|--------------------|-------|
| 105108A | 8 mm |
| 105110A | 10 mm |

Corpo con regolazione / Body with regulation / Cuerpo con regulacion

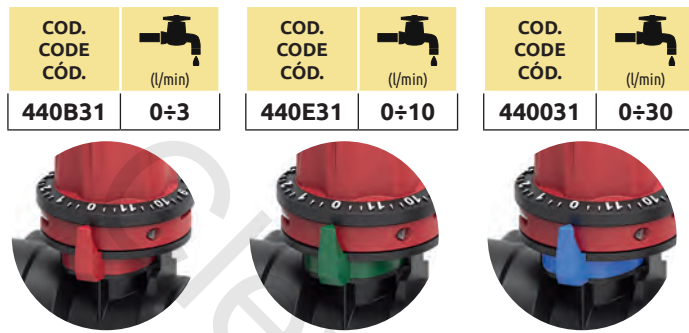

Posizione del regolatore / Regulator position / Posición del regulador

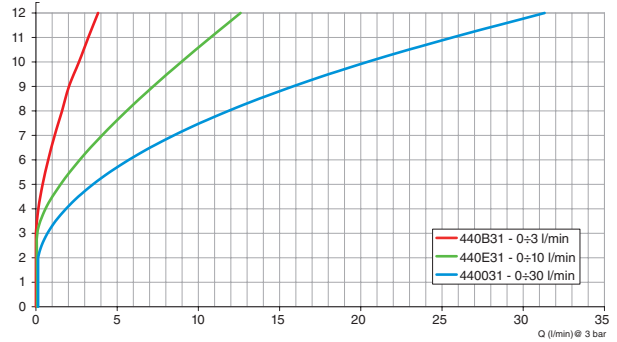

COD. / CODE / CÓD.

440C31

Corpo con singolo attacco a forchetta
Body with single fork coupling
Cuerpo acople simple a horquilla

T1
fork
coupling

Raccordo femmina portamanometro G 1/4"
Female fitting for pressure gauge G 1/4"
Racor hembra con portamanómetro G 1/4"

COD. / CODE / CÓD.

219035



O-ring

COD. / CODE / CÓD.

G11056

T1
fork
coupling

T1
fork
coupling

Portagomma
Hosetail
Portamanguera

Forchetta
Fork
Horquilla

COD. / CODE / CÓD.

010003

Attacco rapido per tubo
Quick fitting for hose
Conexión rápida por tubo

| COD. CODE CÓD. | Ø |
|----------------------|------|
| 10911C08 | 8 mm |
| 10911C00 | 1/4" |
| 10911C01 | 3/8" |

Portagetto con innesto rapido per tubo Ø 8 mm, antigoccia e testina filettata G 3/8"

Nozzle holder with quick coupling for hose Ø 8 mm, check valve and threaded cap 3/8"

Portaboquillas con conexión rápida para tubo Ø 8 mm, antigota y boquilla rosca G 3/8"

COD. / CODE / CÓD.

402625

10



Portagetto con innesto rapido per tubo Ø 8 mm, antigoccia e attacco rapido per testina

Anti-drip nozzle holder with quick-coupling for Ø 8 mm pipe and quick connection for nozzle tip

Porta-boquilla con engancho rápido para tubo Ø 8 mm, antigoteo y conexión rápida para cabezal

COD. / CODE / CÓD.

402825

10



RACCORDI AD INNESTO RAPIDO PER TUBO RIGIDO QUICK-COUPLING FITTINGS FOR RIGID PIPE RACORES DE ENGANCHE RÁPIDO PARA TUBO RÍGIDO

- Realizzati in resina acetica e particolari interni in acciaio Inox
- O-ring interno in NBR
- Per tubi in metallo o in plastica
- Rapida installazione senza ausilio di attrezzature, **non è necessario filettare il tubo**

- Made of acetalic resin (inside parts in inox stainless steel)
- NBR internal O-ring
- For metal and plastic pipes
- Fast assembling without equipments; **no needs to thread the pipe**

- Hechos en resina acetica con componentes interiores en acero Inox
- Junta interiora de NBR
- Para tubos de metal y de plastico
- Instalacion rapida sin auxilio de equipos, **no hay que enroscar el tubo**

Innesto rapido terminale
Terminal quick coupling
Conexión rápida terminal



| COD. CODE CÓD. | Ø Tubo Pipe Ø Ø Tubo | F |
|----------------------|----------------------------|------------|
| F01PM010611E | 6 mm | G 1/8" BSP |

Terminale con codolo
Terminal c/w tang
Terminal con espiga



| COD. CODE CÓD. | Ø Tubo Pipe Ø Ø Tubo | F |
|----------------------|----------------------------|------------|
| F01PM050611E | 6 mm | G 1/8" BSP |

Innesto rapido 90°
90° quick coupling
Conexión rápida 90°



| COD. CODE CÓD. | Ø Tubo Pipe Ø Ø Tubo |
|----------------------|----------------------------|
| F01PM0306E | 6 mm |

Innesto rapido a "T"
"T" quick coupling
Conexión rápida a "T"



| COD. CODE CÓD. | Ø Tubo Pipe Ø Ø Tubo |
|----------------------|----------------------------|
| F01PM0206E | 6 mm |

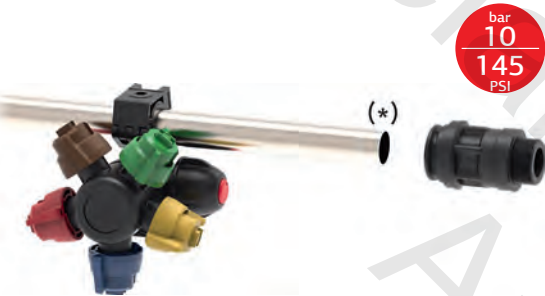

- * Montaggio degli innesti in www.aragnet.com doc.# D30002
- * Installation of fittings on www.aragnet.com doc.# D30002
- * Instalacion de racores sobre www.aragnet.com doc.# D30002

Innesto rapido
Rapid coupling
Conexión rápida



| COD. CODE CÓD. | Ø Tubo Pipe Ø Ø Tubo |
|----------------------|----------------------------|
| F01PM0422E | 22 mm |

Innesto rapido a 90°
90° rapid coupling
Conexión rápida 90°



| COD. CODE CÓD. | Ø Tubo Pipe Ø Ø Tubo |
|----------------------|----------------------------|
| F01PM0322E | 22 mm |

Innesto rapido a "T"
"T" rapid coupling
Conexión rápida a "T"



| COD. CODE CÓD. | Ø Tubo Pipe Ø Ø Tubo |
|----------------------|----------------------------|
| F01PM0222E | 22 mm |

Innesto rapido terminale
Terminal rapid coupling
Conexión rápida terminal



| COD. CODE CÓD. | Ø Tubo Pipe Ø Ø Tubo | F |
|----------------------|----------------------------|------------|
| F01PM012216E | 22 mm | G 3/4" BSP |

Terminale con codolo
Terminal with tang
Terminal con espiga



| COD. CODE CÓD. | Ø Tubo Pipe Ø Ø Tubo | F |
|----------------------|----------------------------|------------|
| F01PM052214E | 22 mm | G 1/2" BSP |
| F01PM052216E | 22 mm | G 3/4" BSP |

Tappo
Cap
Tapon



| COD. CODE CÓD. | Ø Tubo Pipe Ø Ø Tubo |
|----------------------|----------------------------|
| F01PM0822E | 22 mm |